

5

Test motor fit and positions. Most 540 and 550 motors should fit. You may rotate your motor mount endbell if your motor allows it (Tekin motors do) but it shouldn't be necessary. Begin planning your wiring as well. Fully mounting your motor isn't necessary at this point. **NOTE:** Remember, the Ogre 1.5 makes it easy to flip your motor position by flipping the chassis plates or swapping them to either side. The motor can be mounted on front right, rear right, front left or rear left. When the motor is mounted on the LEFT side of the truck you must also rotate your center differential so the ring gear is toward the rear of the truck.

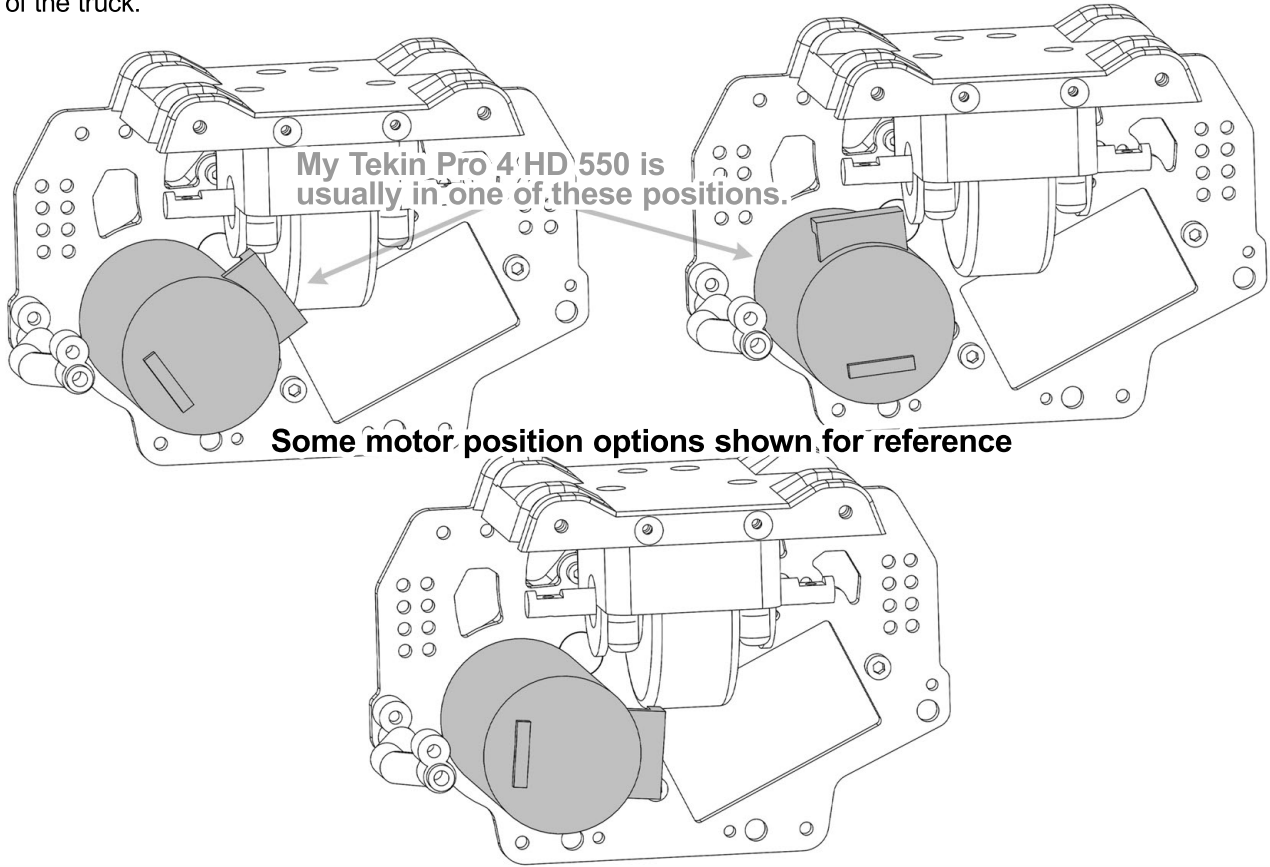

6

1. Press skid plate/diff housing into place.
2. Attach the new OGRE 1.5 upper tower brace to the chassis.

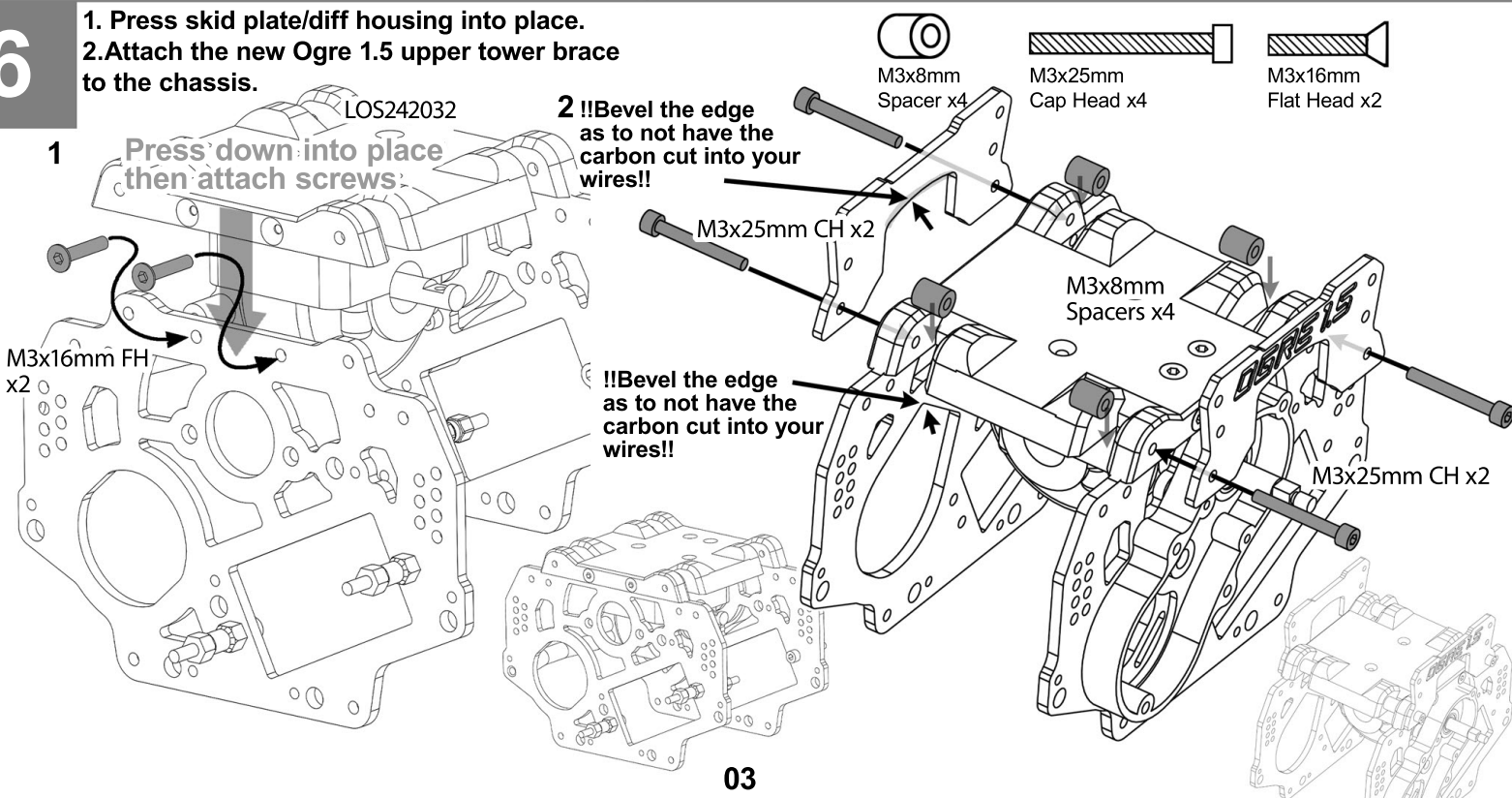

7

1. Build Ogre 1.5 rear shock tower assembly.
2. Build Ogre 1.5 front shock tower assembly.

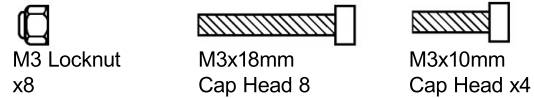

Losi Cross Brace options

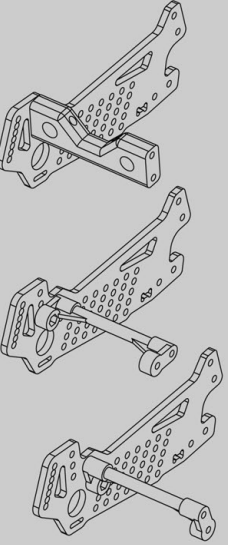

1. Rear tower assembly

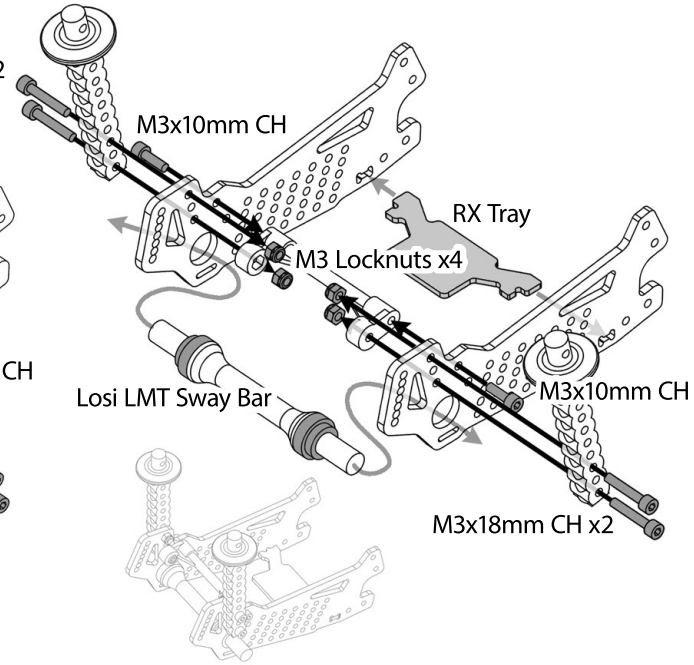
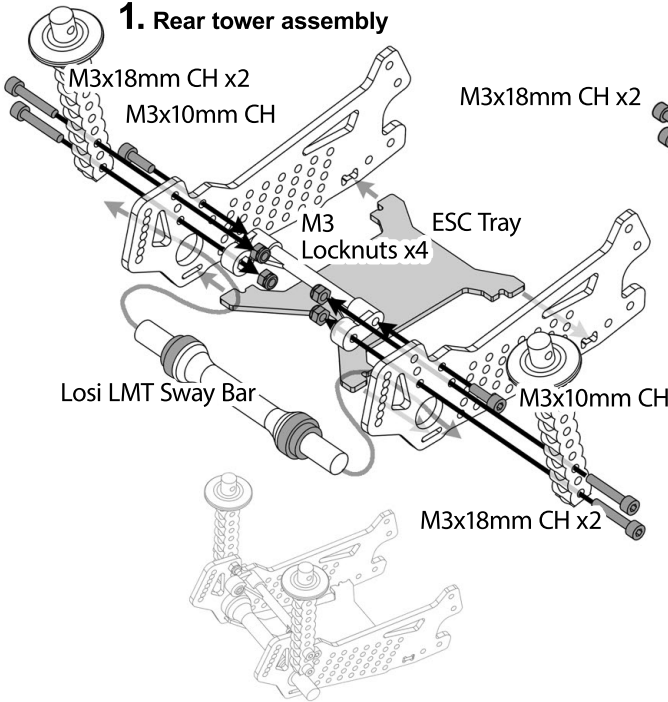

8

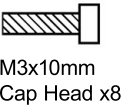
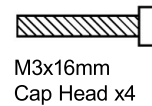
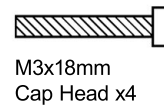
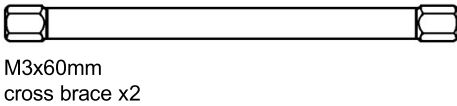

1. Attach front and rear shock tower assemblies (x2 both sides)

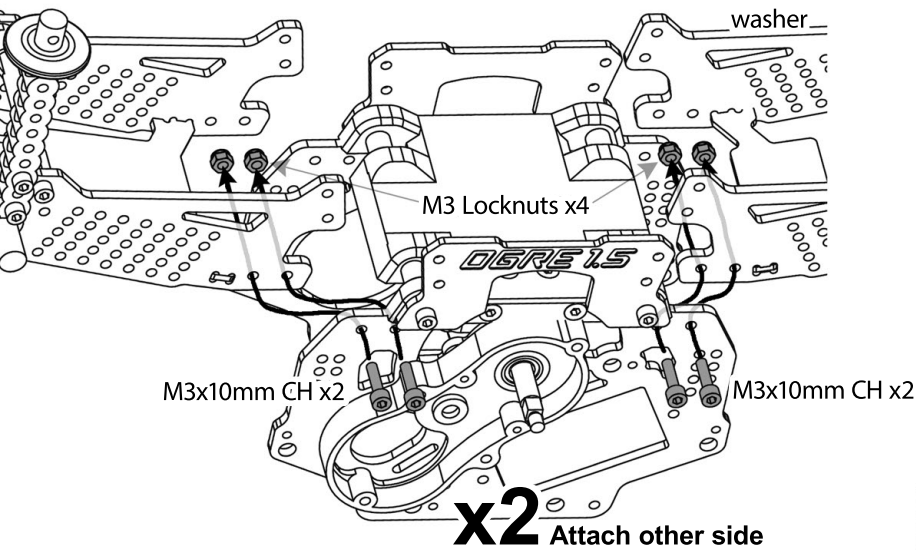

2. Affix upper bracing (x2 both sides)

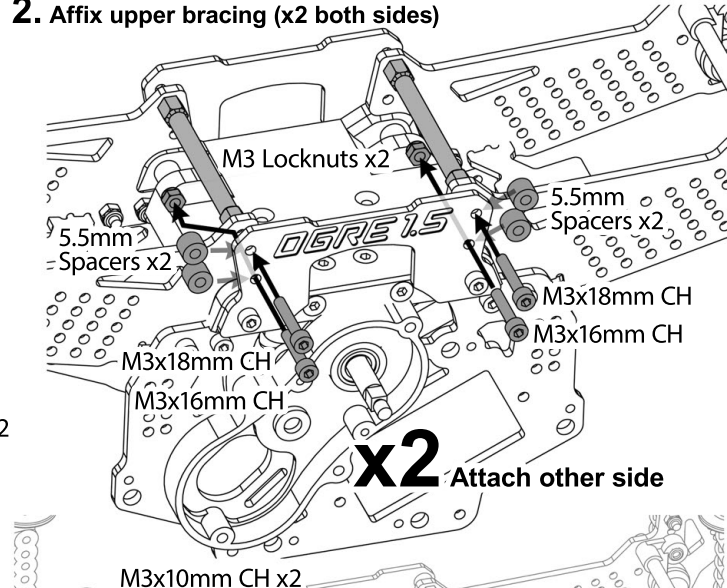



OGRE 1.5 Conversion

opt

OPTION: Body Post Extension Mounts.
 These extensions mount to the limit strap holes on the *inside* of the shock towers and can be rased or lowered as needed.



M3 Locknut
x4

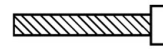

M3x18mm
Cap Head x2

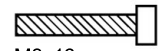

M3x16mm
Cap Head x2

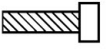

M3x10mm
Cap Head x2

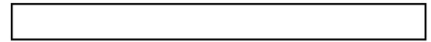

M3x55mm Cross Brace

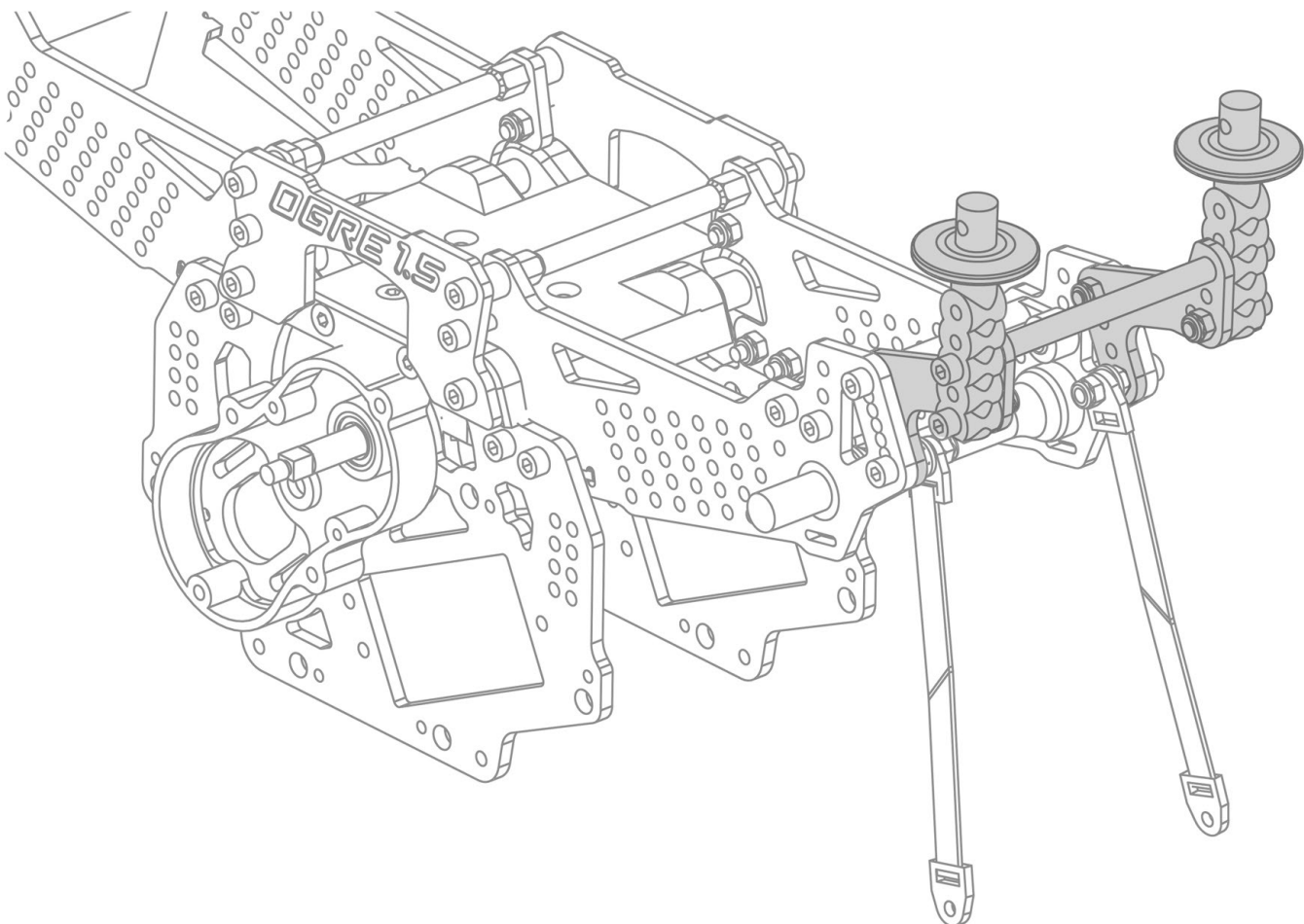
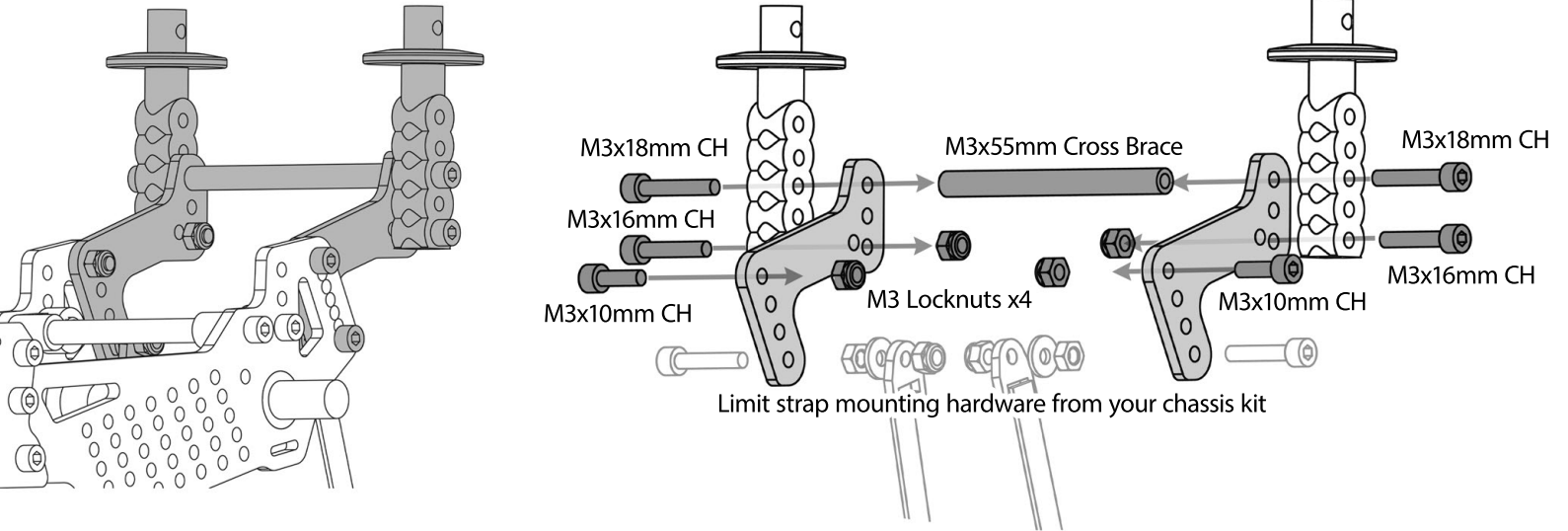

Body Post Extension Mounts