

Prenevision Render Performance  
presents,

# TWITCH

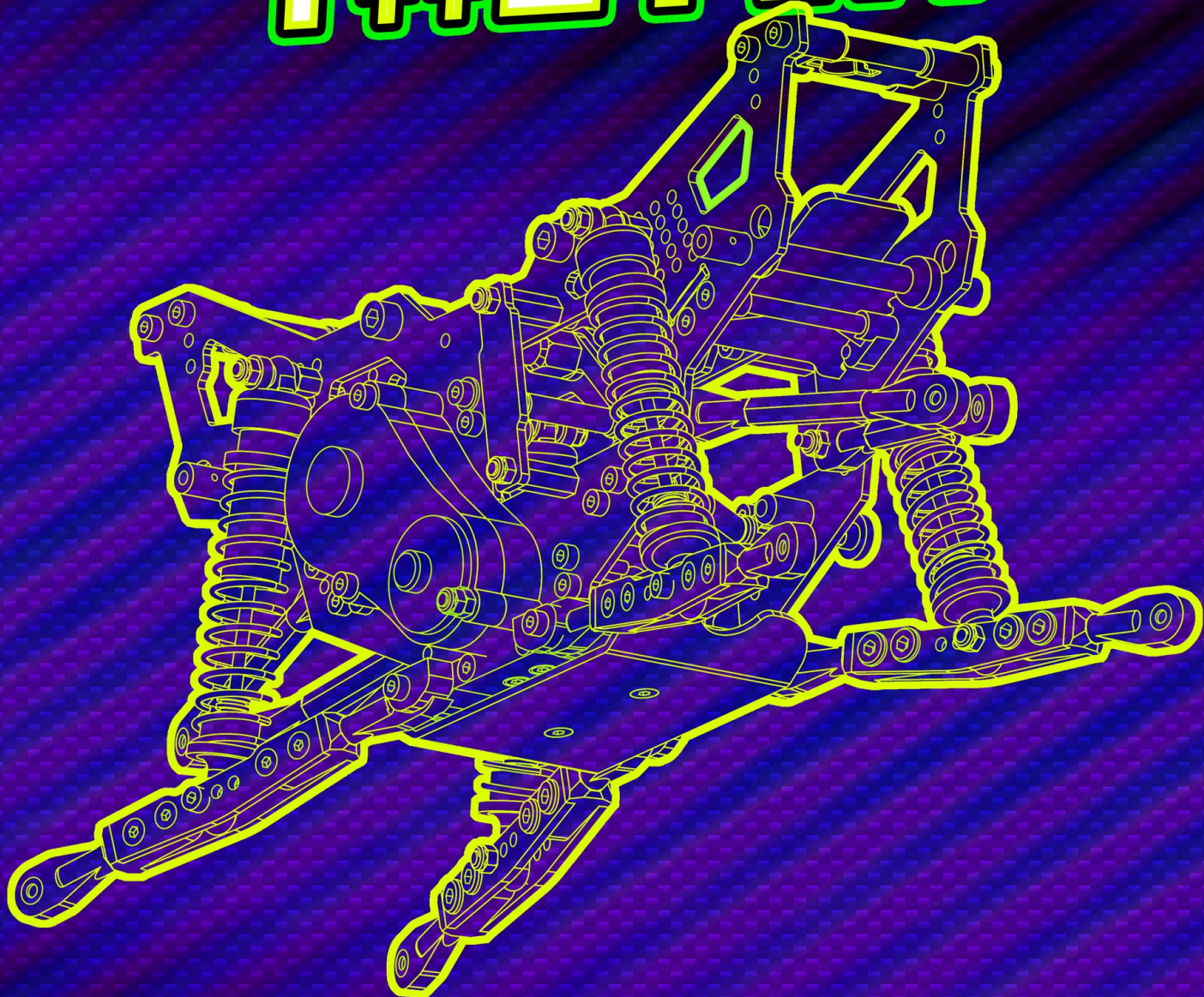

Losi 1/18 Mini LMT  
Pro Mod Conversion

MANUAL B1

PRESS START!

© Team PRP 2025

# 1

### !! Required Modifications !!

- Trim the edge of the differential housing above the inner right hole as seen in the photo below. This allows the gear box to rotate to the lay down low cg angle.
- Some 380 motors may require a bevel at the top rear edge of the differential housing when using the stock 14t pinion. 15+ tooth pinions should not require a bevel to the diff housing.

- Trim the small angled edge away on the differential housing/skid plate.

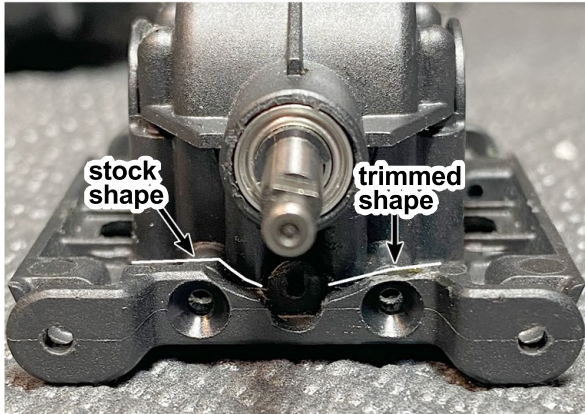

- File a bevel to allow the motor to sit lower when using the stock 14t pinion. Some motors may not require this modification. 15t + pinions should not need this modification.

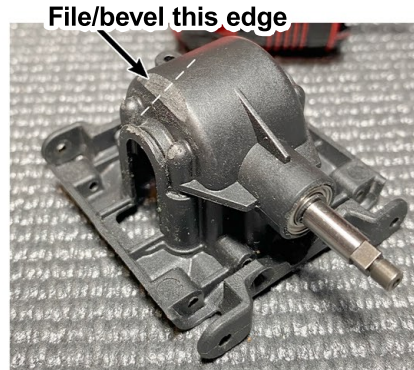

# 2

### Recommended Modifications:

- File the bottom edge of the sway bar end mounts with a round file to reduce binding at full bump.
- Install TREAL Mini LMT Center Driveshafts for optimal suspension tuning without binding.
- If you cannot install Treal center driveshafts you may use the included M6x0.5 shims to lengthen your drive shafts slightly to help accommodate the longer Twitch wheelbase but suspension tuning will be limited to lesser driveshaft angles.

- Create a bevel by filing the bottom inner edge of the sawy bar mounts. **!!Make sure orientation is correct for each bar end so the BOTTOM edge is the edge you are beveling!!** This modification will allow full deep compression without the rod end binding up badly.

Round file

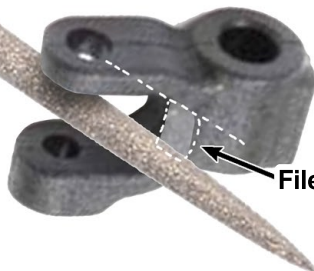

File/bevel this edge

- Recommended: Treal center driveshafts part #TLHTLMT18-36



- If you are **NOT** running Treal center driveshafts you may shim the **stock Mini LMT** center driveshafts with the included M6x0.5 shims.

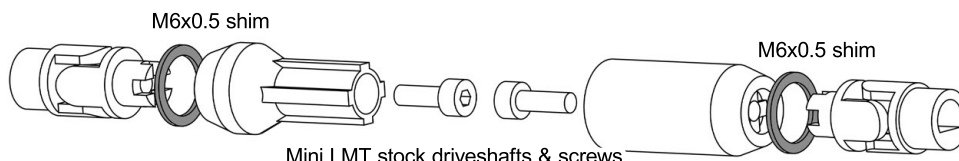

x2

### 3

Now that that nonsense is over it's time to do the proper build! Begin with the motor-side chassis plate assembly.



M2 Locknut  
x4



M2x10mm  
Battery Post  
Plastic x2

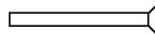

M2x20mm  
Flat Head



M2x8mm  
Flat Head

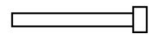

M2x16mm  
Cap Head x2



M2x6mm  
Cap Head x4

1. Attach gearbox and battery strap.  
**OPTIONAL:** The 20mm flat head screw may be super-glued into place. However, with the gear cover fastening design (seen in a later step) I have not needed to glue the screw during my testing.

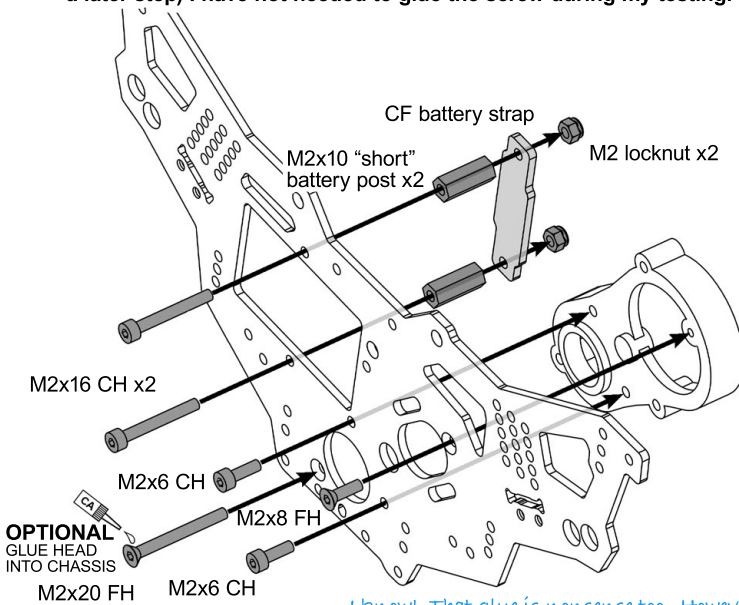

2. Mount the "screw stay" to help keep the flat head screw in place.

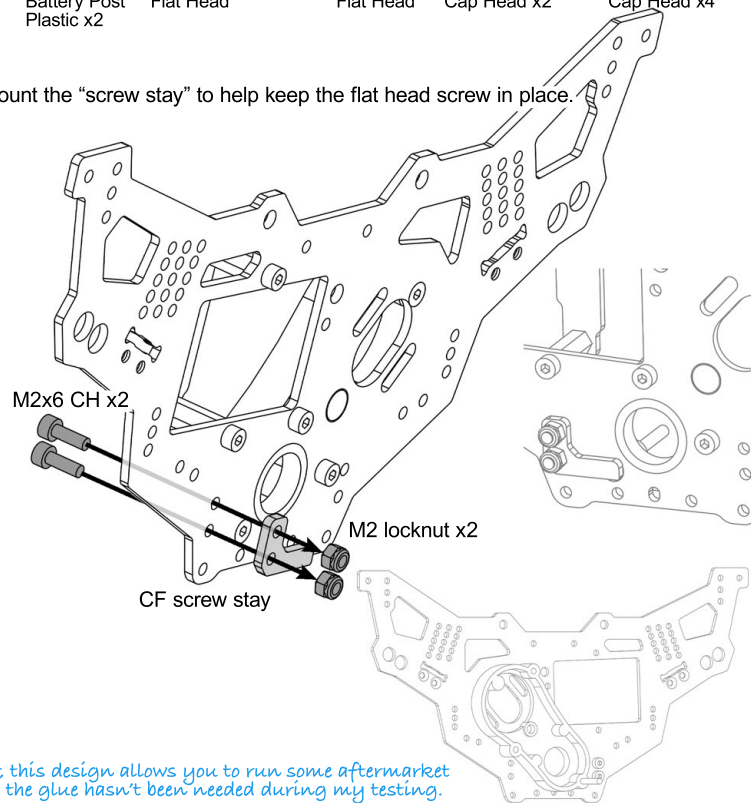

*I know! That glue is nonsense too. However, this design allows you to run some aftermarket aluminum parts without interference. And the glue hasn't been needed during my testing.*

### 4

Continue with motor-side chassis plate assembly.



M2 Washer  
x2



M2x4mm  
standoff  
x2



M2x8mm  
Flat Head x2



M2x16mm  
Cap Head x2

1. Slide diff cover through chassis and gear box. Then press chassis into differential housing / skid plate.

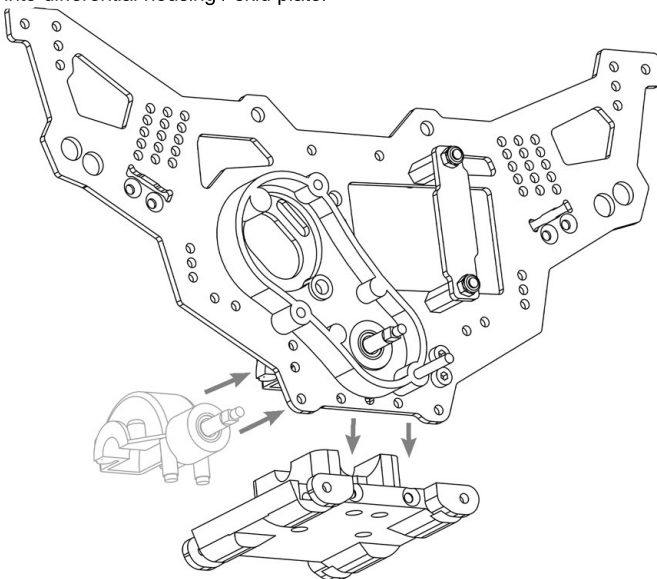

2. Do not fully tighten the bottom M2x8mm flat head screws.

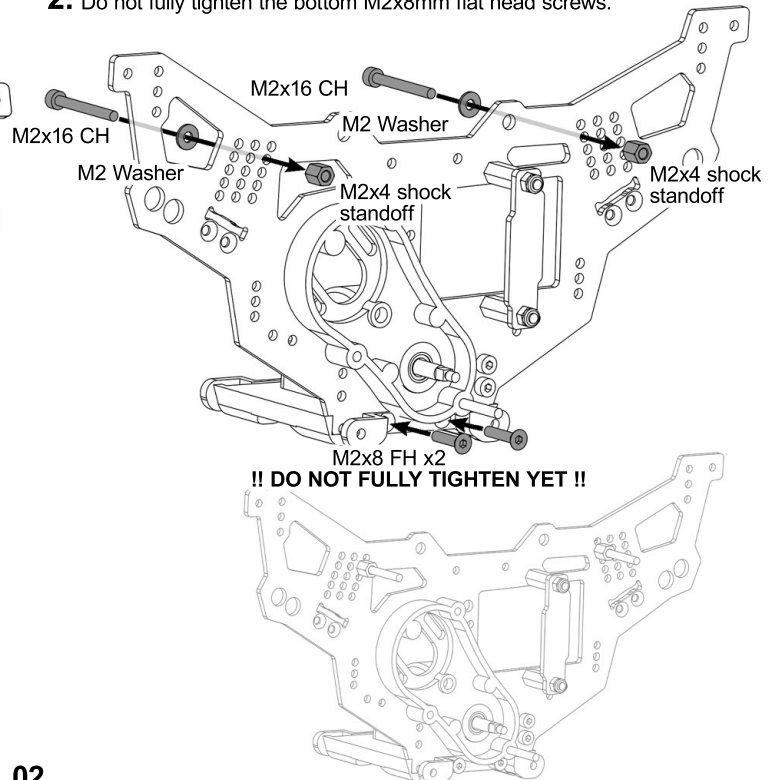

### 5

#### Non motor side chassis plate assembly.

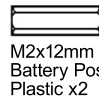

1. Attach shock mount hardware and battery posts.

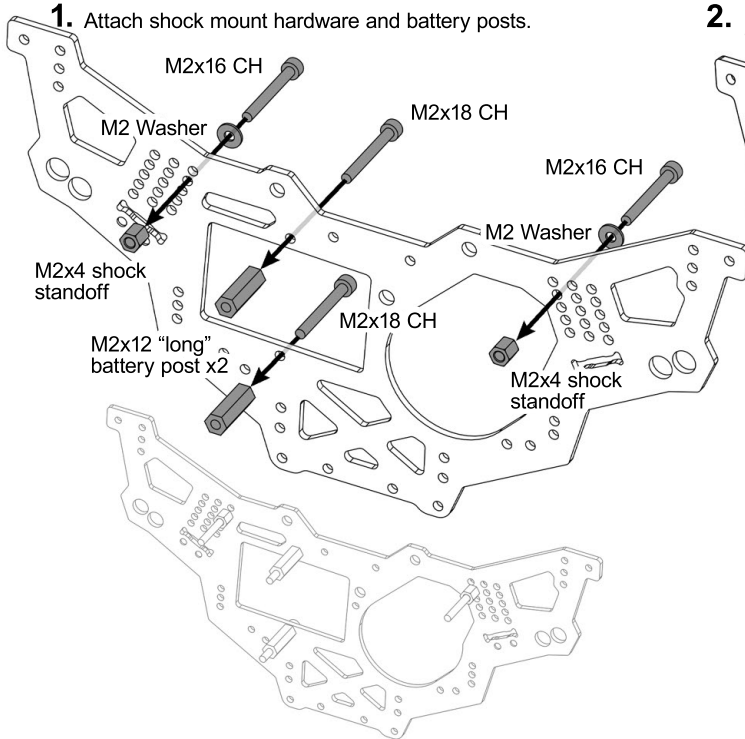

2. Press the chassis into the differential housing while keeping the bottom M2x8 flat head screws loose to allow the plates to flex apart.

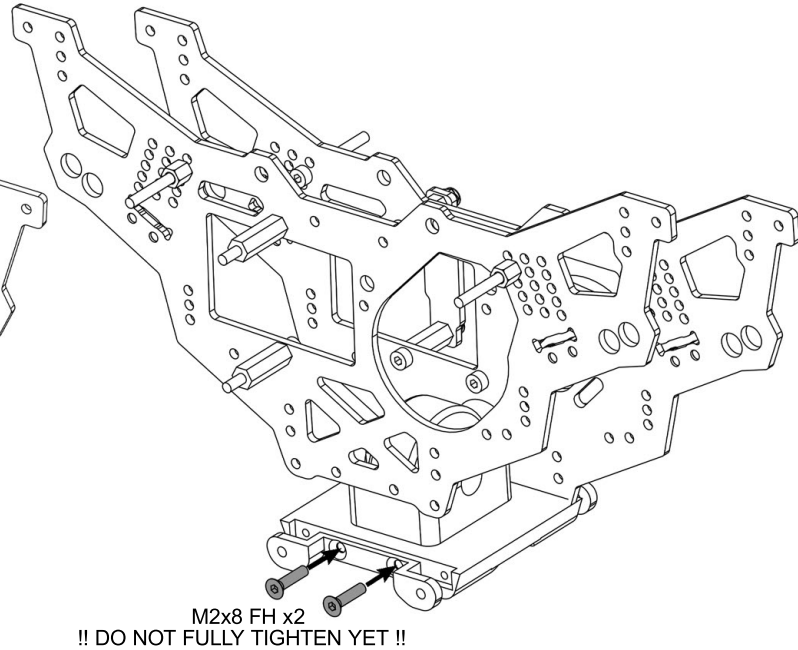

### 6

#### Sway bar installation.

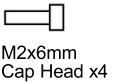

1. **Remove** all 4 set screws. Then carefully flex apart the chassis plates and push sway bars through the chassis.

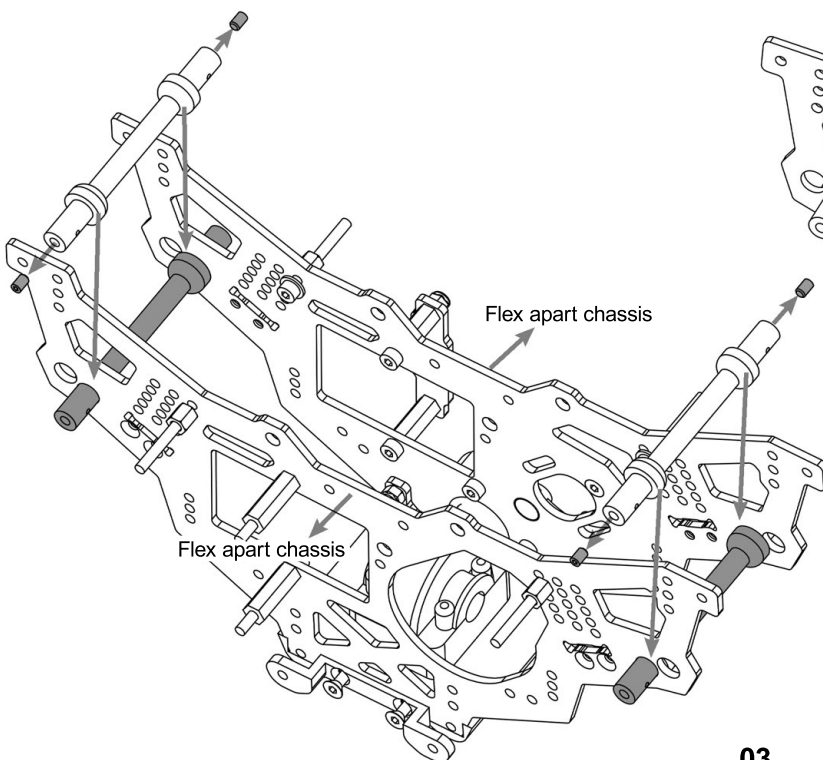

2. Do NOT fully tighten the cross brace screws yet!!

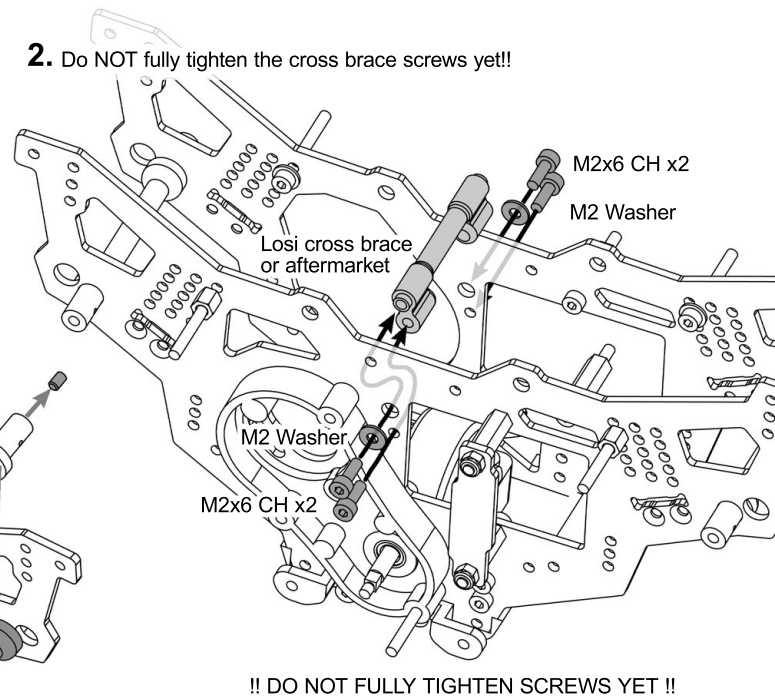

### 7

Mount electronics trays and cross braces.



1. Flex apart chassis plates enough to press trays into slots. Make sure trays are fully seated and then tighten all loose screws.

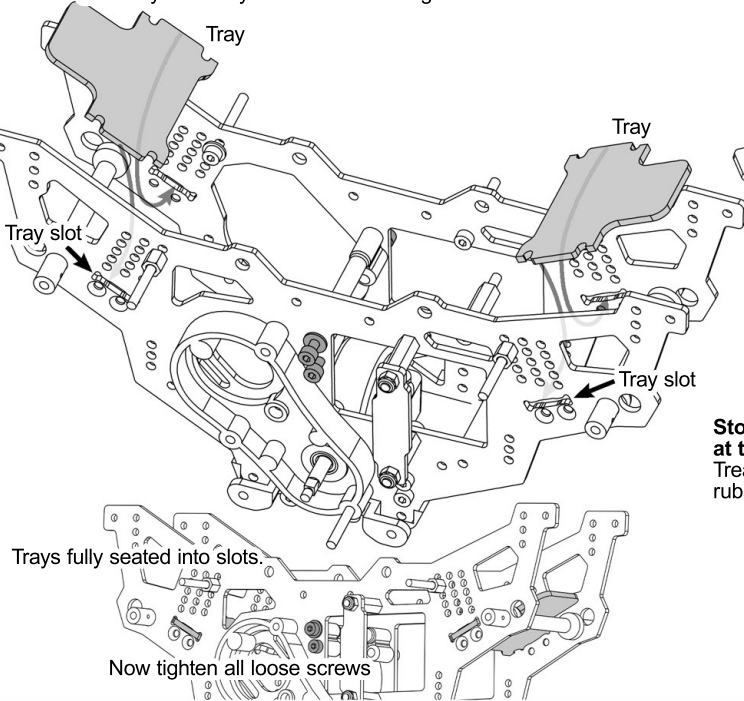

2. Attach Losi cross braces and fasten on both sides of the chassis.

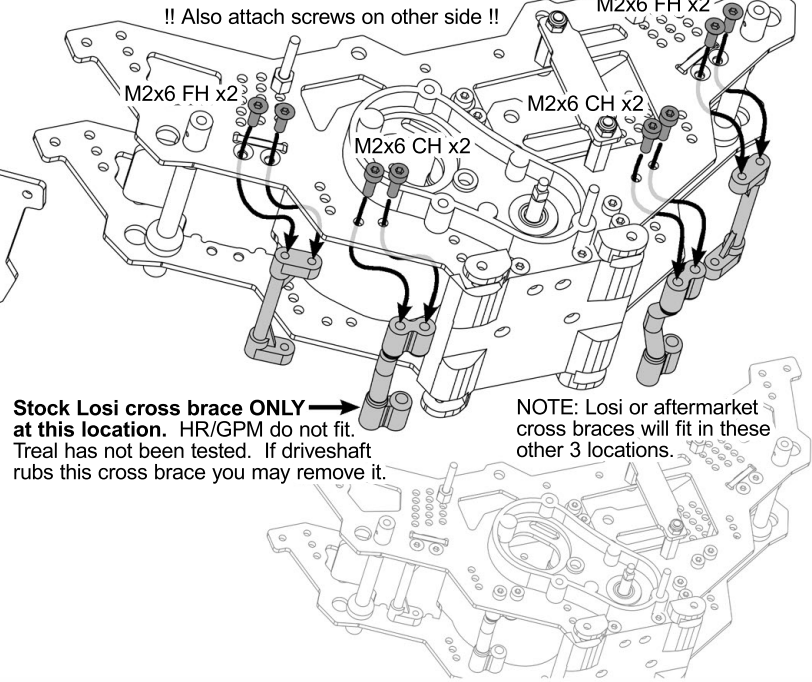

### 8

M3 Upper brace installation and upper 4-link assembly.



1. Mount upper brace in either A or B orientation.

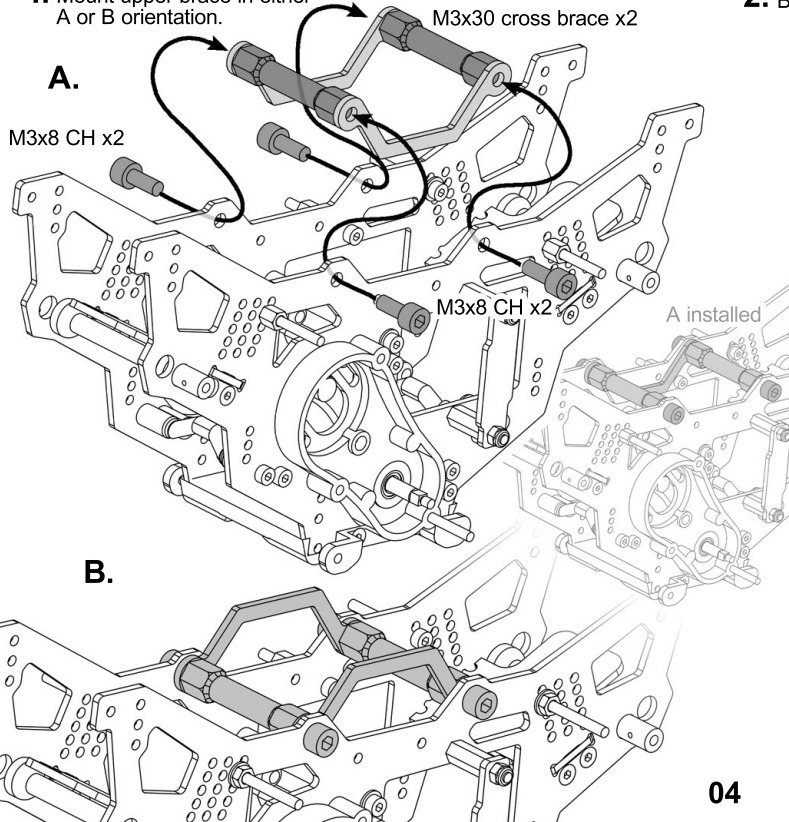

2. Build 4 upper 4-links.

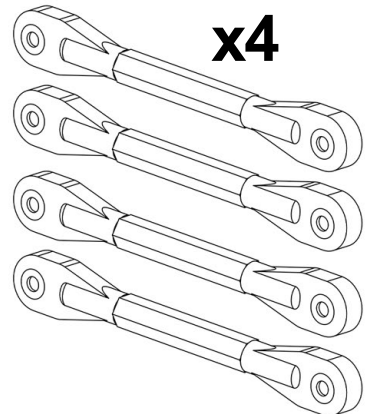
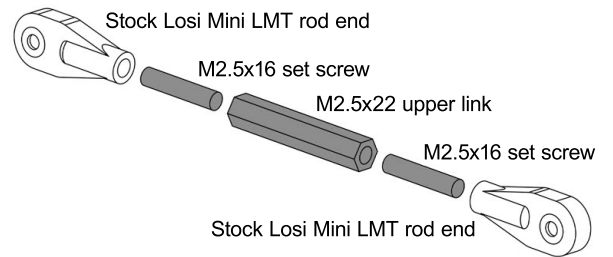

9

### Upper and lower 4-links.

-  M2 Locknut x4
-  M2.5x14mm Set Screw x8
-  M2x5mm SS Binder Nut x16
-  M2x4mm Flat Head x16
-  M2x12mm Cap Head x4
-  M2x10mm Cap Head x4

#### 1. Attach upper 4-links x4.

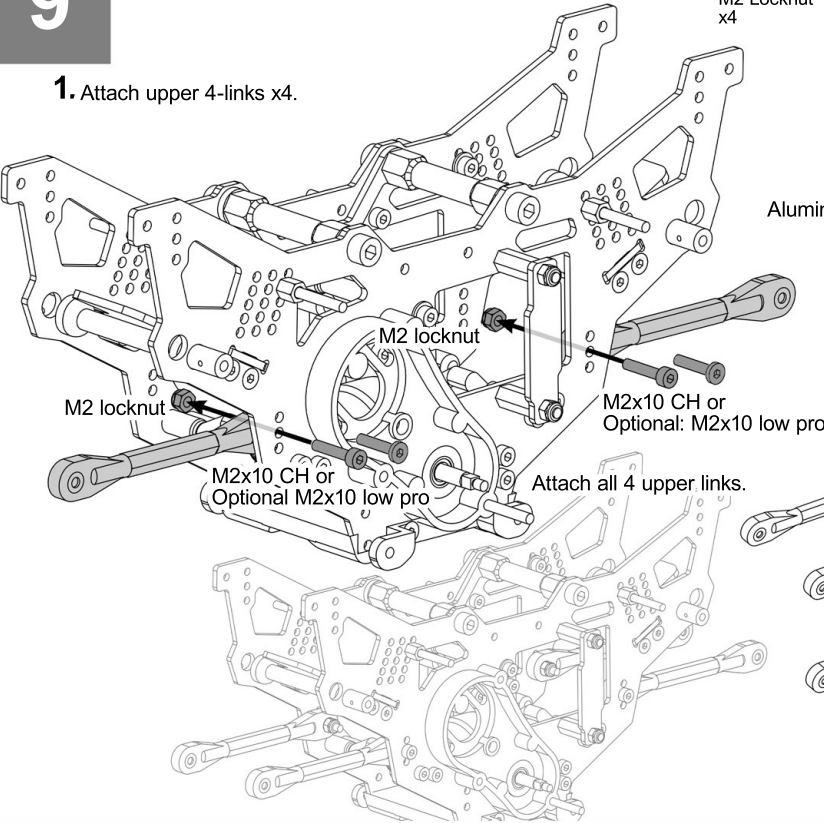

#### 2. Assemble lower 4-link trailing arms x4.

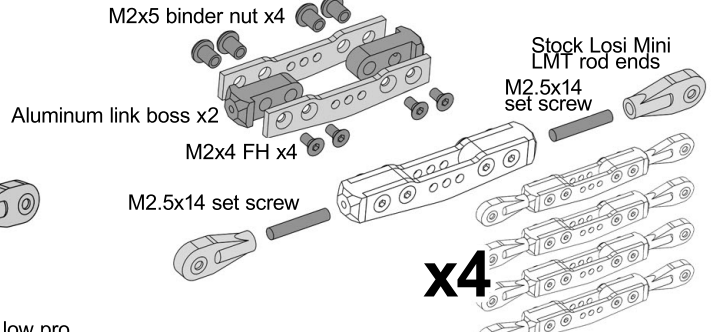

#### 3. Attach all 4 lower trailing arms. Side with flat head screws toward "outside" of chassis.

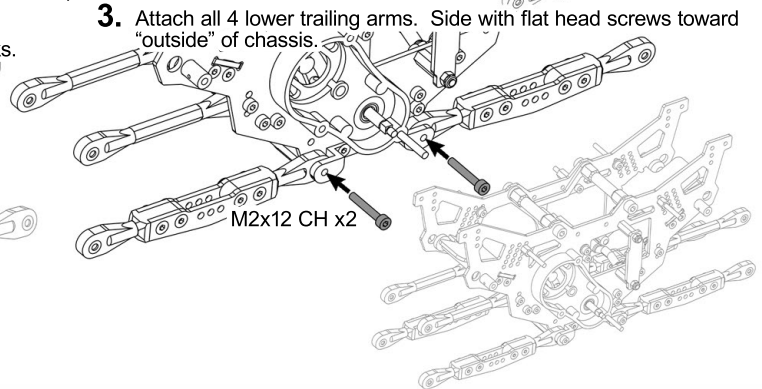

10

At this stage you can decide if you want to run the motor up front or at the rear (**standard configuration**). If you choose to place the motor up front you need to install the center differential pointing toward the rear and your front axle on the motor end.

-  M2x4 threaded spacer x4
-  M2 Locknut x4
-  M2x16mm Cap Head x4

#### 1. Attach axles to links. Attach screws on both sides

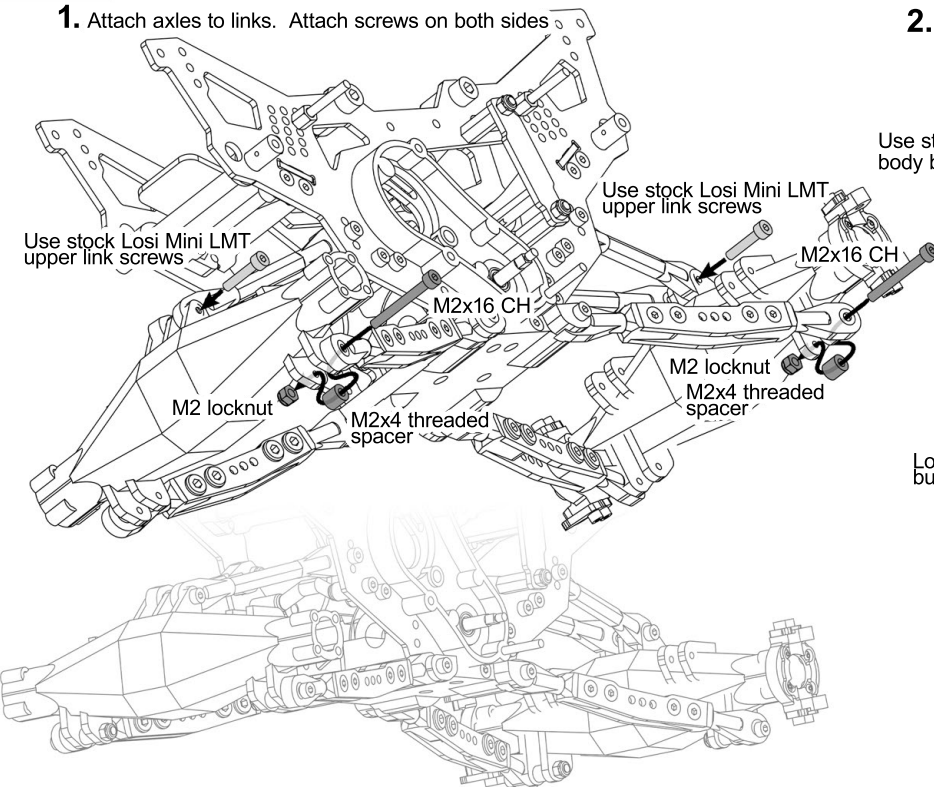

#### 2. Add additional bump stops to Mini LMT shocks. Use stock Losi body buttons or shock o-rings as extra bump stop risers.

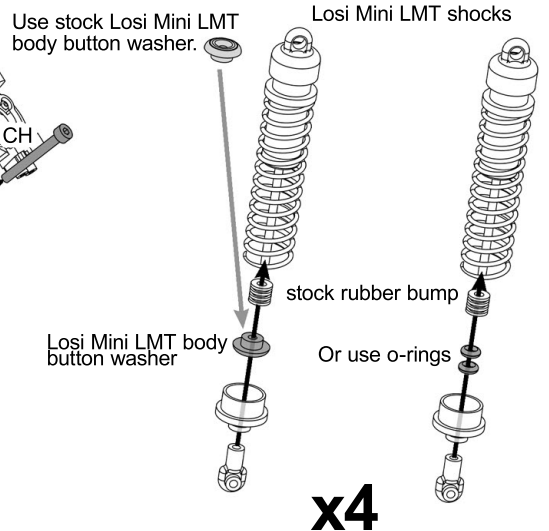

### 11

Attach Losi Mini LMT shocks. Determine your own shock mounting locations for other Mini-B/T length shocks. Mount body posts of your choice.

1. Attach all 4 shocks.

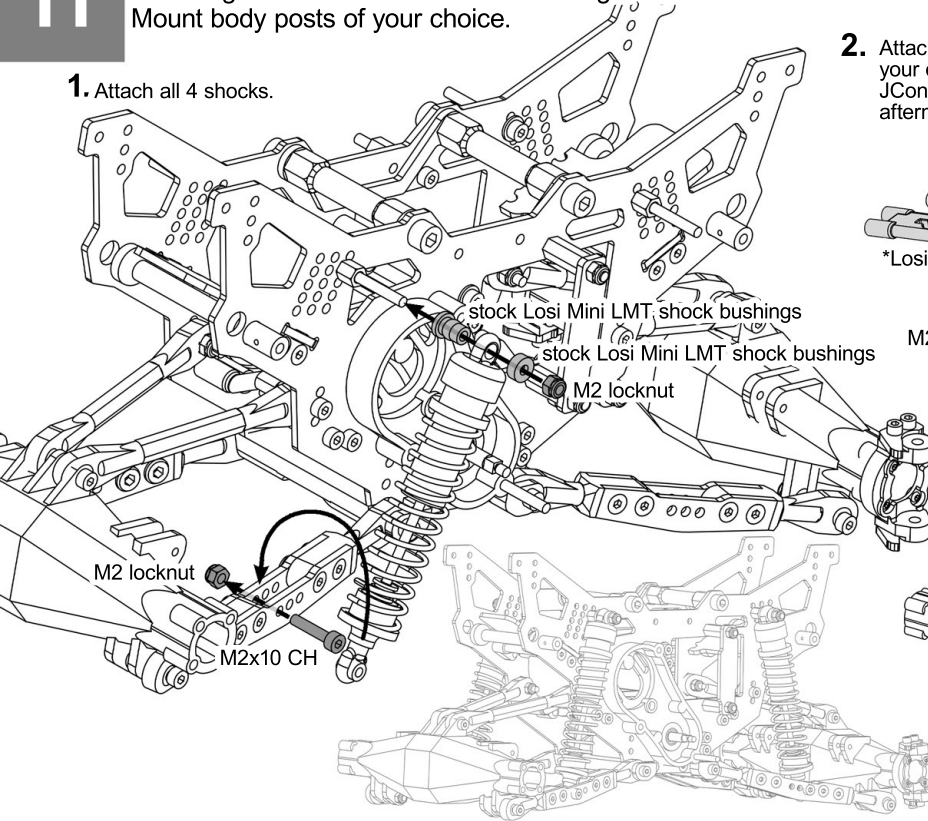

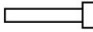
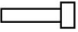
-  M2 Locknut x8
-  M2x10mm Cap Head x4
-  M2x8mm Cap Head x8

2. Attach JConcepts Mini LMT body posts (sold separately). Or your choice of aftermarket body posts. If you are NOT using JConcepts you will most likely need to install the stock or aftermarket Losi Mini LMT cross braces\* in this location.

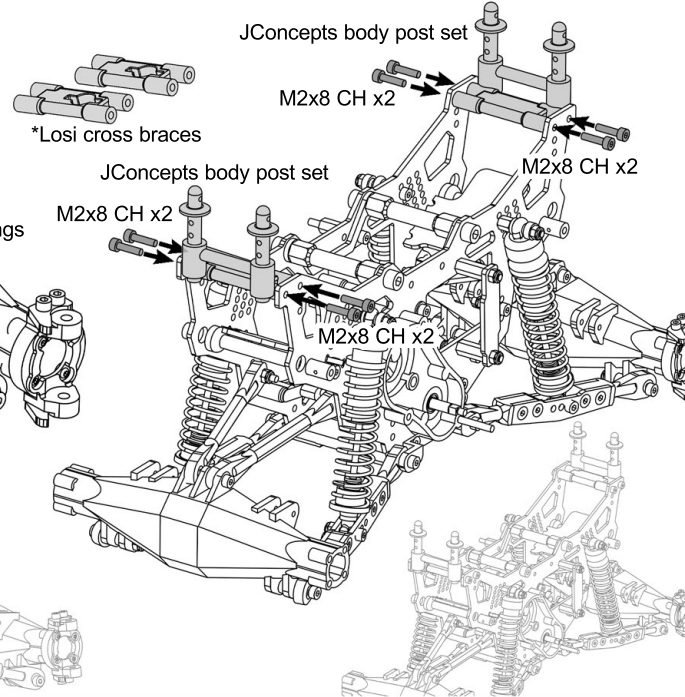



### 12

Attach motor. Place stock idler and cush gear (not shown) into gearbox. Due to the non-split gear cover design from Losi the gear mesh can be tricky and may take a few tries for the best feel. Install center diff gear into bottom diff housing.

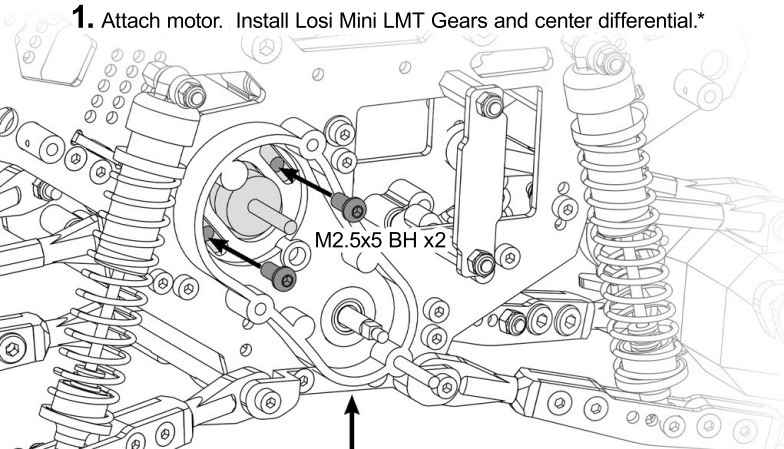
1. Attach motor. Install Losi Mini LMT Gears and center differential.\*

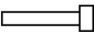

-  M2 hex nut
-  M2 Locknut
-  M2.5x5mm Button Head x2
-  M2x10mm Cap Head x2

2. Attach gear cover. Carefully spin hex nut on the output screw and fully tighten it against the gear box. Then use locknut as a jam nut to keep the assembly secure. This fastening method has not required the M2 flat head screw to be glued in place.

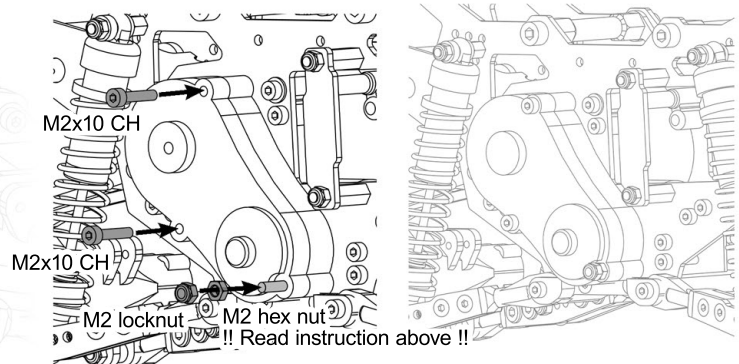

3. Install center driveshafts. Refer to Losi Mini LMT manual if you need assistance. **NOTICE!!** See Twitch manual page 1 step 2-2 for drive shaft recommendations.

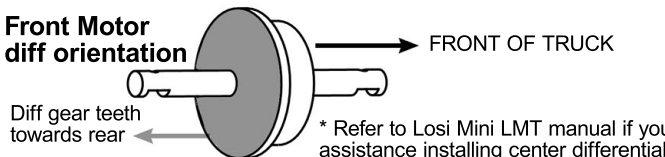
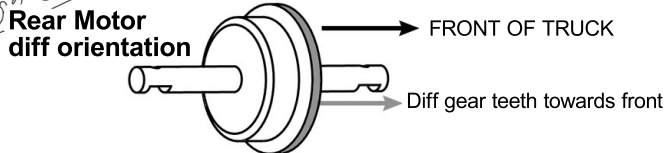
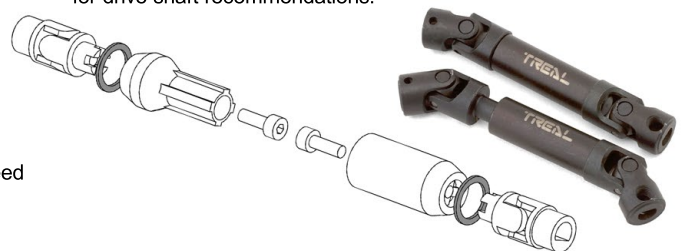

\* Refer to Losi Mini LMT manual if you need assistance installing center differential.

# 13

Skid plate and esc tray options.



1. Optional: If included install skid plate and spacer weight.

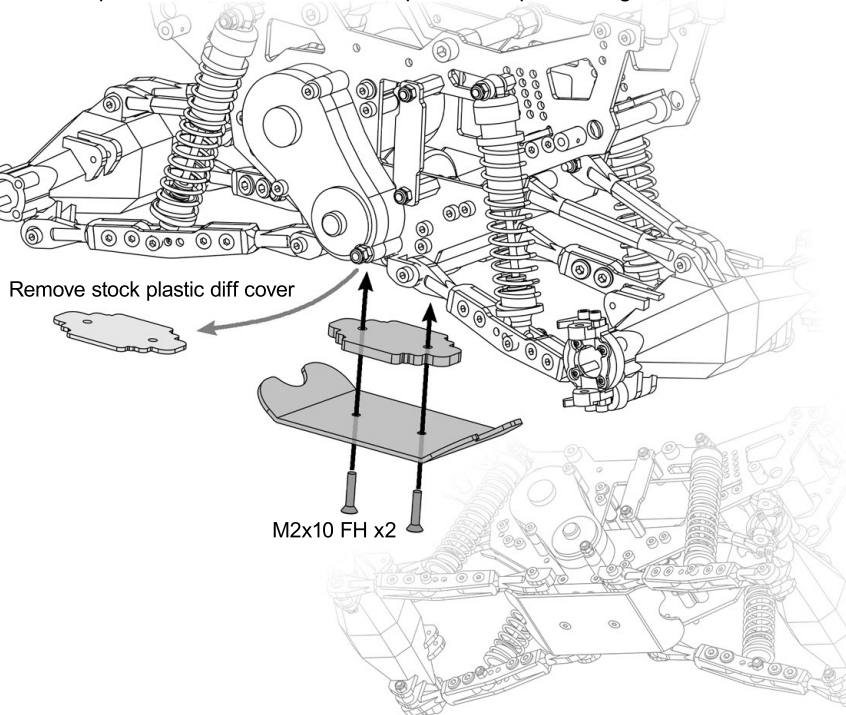

2. Optional: Stock Mini LMT esc tray may be mounted.

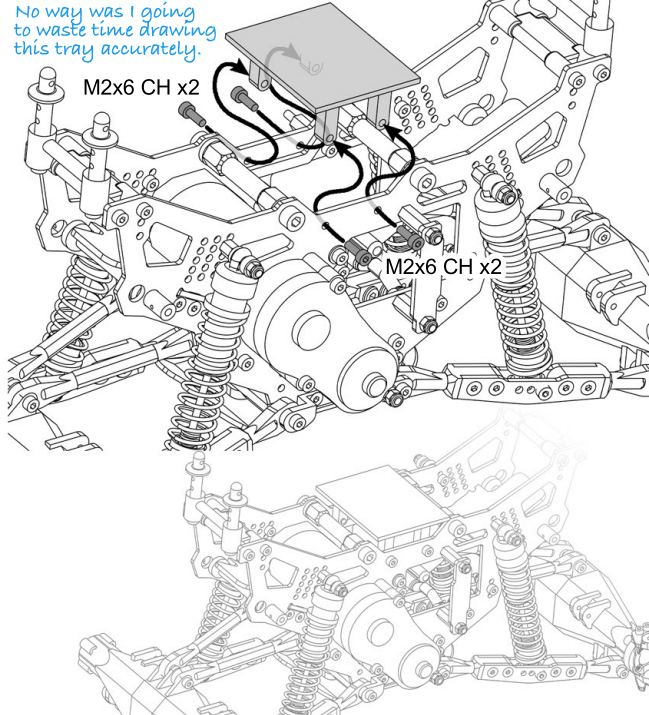

**Congratulations** on your new mini pro mod **Twitch** build! Be sure to keep a look out for new releases and news on the shop and Team PRP's Facebook and Instagram pages.  
[@teamprpracing](https://www.instagram.com/teamprpracing)

Share your builds and racing on our club page on facebook!  
[fb.com/groups/teamprp](https://www.facebook.com/groups/teamprp)

# TWITCH

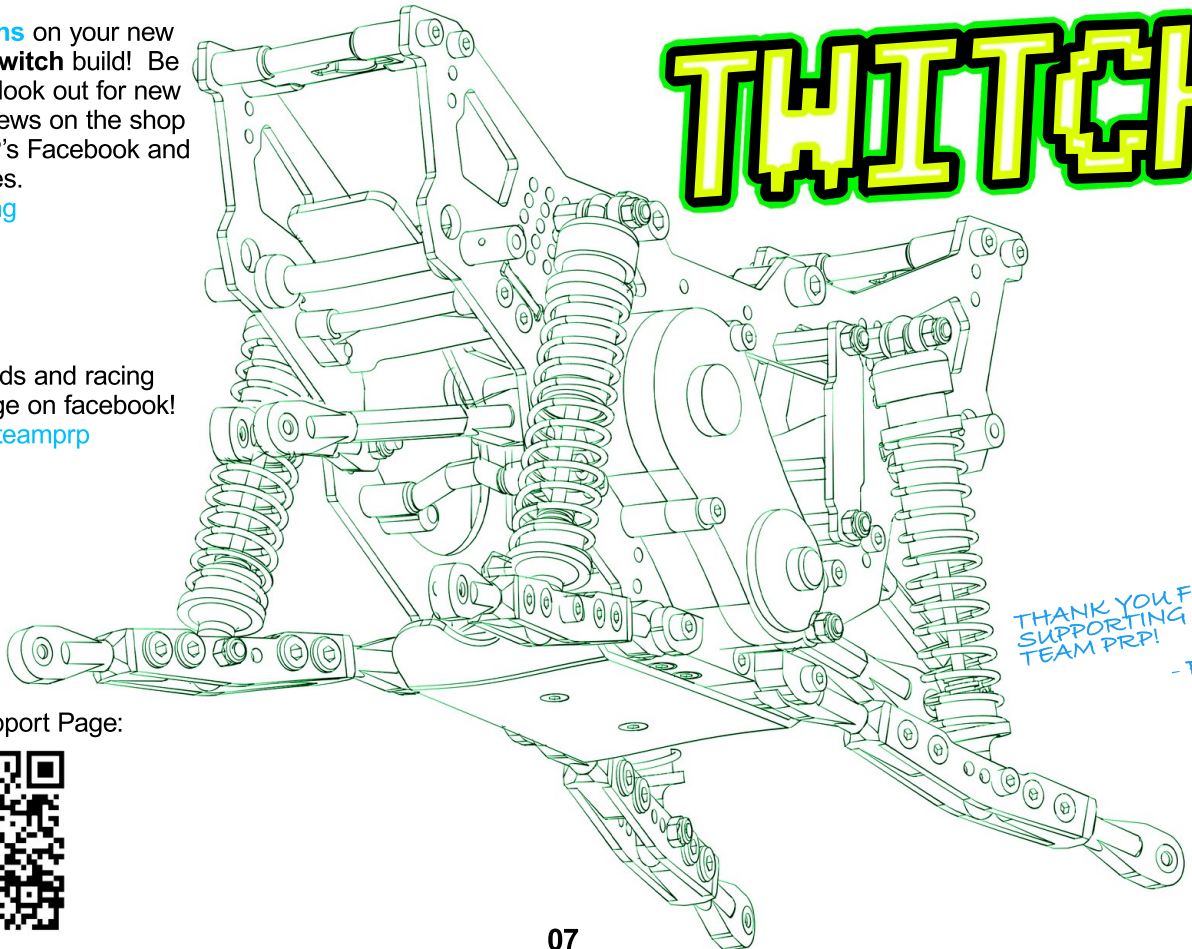

THANK YOU FOR SUPPORTING TEAM PRP!  
- Ben

Team PRP Support Page:

