

A detailed line drawing of a truck chassis conversion kit, showing various components like the front and rear axles, suspension, steering, and a roll-over protection cage. The drawing is in black and white with some blue highlights on certain parts.

TEAMPRP

FCR

**FULL CAGE RACER
SPORT OR PRO EDITION**

Chassis conversion for the Team Losi LMT RTR, Roller, TLR Tuned or Mega trucks*.

*Limited shock mounting options with Mega Trucks

01

Insert Press Nuts into Sway Bar Mounts or into the Shock To Link (STL) Mounting Plates if you will be using the STL setup (trailing arms, shock to link).

1. Thread screws into press nuts to seat the press nuts into the sway bar mounts or into the STL plates if using that setup.



2. Fully seat press nuts with screws

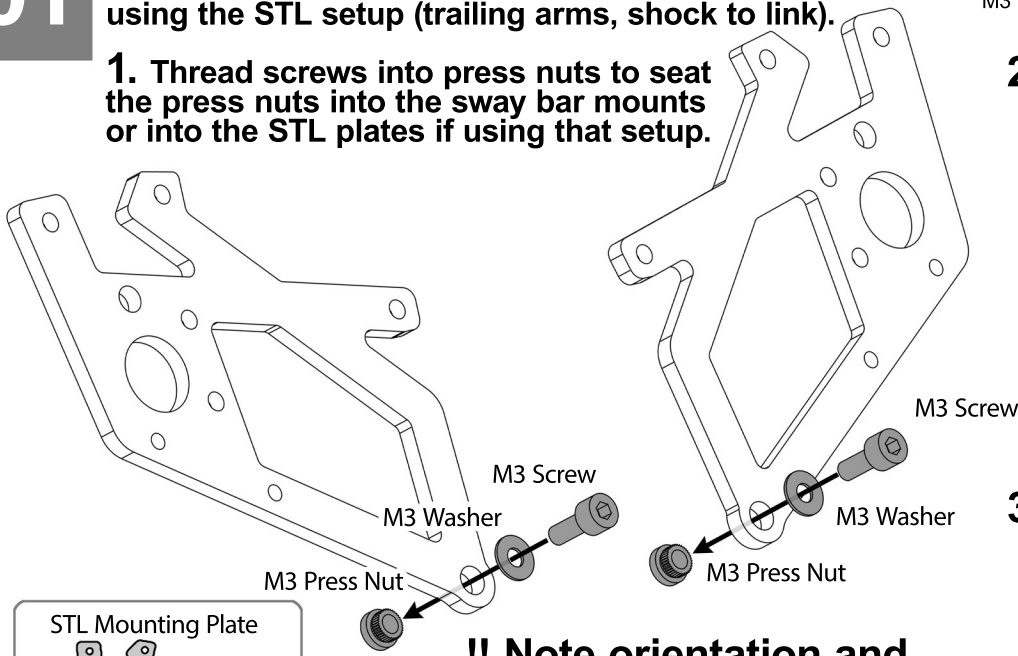

3. Remove screws

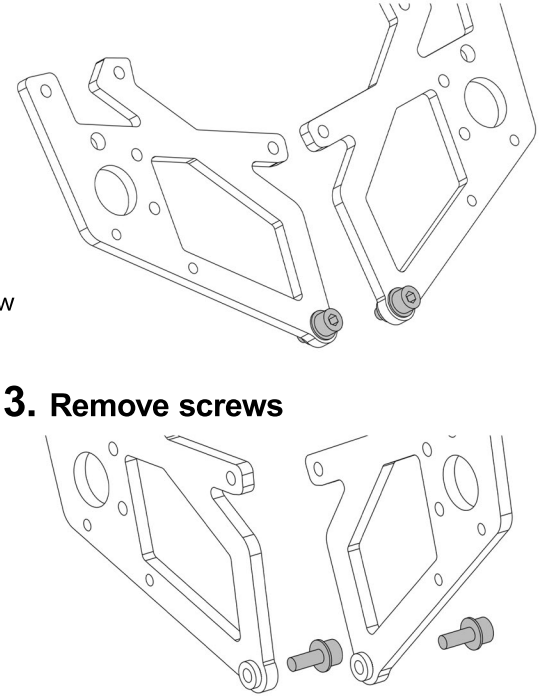

!! Note orientation and build 2 sets (4 total parts) !!

02

Install right side Cab support.

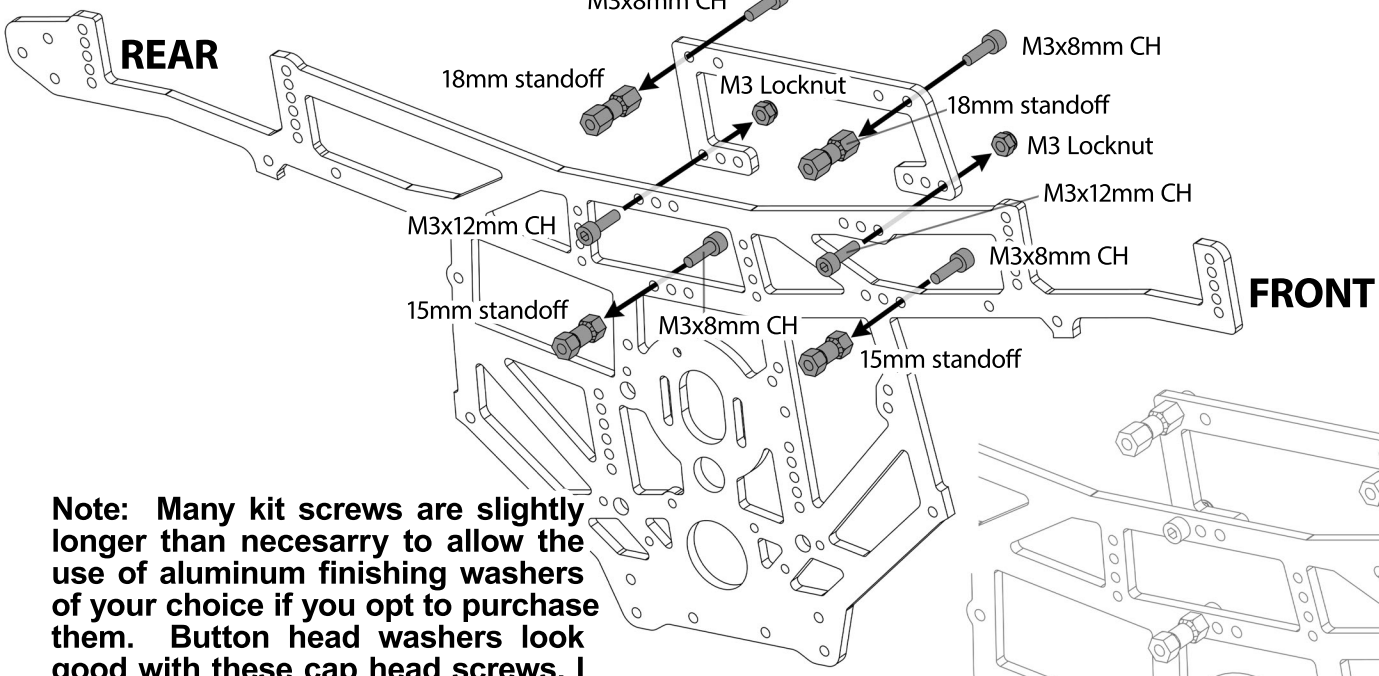
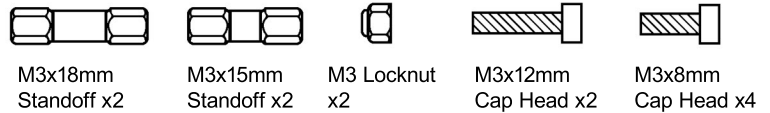

Note: Many kit screws are slightly longer than necessary to allow the use of aluminum finishing washers of your choice if you opt to purchase them. Button head washers look good with these cap head screws. I prefer them over cap head washers.

03

Install left side cab support.

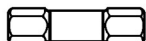

M3x18mm Standoff x2



M3x15mm Standoff x2



M3 Locknut x2



M3x12mm Cap Head x2



M3x8mm Cap Head x4

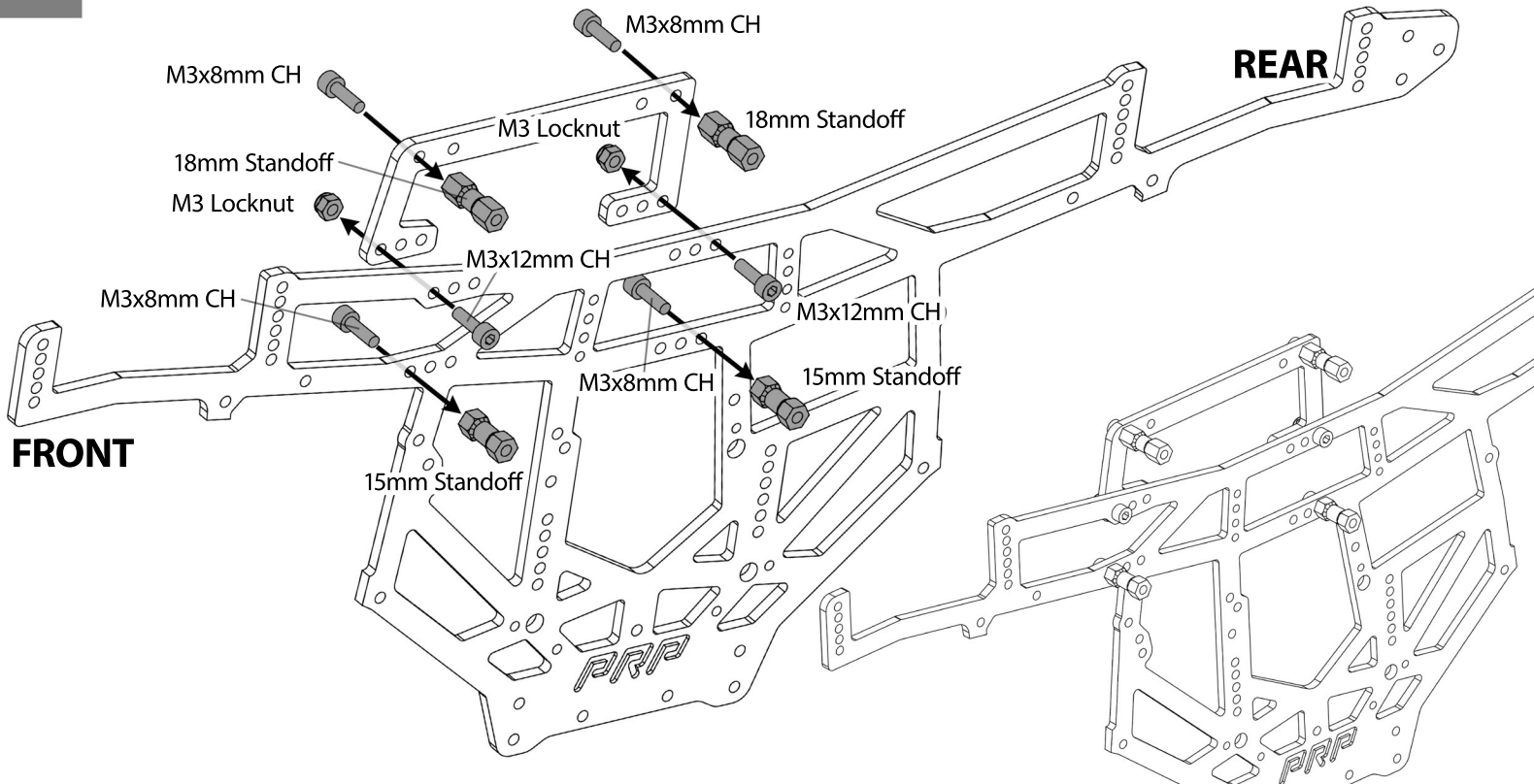

04

Attach LMT gearbox and diff cap. Refer to Losi TLR Tuned LMT manual steps D1 to D3 if you need gearbox housing help.



M3x16mm Flat Head x2



M2.5x10mm Flat Head



M2.5x10mm Cap Head x2

1.

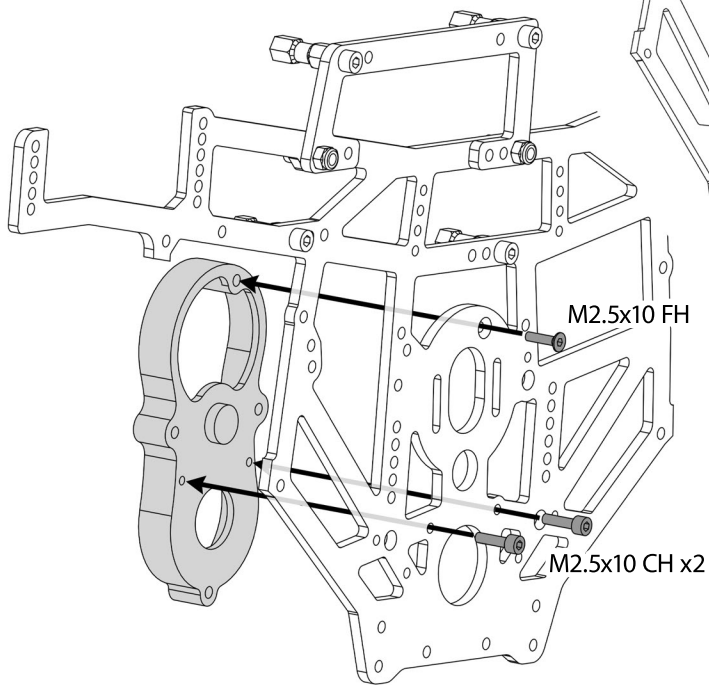

2.

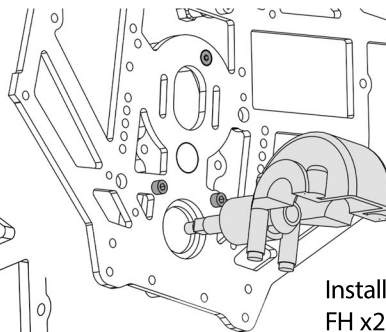

3.

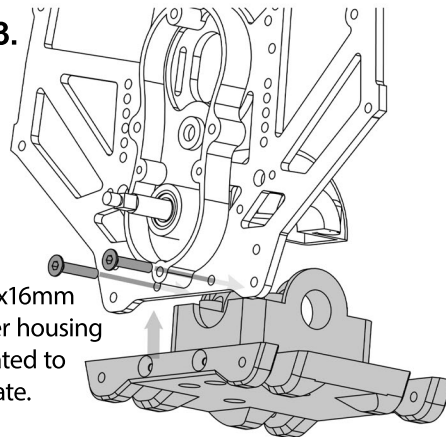

Install M3x16mm FH x2 after housing is fully seated to chassis plate.

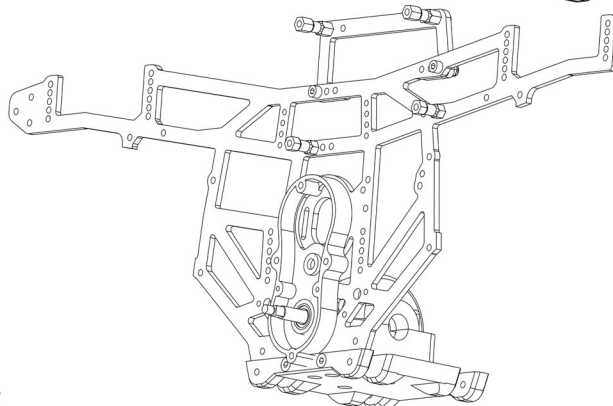



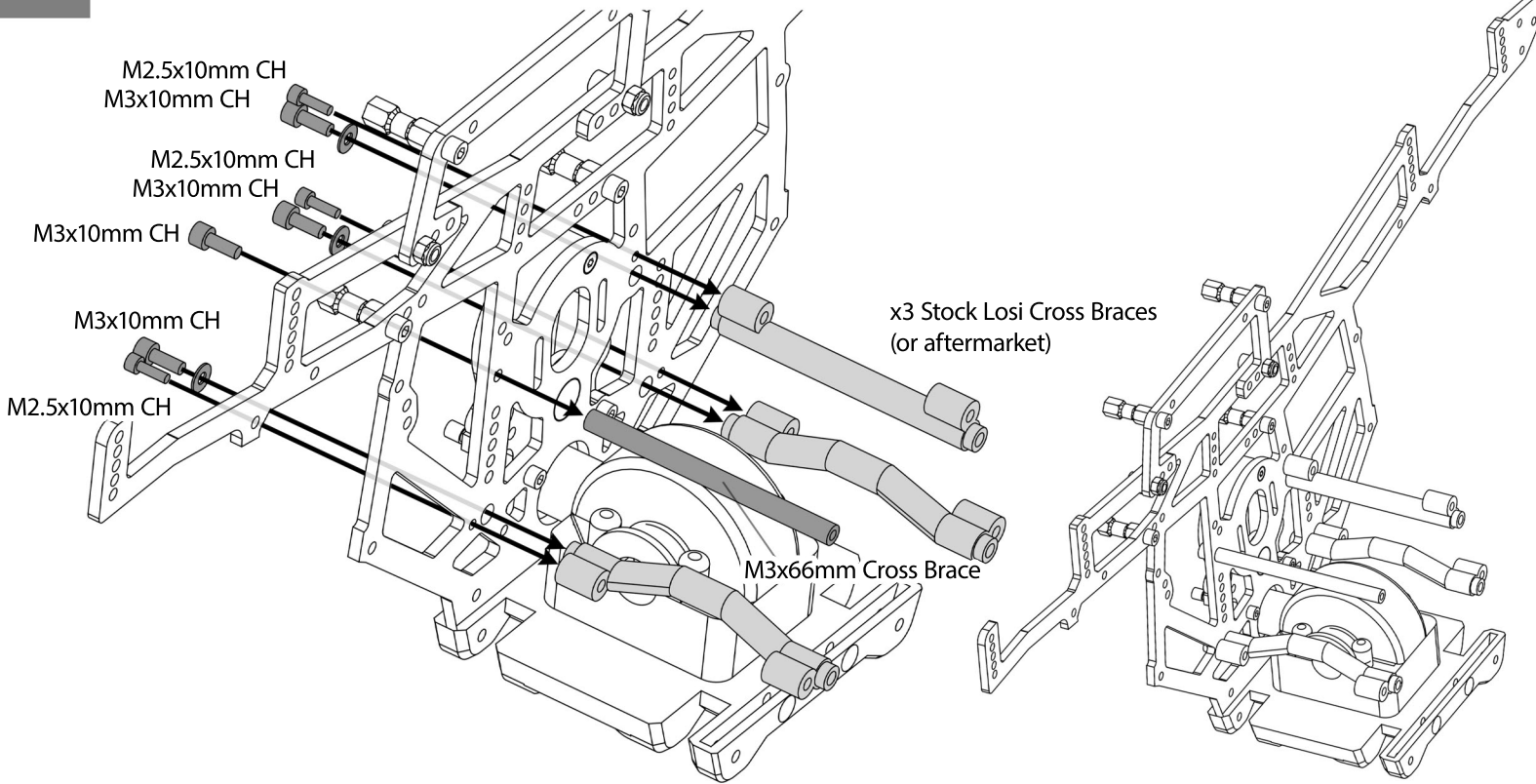

05

Install cross braces to the right chassis plate - motor mount side of chassis.



06

Install left side chassis plate by carefully flexing and pressing it into the gear box housing skid plate while aligning cross braces. Then attach screws.

- 
 M3 Washer
x3
- 
 M3x16mm
Flat Head x2
- 
 M3x10mm
Cap Head x4
- 
 M2.5x10mm
Cap Head x3

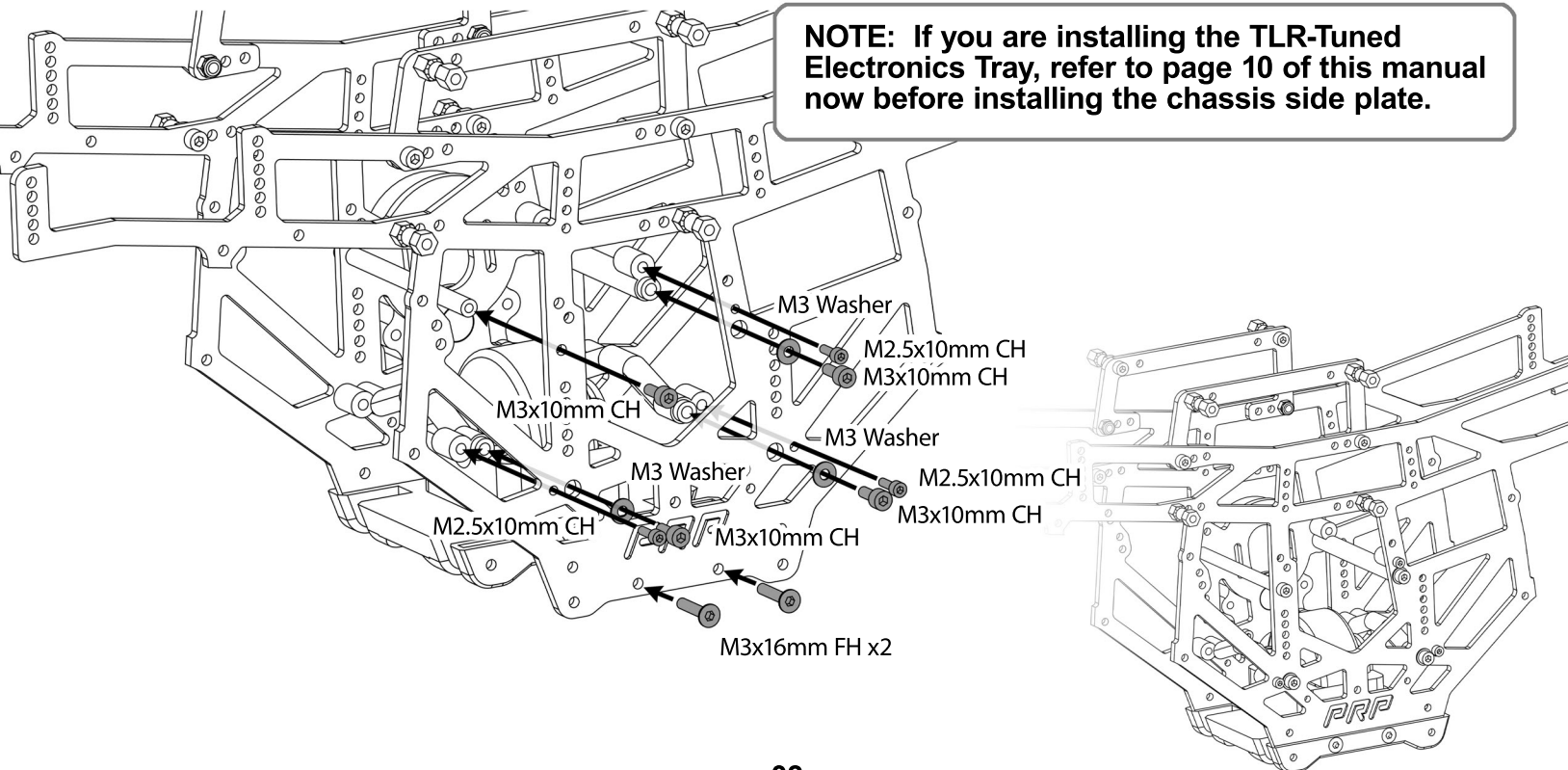

07

Insert Press Nuts into electronics tray mounts. Install electronics tray.

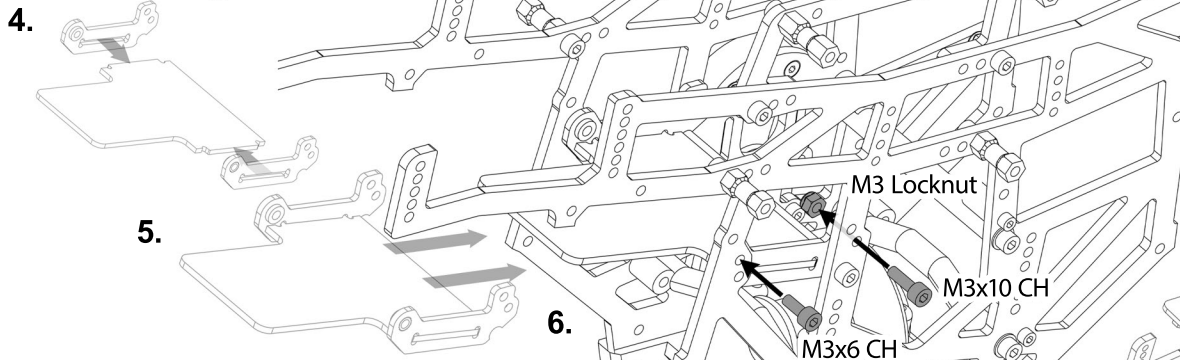
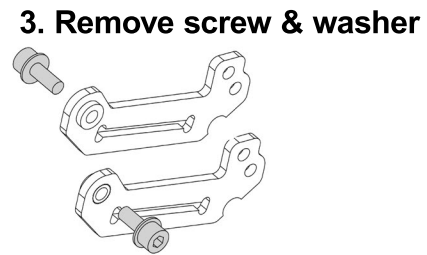
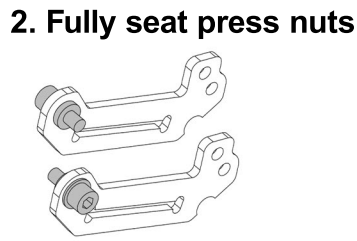
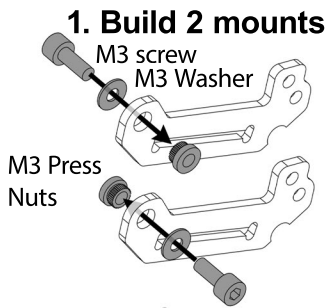
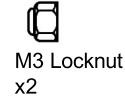
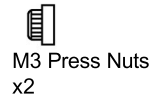

!! Install both sides !!

08

First attach rear sway bar into the rear sway bar mounts. Then position the assembly into the chassis and secure the left rear sway bar mount plate to the chassis.

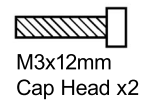
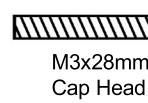
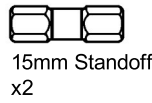



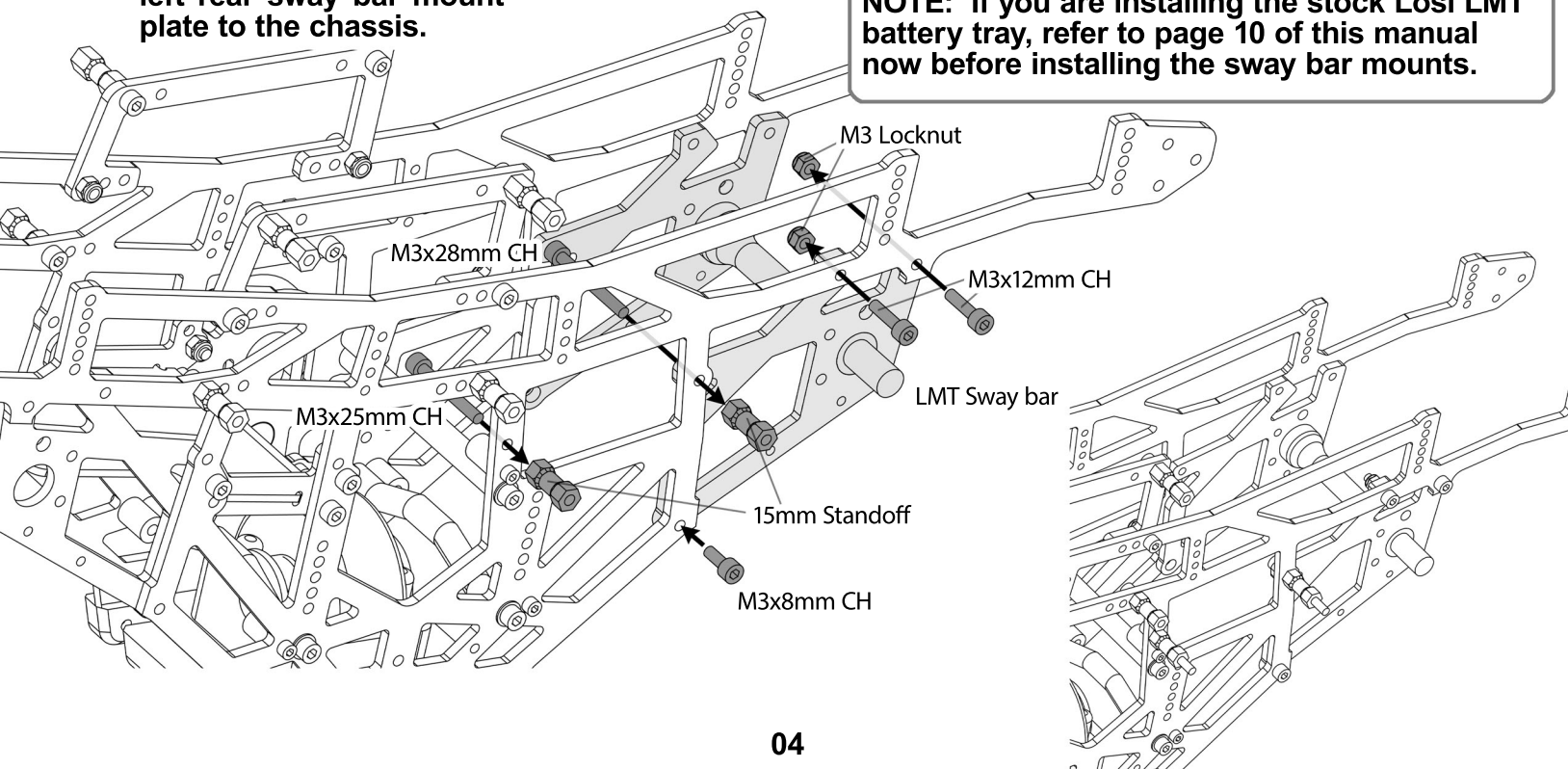

NOTE: If you are installing the stock Losi LMT battery tray, refer to page 10 of this manual now before installing the sway bar mounts.



09

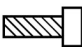

Attach right rear sway bar mount

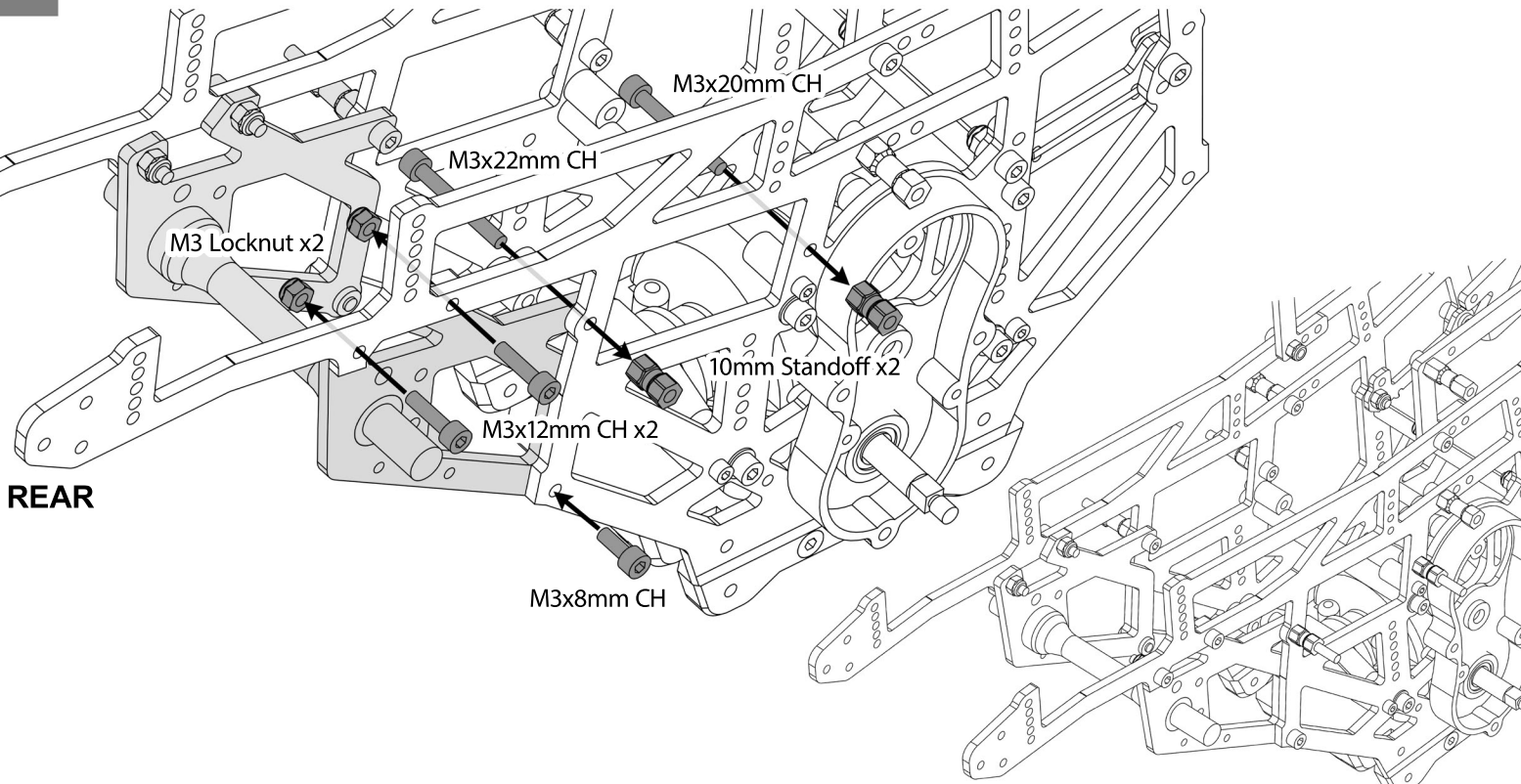
- 
 M3 Locknut
x2
- 
 10mm Standoff
- 
 M3x22mm
Cap Head
- 
 M3x20mm
Cap Head
- 
 M3x12mm
Cap Head x2
- 
 M3x8mm
Cap Head



10

Attach front sway bar and sway bar mounts.

- 
 M3 Locknut
x6
- 
 M3x12mm
Cap Head x6
- 
 M3x8mm
Cap Head x2

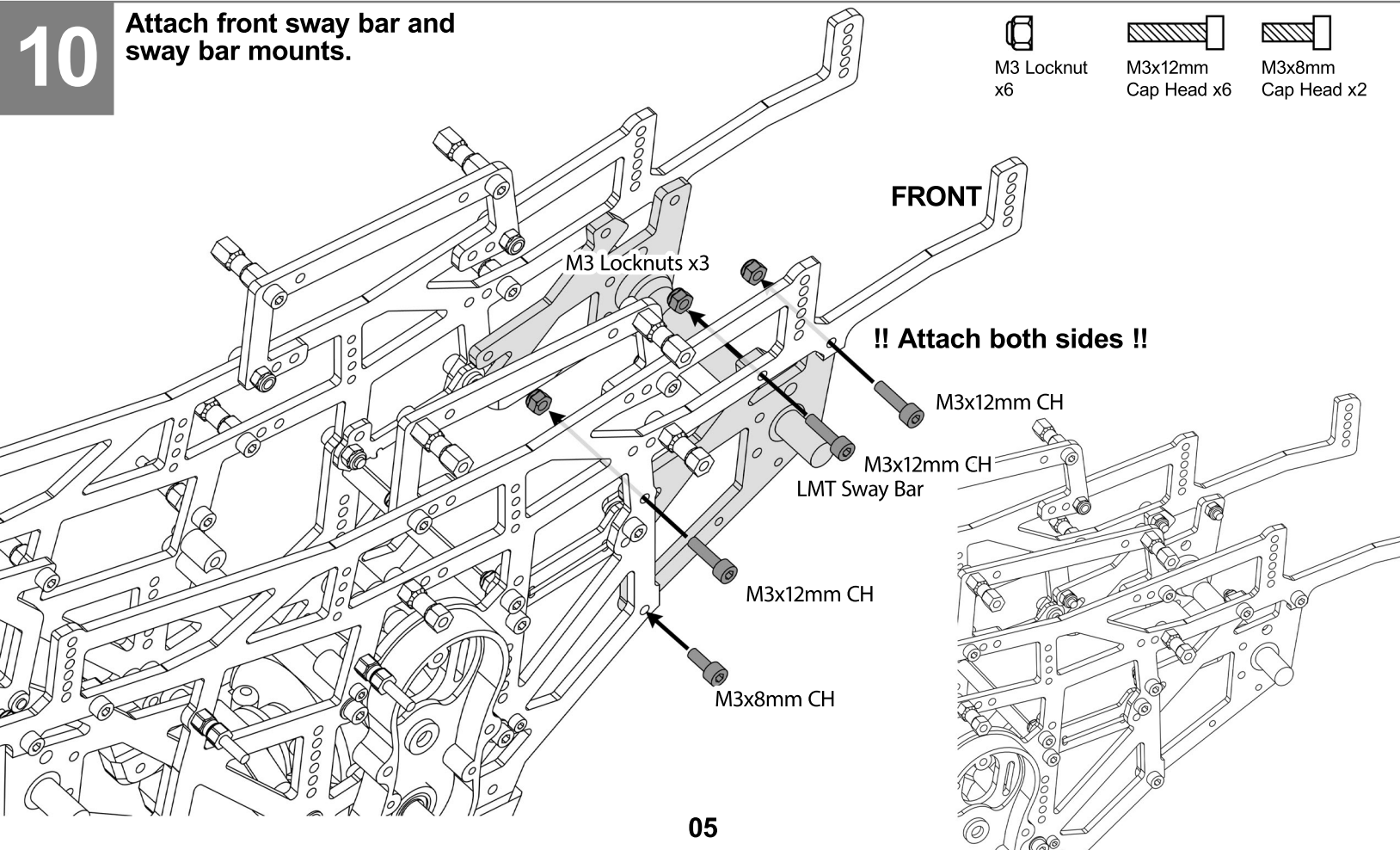

11

Attach chassis trim to all 4 sway bar mounts. Trim is not used with the optional link mounted shock mount plates.



M2.5 Locknut x8



M2.5x10mm
Cap Head x8

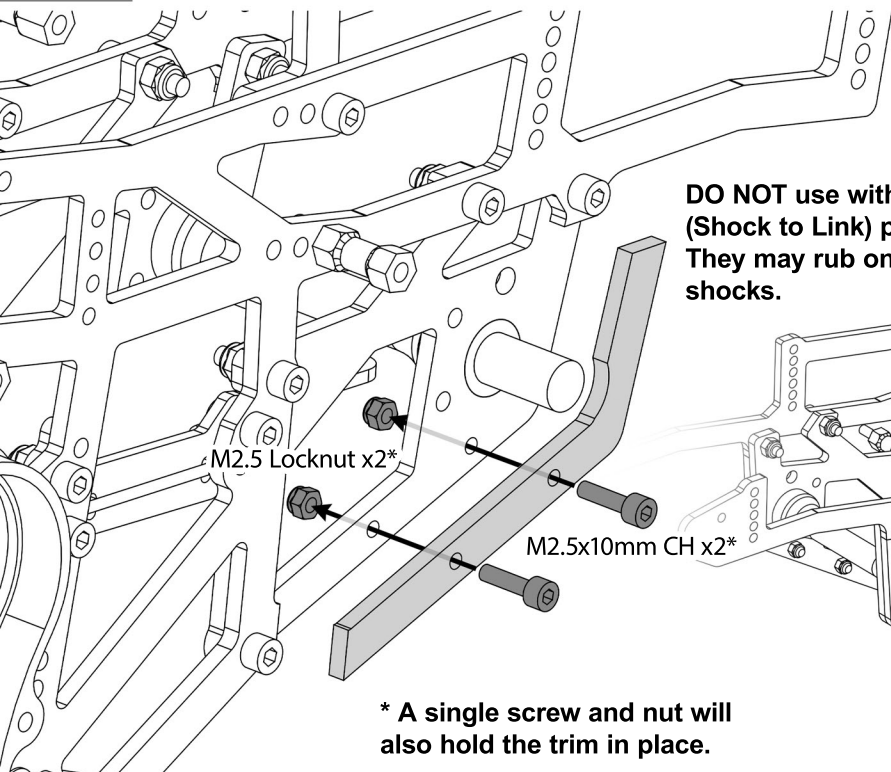

DO NOT use with STL (Shock to Link) plates. They may rub on the shocks.

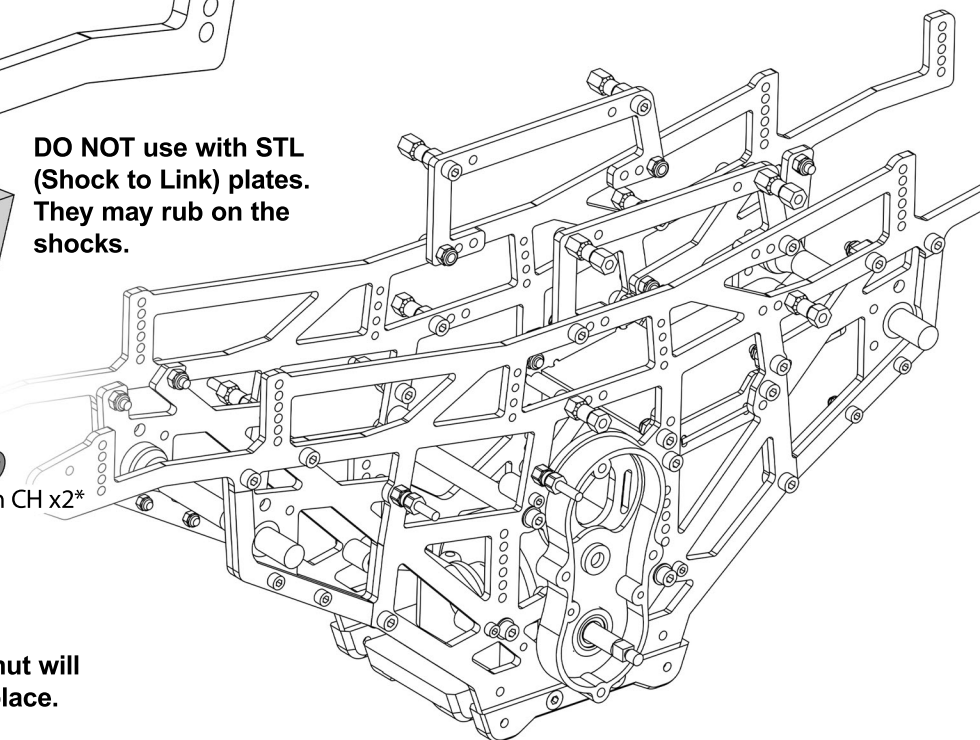

* A single screw and nut will also hold the trim in place.

12

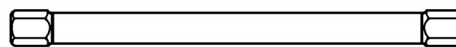

M3x60mm
Cross Brace x2



M3x10mm
Cap Head x4

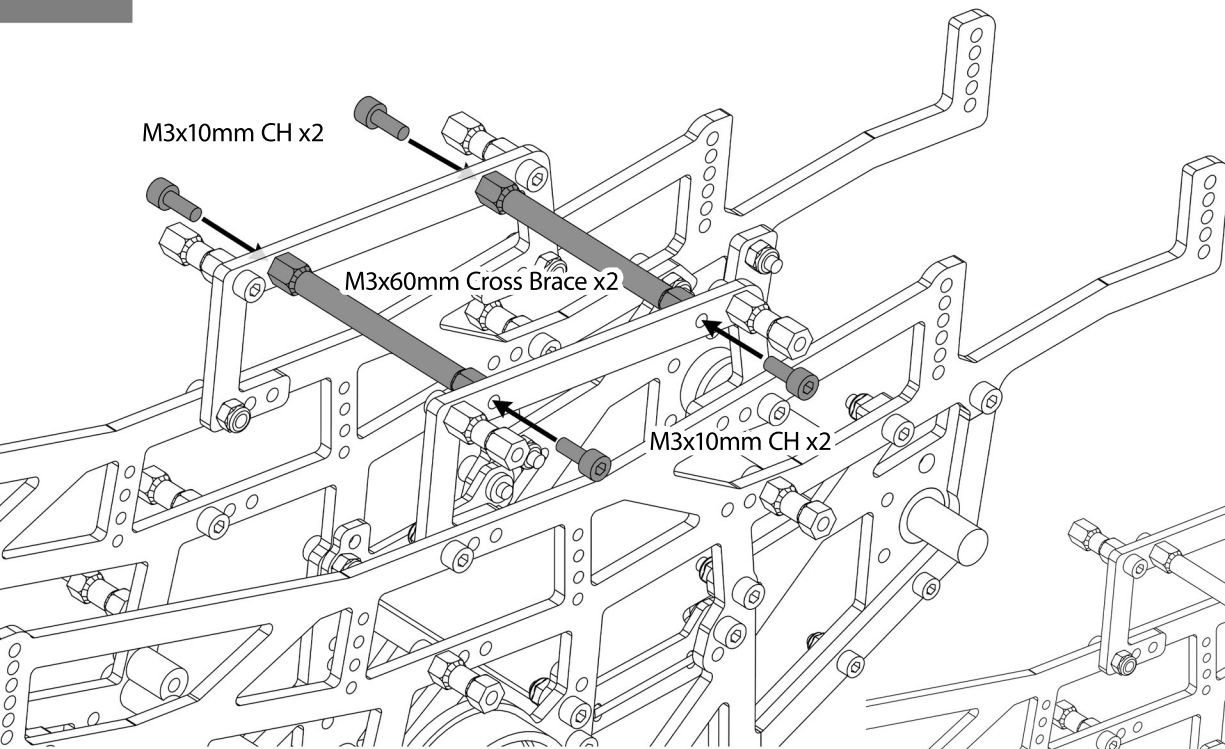

13 Install cab

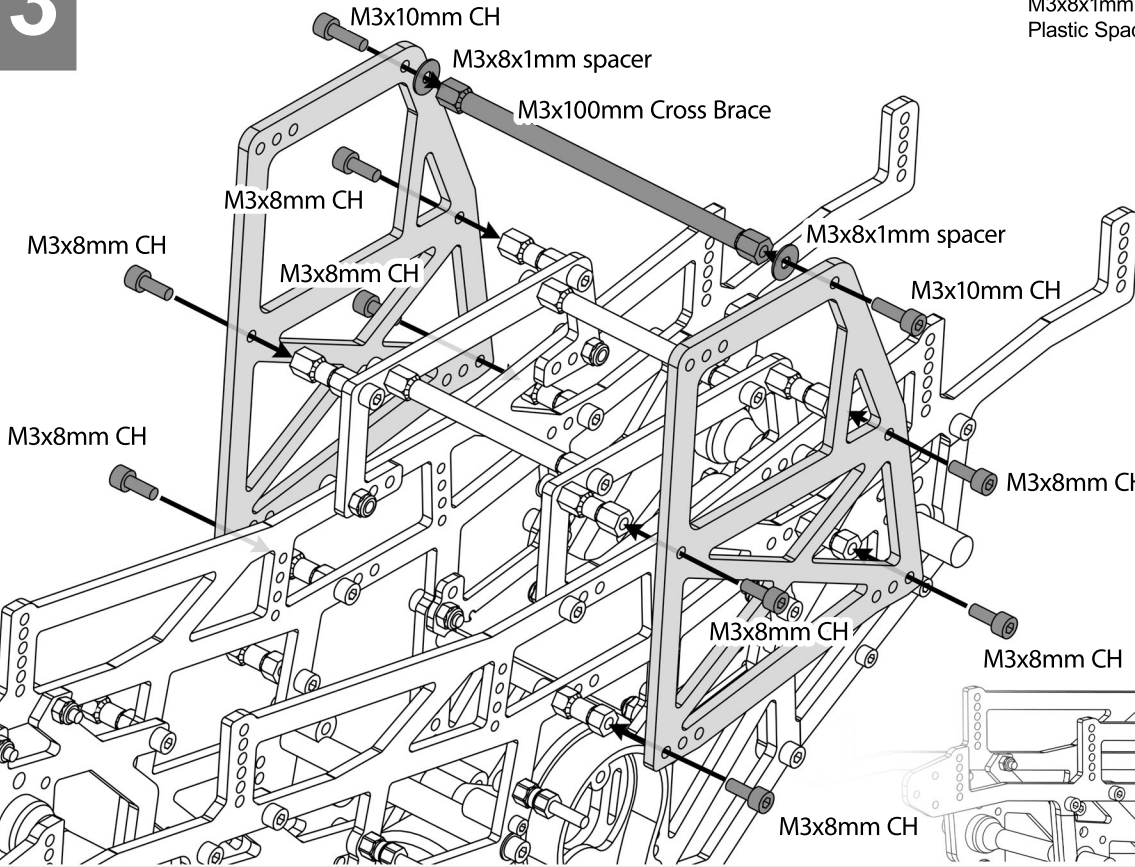

M3x8x1mm
Plastic Spacer x2



M3x10mm
Cap Head x2
(+2 when not
using roll bars)

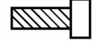

M3x8mm
Cap Head x8

14 Install roll bars (optional). If not installing roll bars use the other 100mm cross brace parts to secure the top rear of the cab (see image bottom right).

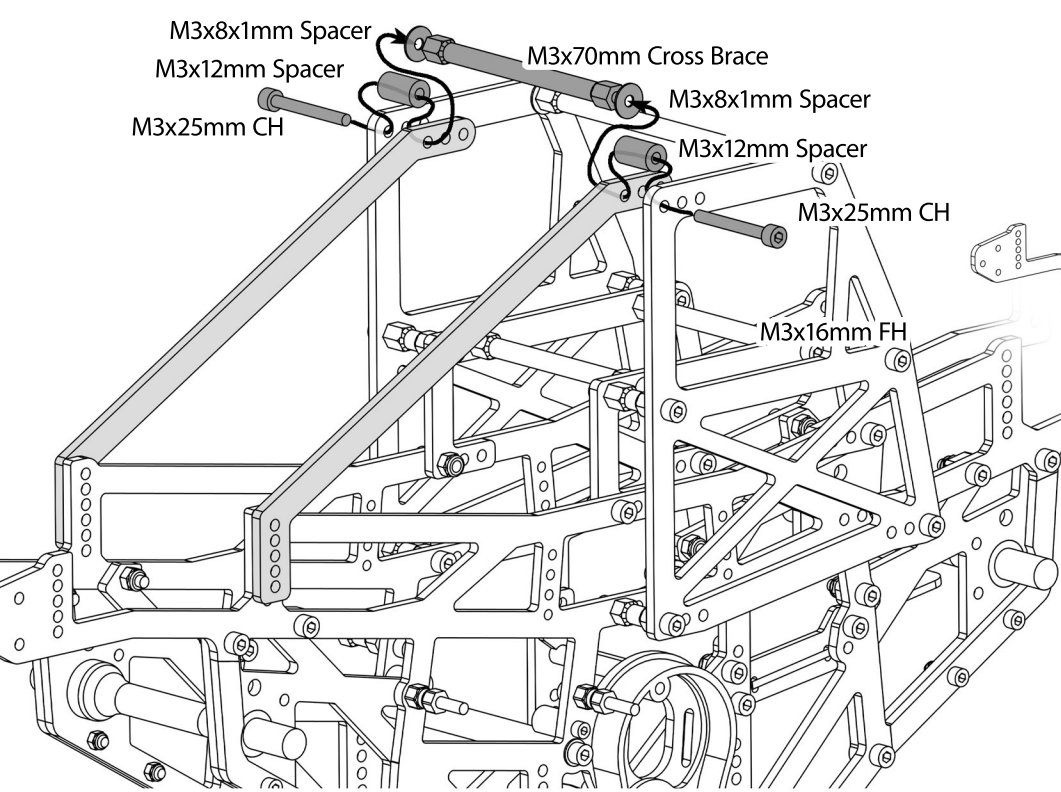

M3x12mm
Plastic Spacer x2



M3x8x1mm
Plastic Spacer x2



M3x25mm
Cap Head x2

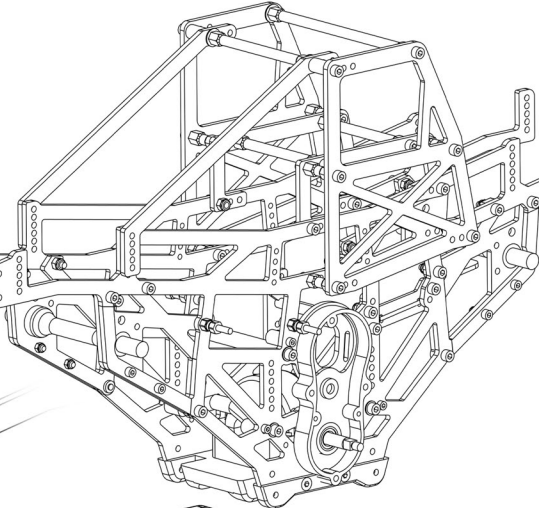

FULL CAGE RACER CHASSIS KIT FOR THE LOSI LMT

15

1. Install all 4 shock towers.
2. LMT Body Posts may be used in locations shown with included longer screws.

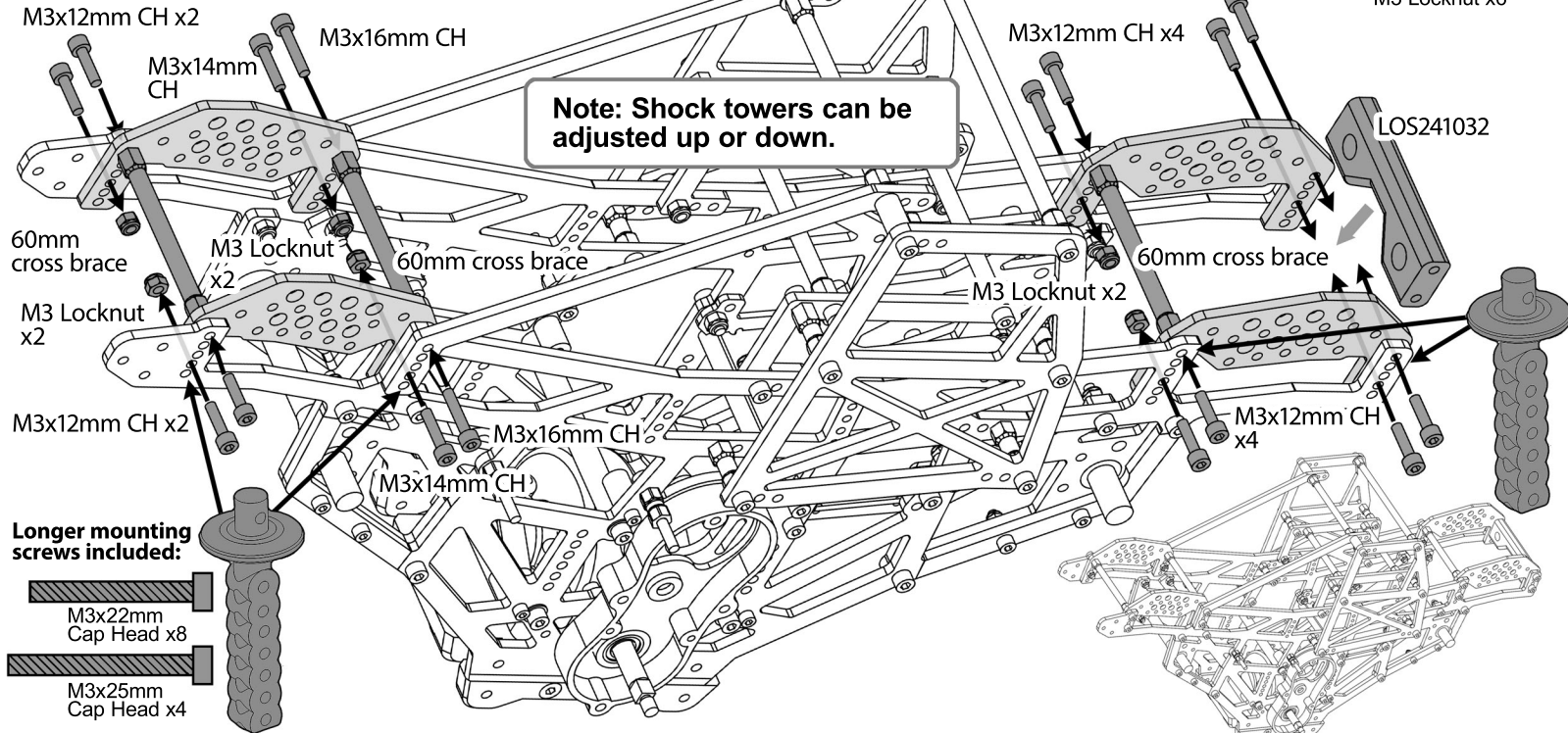
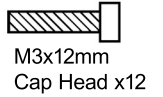
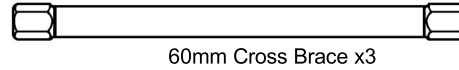



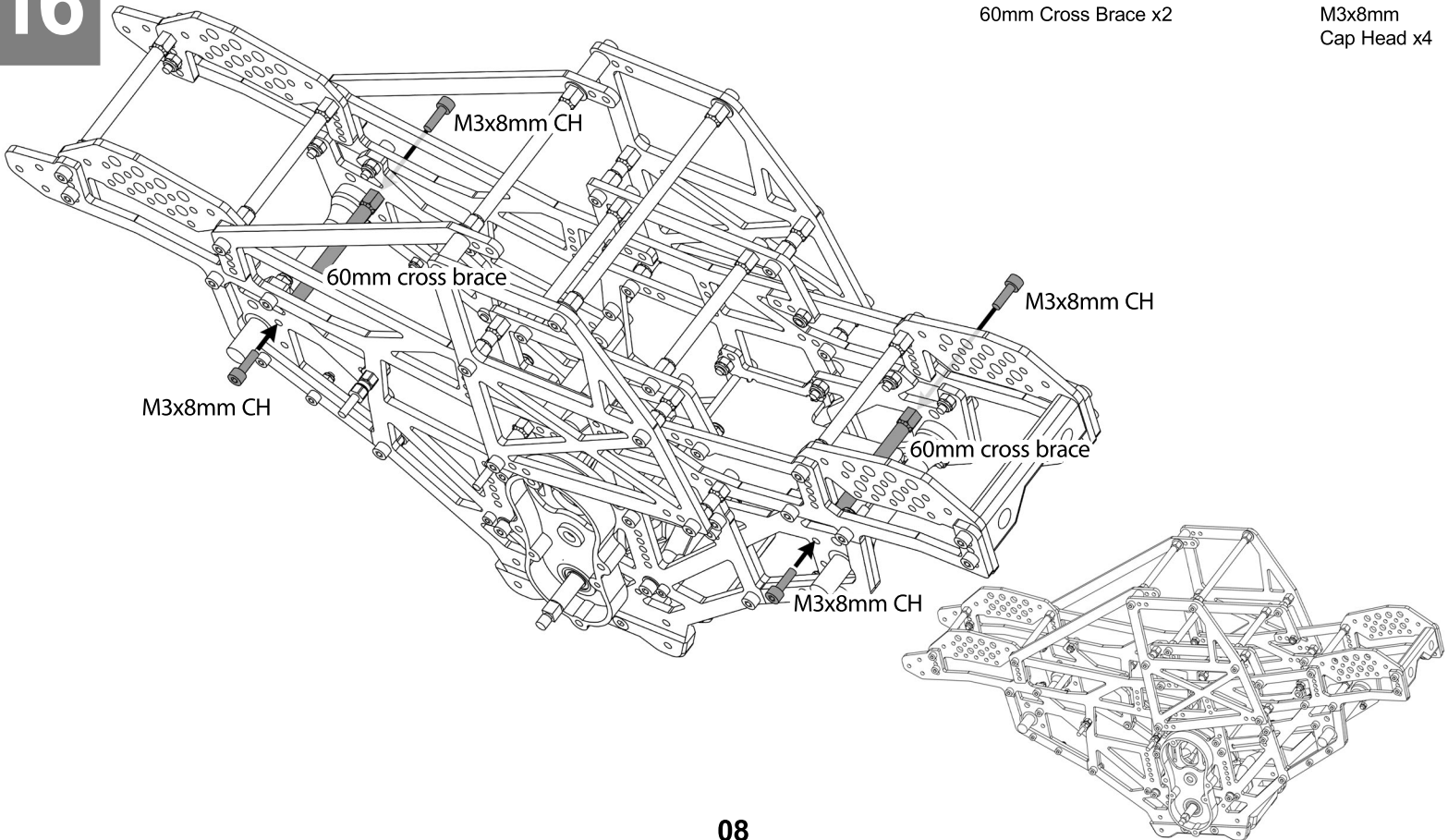
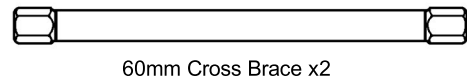

16

1. Install 60mm cross braces to sway bar mounts.



17

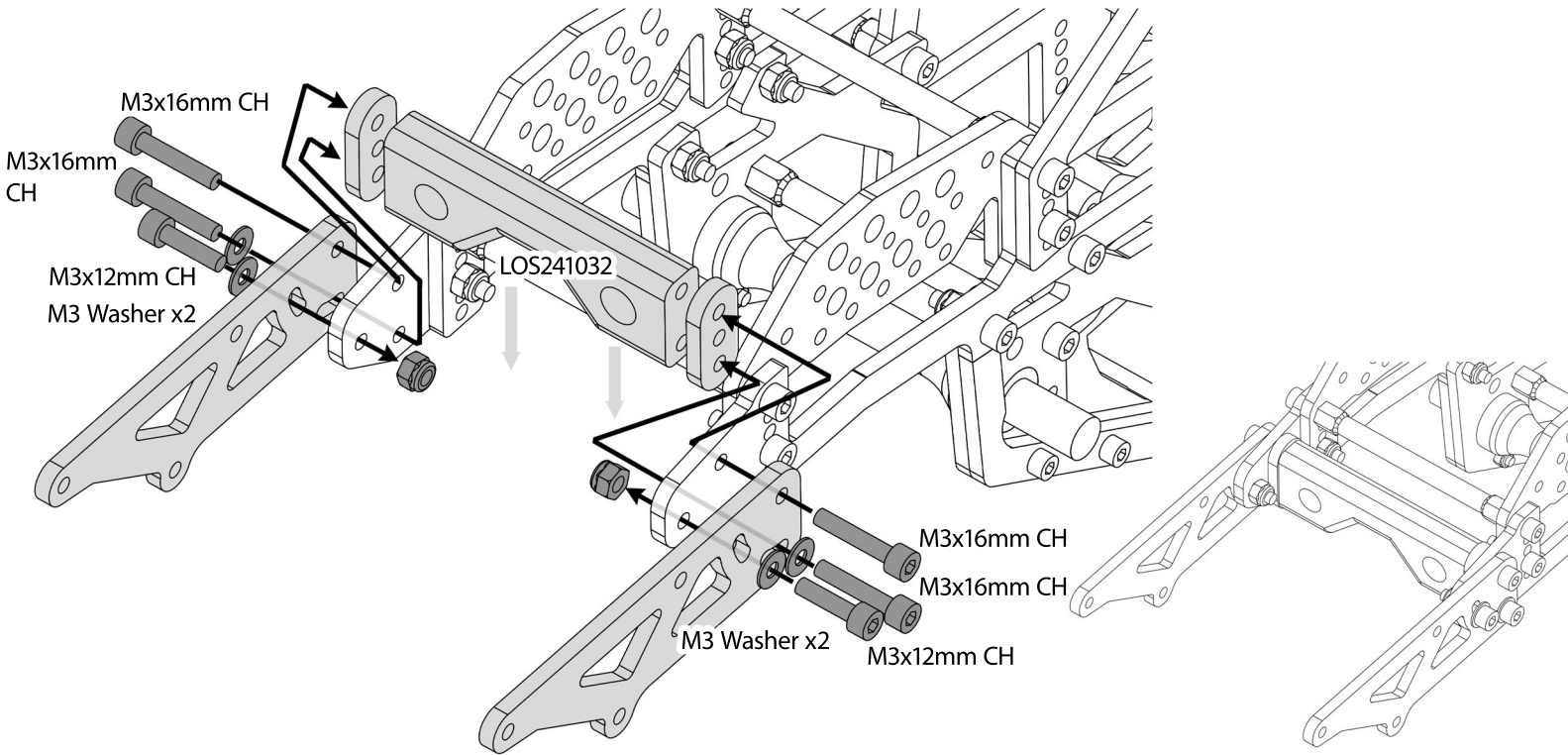

Install LOS241032 cross brace.
(Optional) Install wheelie bar mount for use with the TLR Tuned LMT Wheelie Bump Bar TLR141001.

-  M3 Locknut x2
-  M3 Washer x4
-  M3x16mm Cap Head x4
-  M3x12mm Cap Head x2

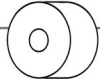

18

1. Install TLR Tuned LMT Wheelie Bump Bar TLR141001.
2. Install Battery Straps.

-  M3 Thumb Nut x4
-  M3x3mm Spacer x4
-  M3x12mm Cap Head x4

1. M3x3mm Spacer x4

M3x12mm CH x4

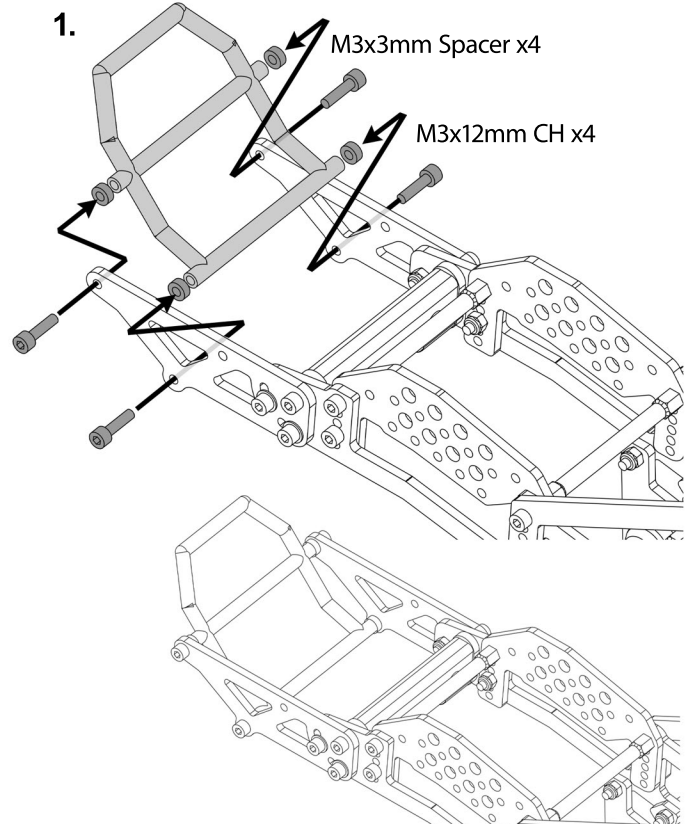

2. Install on both sides

Thumb nut x2

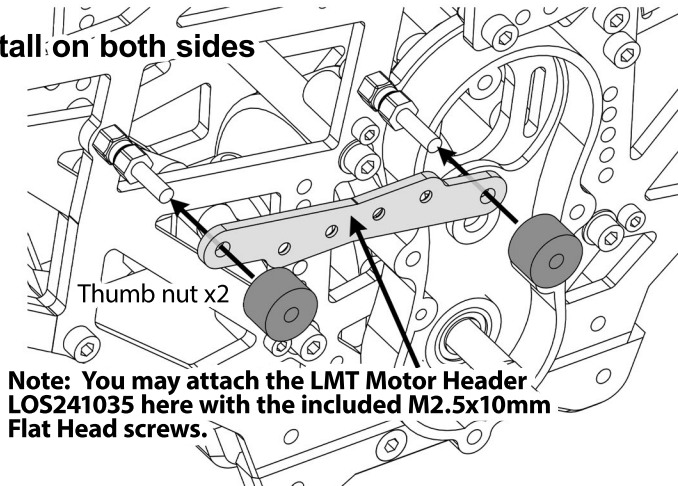

Note: You may attach the LMT Motor Header LOS241035 here with the included M2.5x10mm Flat Head screws.

If installed correctly the M2.5 holes will line up parallel to the ground (straight across).

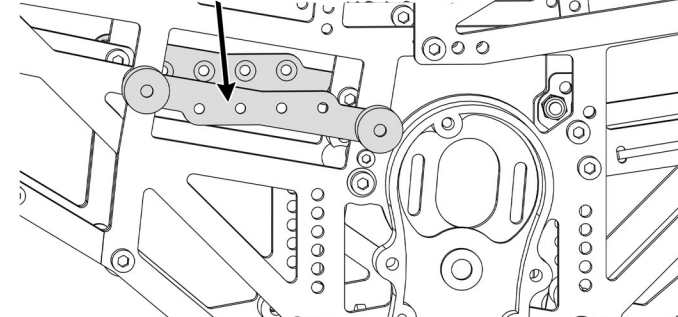





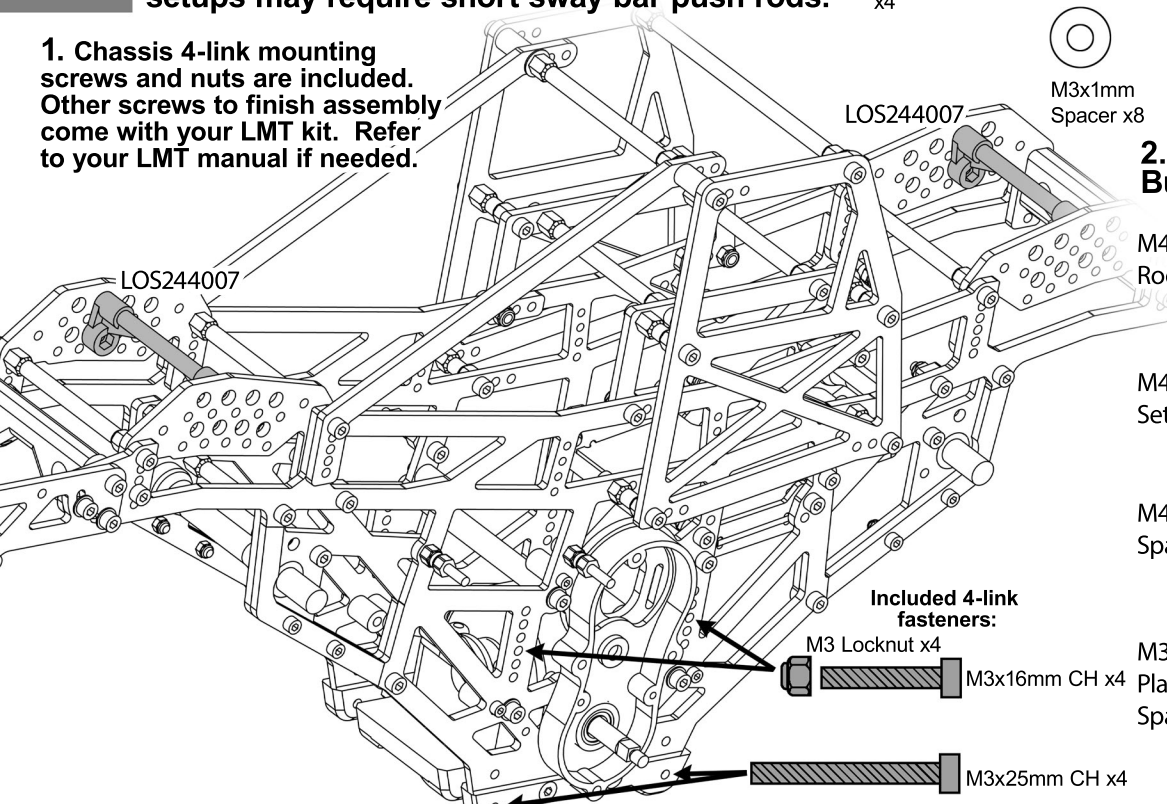

19



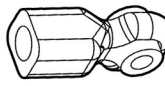

1. Attach Losi upper braces, shocks, axles, 4-links per usual. Refer to TLR Tuned LMT Losi manual if needed. 2. * Lower ride height setups may require short sway bar push rods.

1. Chassis 4-link mounting screws and nuts are included. Other screws to finish assembly come with your LMT kit. Refer to your LMT manual if needed.

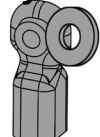

- 
 M4x3mm Plastic Spacer x4
- 
 M3 Locknut x4
- 
 M3x25mm Cap Head x4
- 
 M3x16mm Cap Head x4
- 
 M3x1mm Spacer x8
- 
 M4x20mm Set Screw x4
- 
 M4x17mm Rod End x8

2. * OPTIONAL: Build sway bar push rods



- 
 M4x17mm Rod End x8
- 
 M4x20mm Set Screw x4
- 
 M4x3mm Spacer x4
- 
 M3x1mm Plastic Spacer x8

x4

!! Attach with 1mm spacers to fill gap in the sway bar mounts !!

alt.

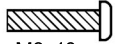
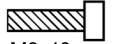
Alternative tray options: You may use the TLR Tuned LMT Electronics Tray LOS241069 and the Losi Battery Tray LOS241065 or a combination of either with the FCR tray or battery mount.

- 
 M3x10mm Button Head x2
- 
 M3x10mm Cap Head x2
- 
 M3x8mm Cap Head x4
- 
 M2.5x8mm Cap Head x2

!! DO NOT use M2.5x9 MF Standoffs if you are attaching the battery tray to the TLR electronics tray like in step H1 from the TLR Tuned LMT Manual !!

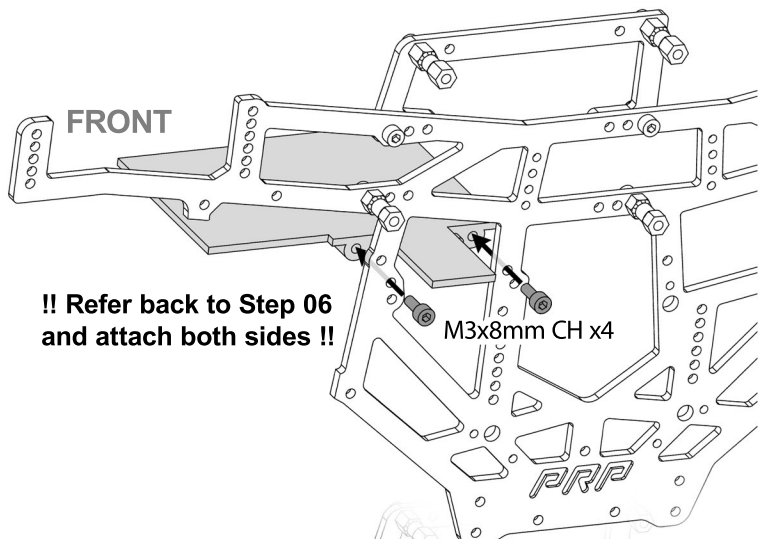

!! Refer back to Step 06 and attach both sides !!

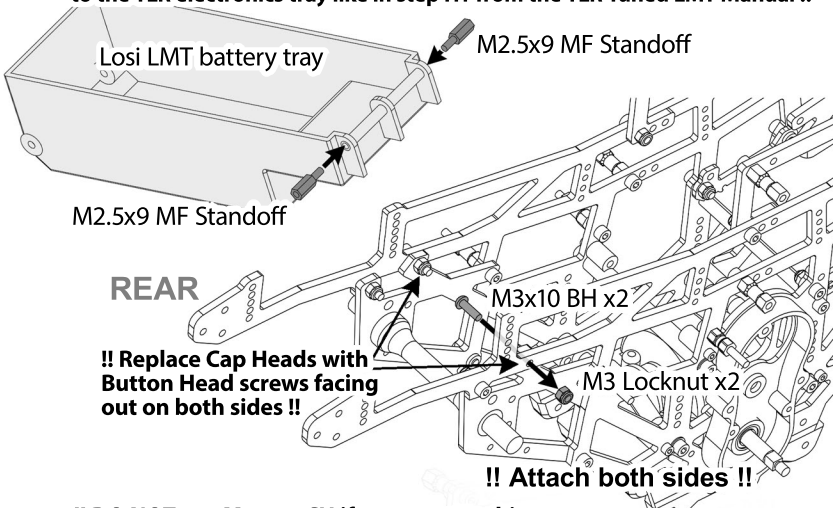

!! Replace Cap Heads with Button Head screws facing out on both sides !!

!! Attach both sides !!

!! DO NOT use M2.5x8 CH if you are attaching the battery tray to the TLR electronics tray like in step H1 from the TLR Tuned LMT Manual.

!! Attach both sides then return to step 8 !!

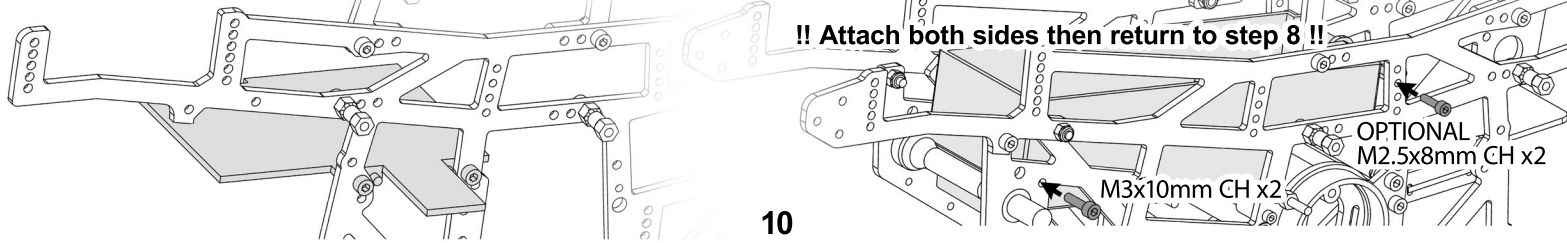

Congratulations on your Team PRP **FCR** LMT build!

Check our shop at teamprp.bigcartel.com for option parts and new releases and to contact us for spare parts, extra hardware and email support.

Please tag us [@teampracing](https://www.instagram.com/teampracing) to share your builds and race videos! We may feature them on our social media.

Thank you for supporting us and thank you for racing with **Team PRP!**

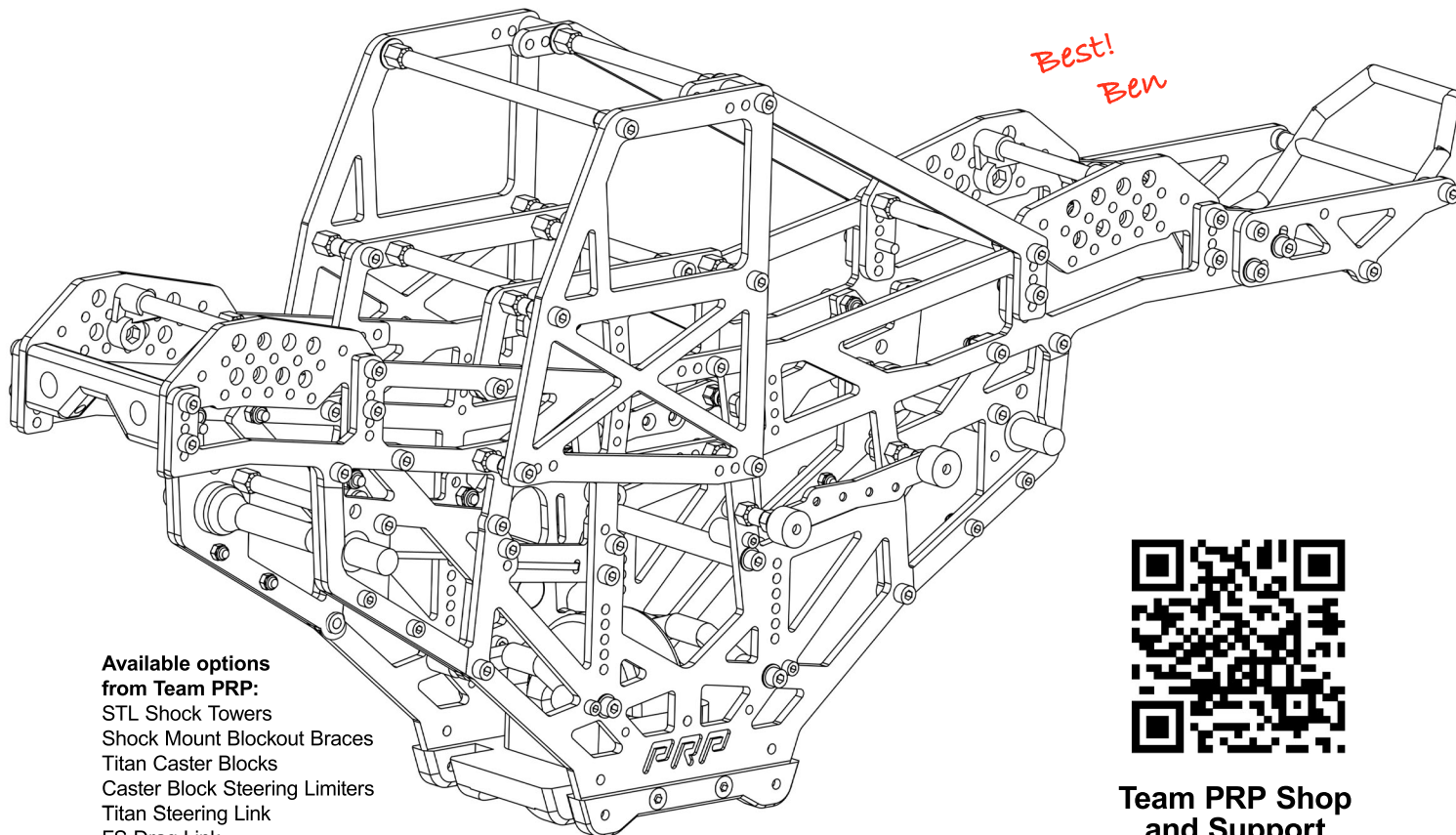

Available options from Team PRP:

- STL Shock Towers
 - Shock Mount Blockout Braces
 - Titan Caster Blocks
 - Caster Block Steering Limiters
 - Titan Steering Link
 - FS Drag Link
 - Axle weight Mounts
 - SOACAPs
 - Upper Link Braces
 - Servo Spacer
- Visit the shop for more!



Team PRP Shop and Support

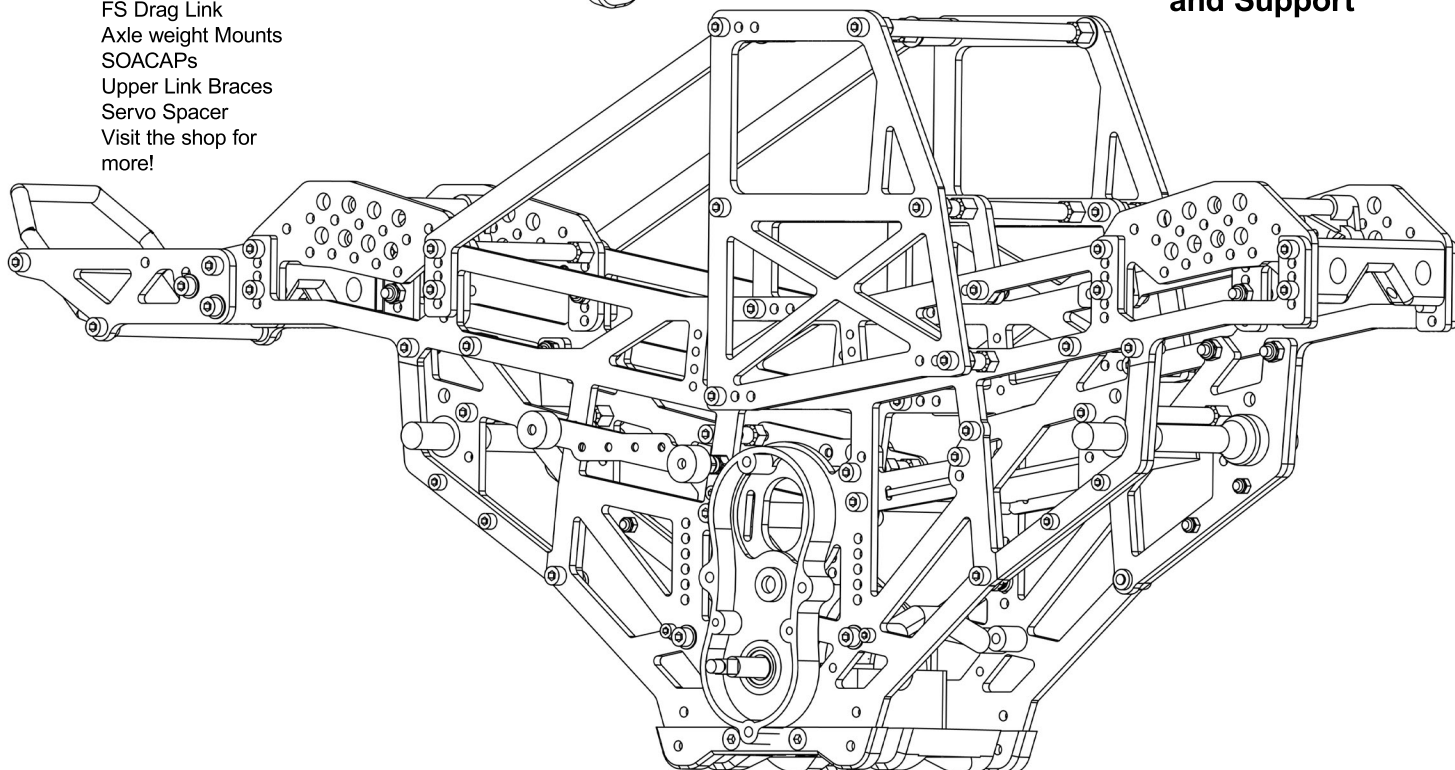



DRIVER: _____ **TRUCK NAME:** _____ **BODY:** _____

EVENT: _____ **DATE:** _____ **FINISH:** _____

TRACK: _____ **SURFACE TYPE:** _____ **Track Length:** _____ **Width:** _____

TRACTION: Low / Med / High / Very High **CONDITION:** Dry / Damp / Wet / Dusty / Hard Pack / Bumpy

TEMPERATURE: _____ ° **WEATHER:** _____ **Smooth / Loamy / Other:** _____

teampracing on instagram / facebook

LMT FCR Chassis Conversion Setup Sheet

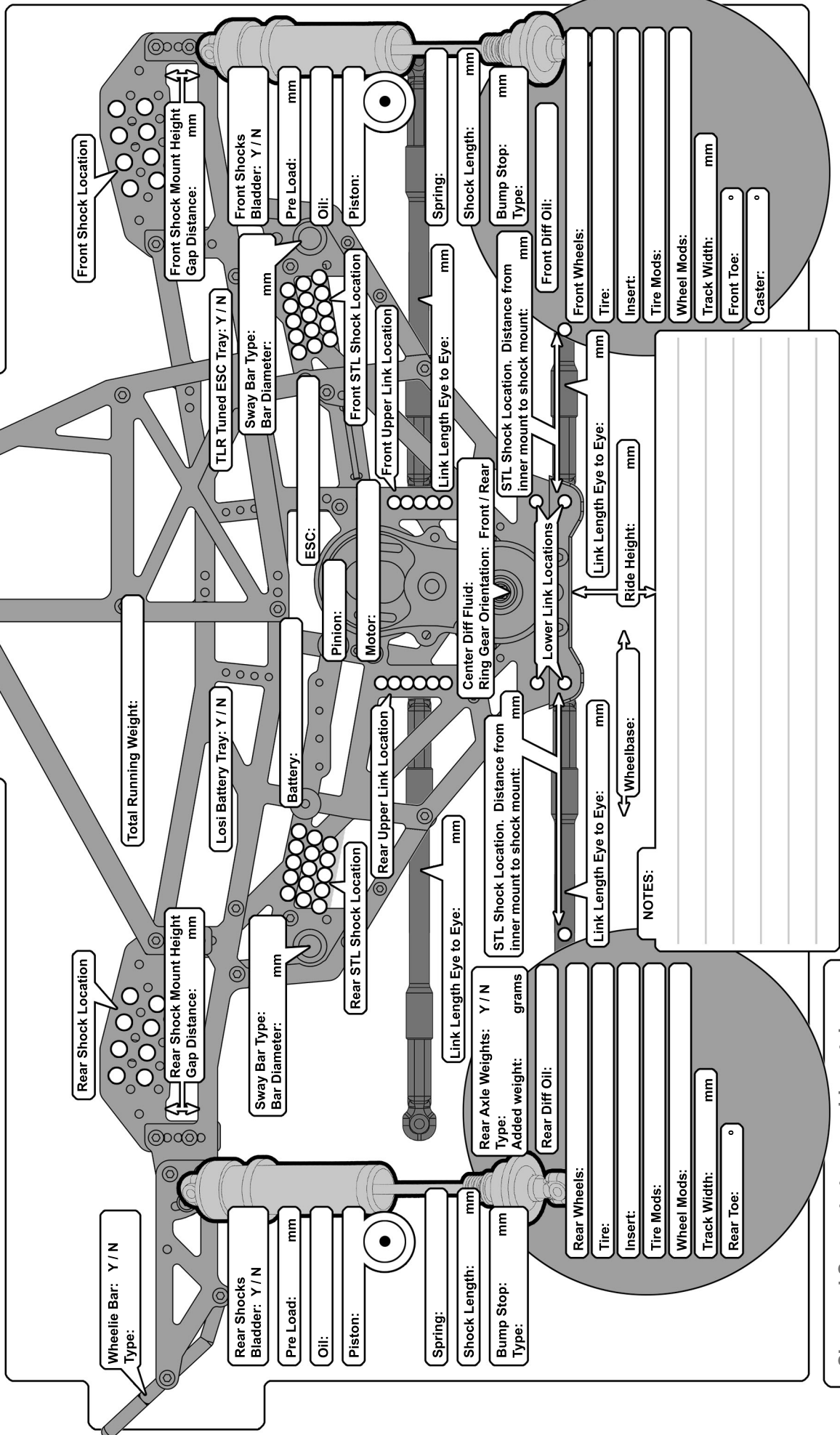

NOTES:
