

FCR12

Associated MT12

Monster Truck Chassis Conversion Kit

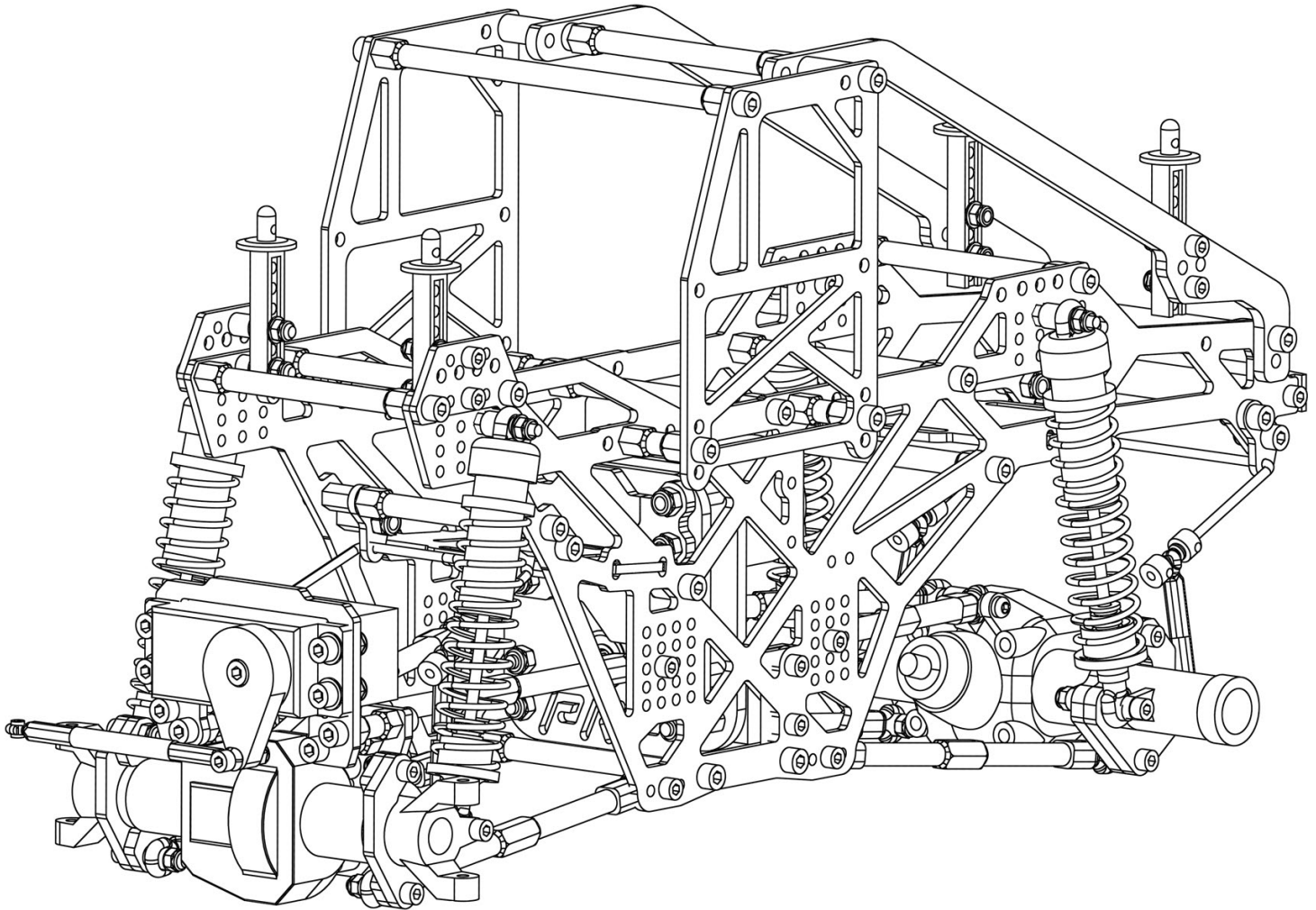

Instruction manual (beta)

TEAM PRP

01

1-2. Press inner front axle clamps onto axles between the axle tabs and rest them against the inner axle tab. 3-4. Press outer front axle clamps onto axles and position them on the outside of the inner axle clamps and align mounting holes. 5-6. Rotate clamps for easier hardware install.



M2.5
Locknut x2



M2.5x10mm
Cap Head x2

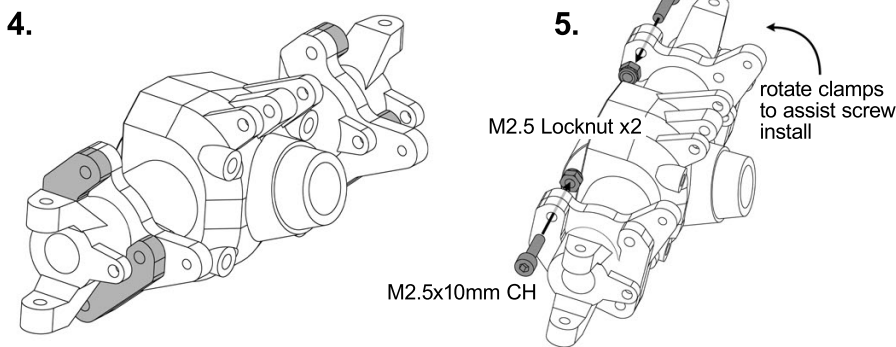
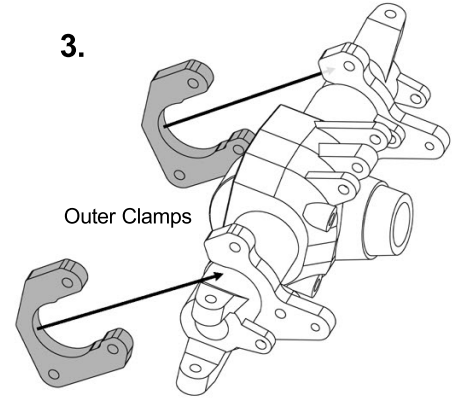
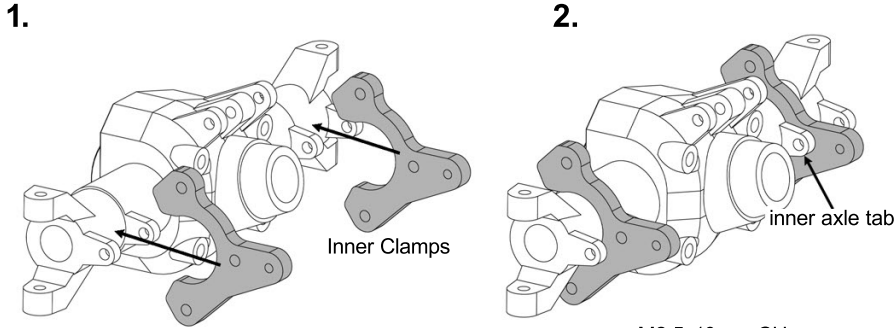

WARNING!
My line renders do not show wheel axles and shafts. Make sure your axles are built with internal hardware before proceeding.

NOTE:
You may leave the front clamps in this rotated position to help with lower link install in Step 3.

02

1. Attach stock MT12 front upper links with MT12 kit screw.
2. Assemble servo mount.
3. Install servo mount onto front axle.



M3x25mm
Cap Head x4



M3x8mm
Cap Head x8

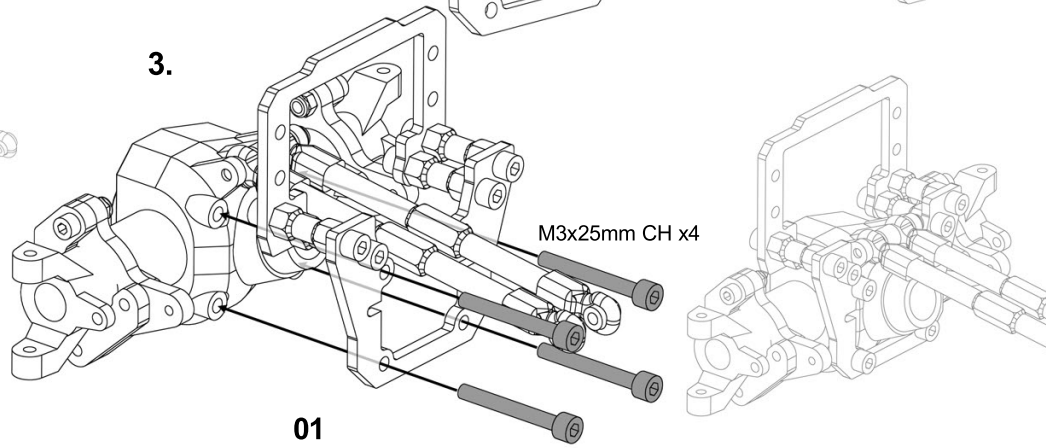
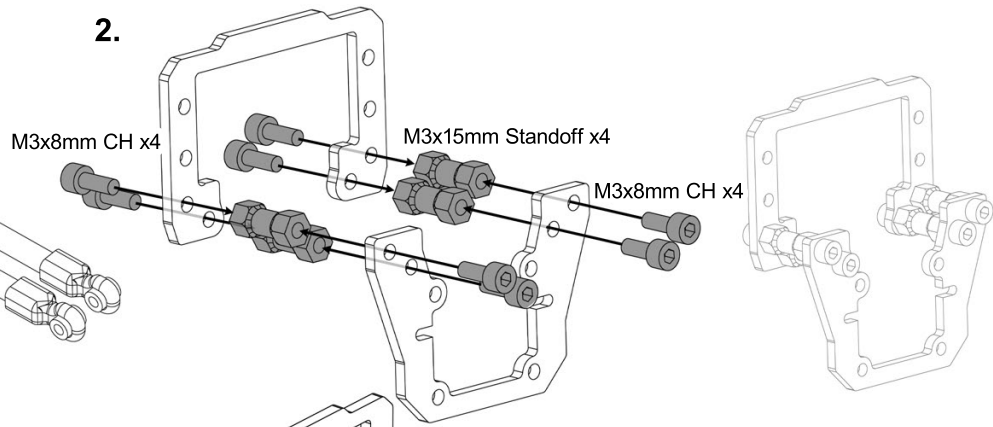
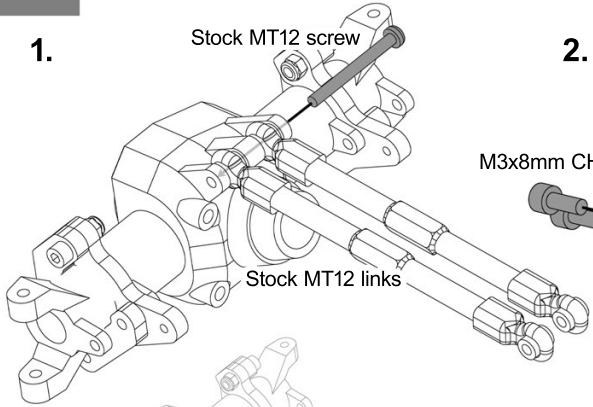

03

1. Attach lower links to the front axle.



M2.5
Locknut x2



M2.5x16mm
Cap Head x2

1.

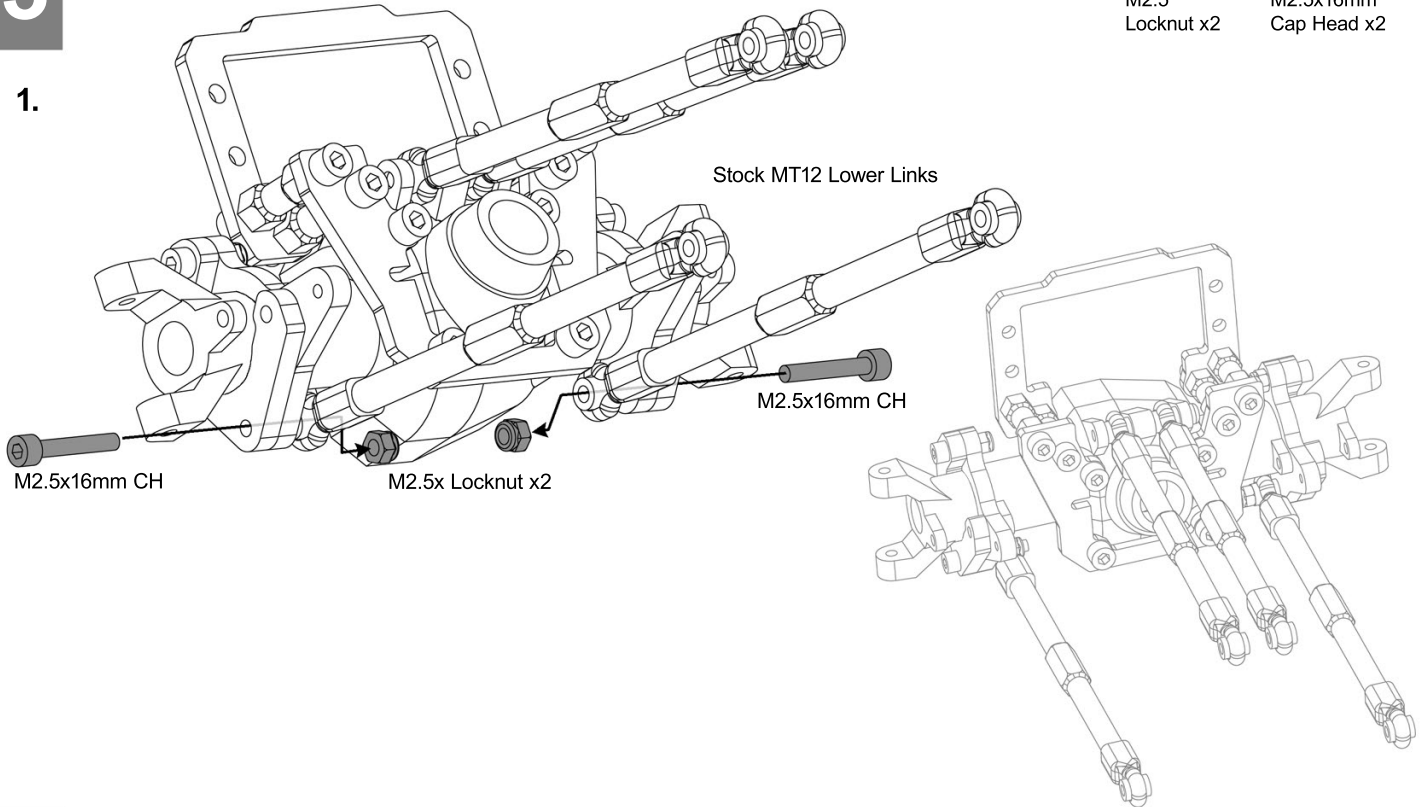

04

1. Press inner rear axle clamps onto rear axles between the axle tabs and rest them against the inner axle tab. Then press outer rear axle clamps onto axles and position them on the outside of the inner axle clamps and align mounting holes. 2. Bolt the top of the axle clamps together.



M2.5
Locknut x2



M2.5x10mm
Cap Head x2

1.

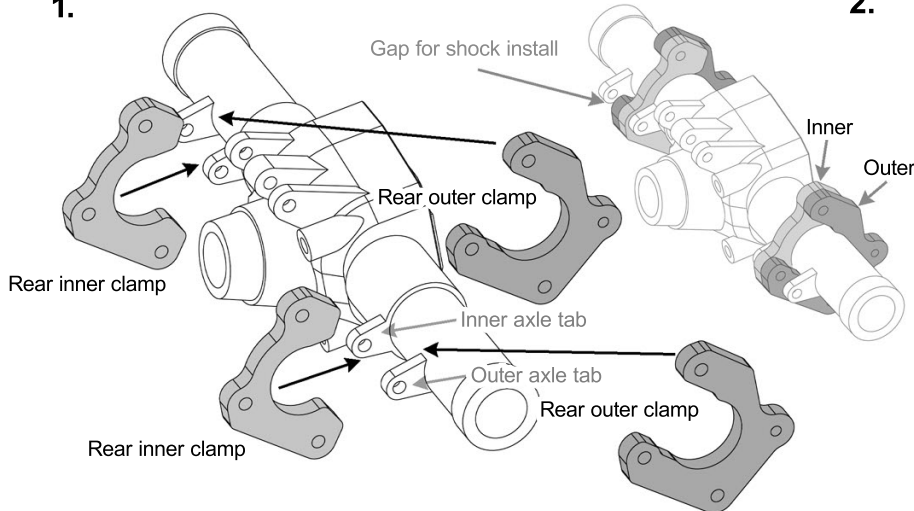

2.

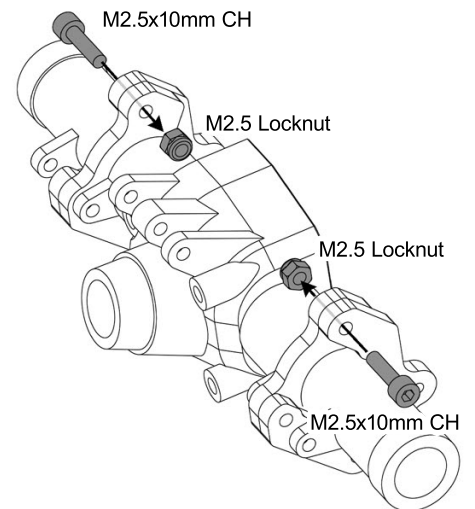

05

1. Attach the stock MT12 upper and lower links to the rear axle.



M2.5
Locknut x2



M2.5x16mm
Cap Head x2

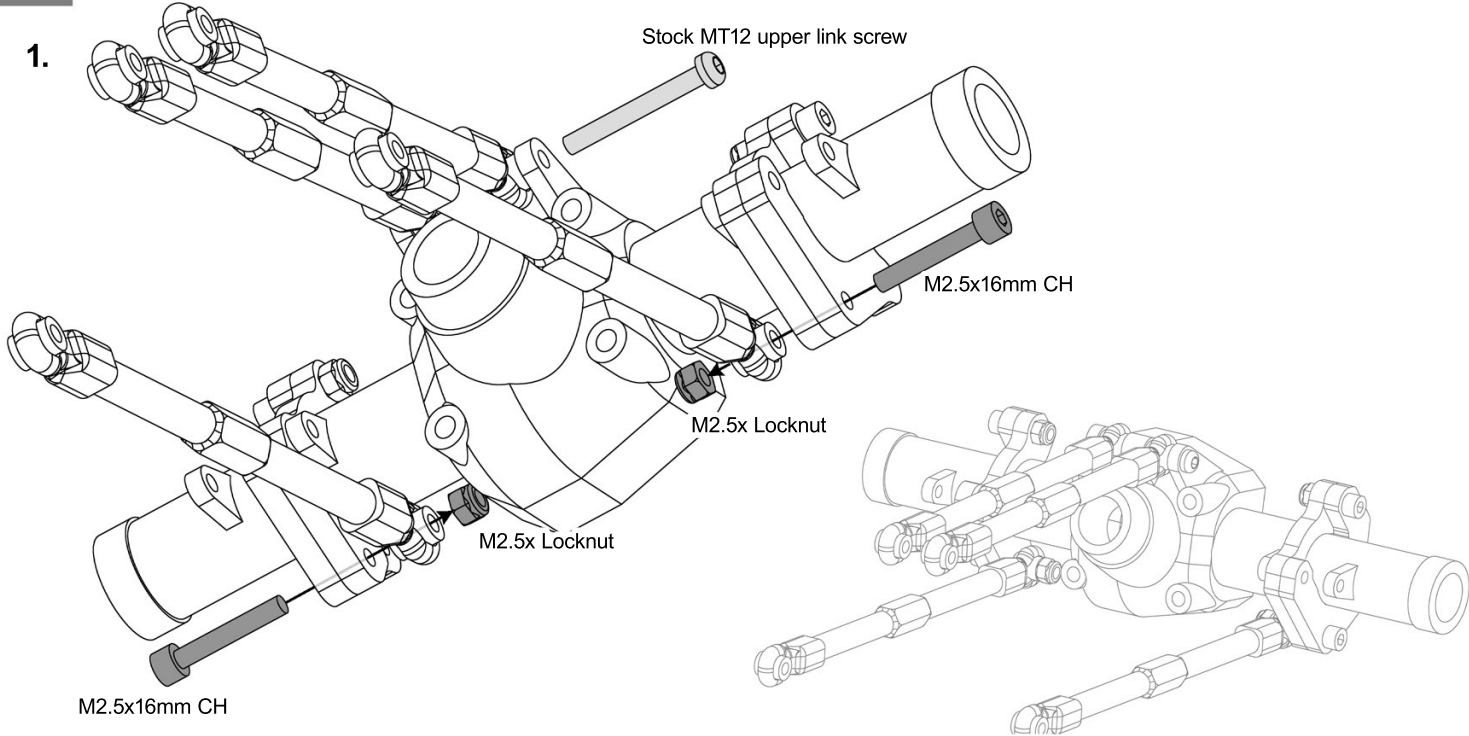

06

Transmission assembly.



M3x9mm
Standoff x9



M3x22mm
Cap Head x9

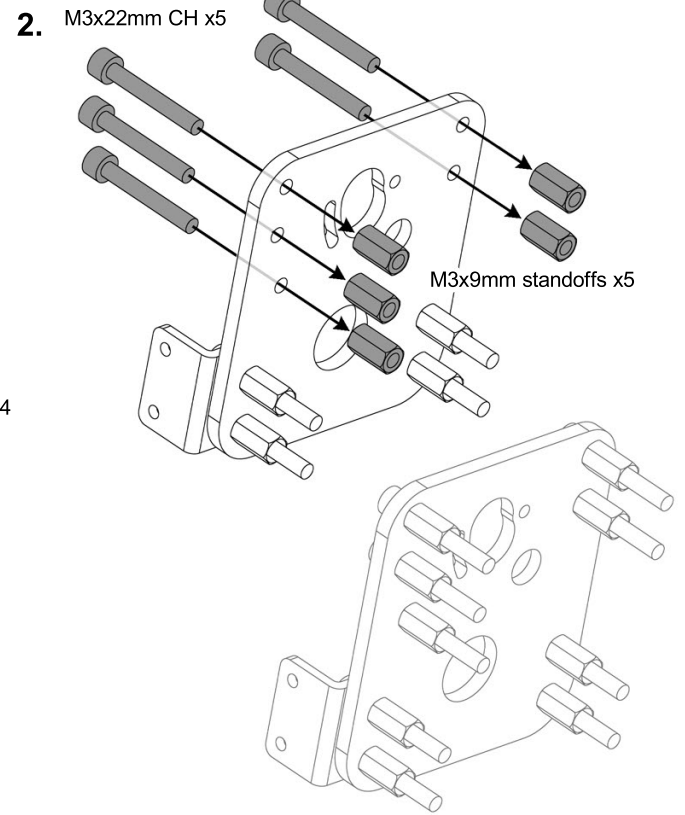
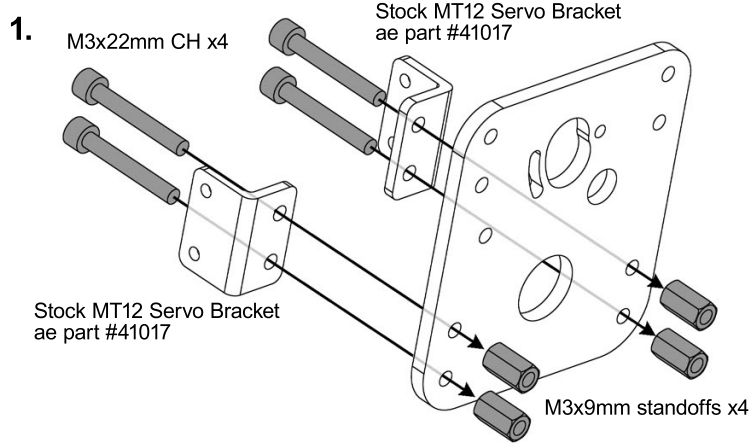

07

1. Press in bearings making certain they are fully seated.
2. Place stock MT12 gears into position. M3x16mm Shaft may fit tightly into bearings.

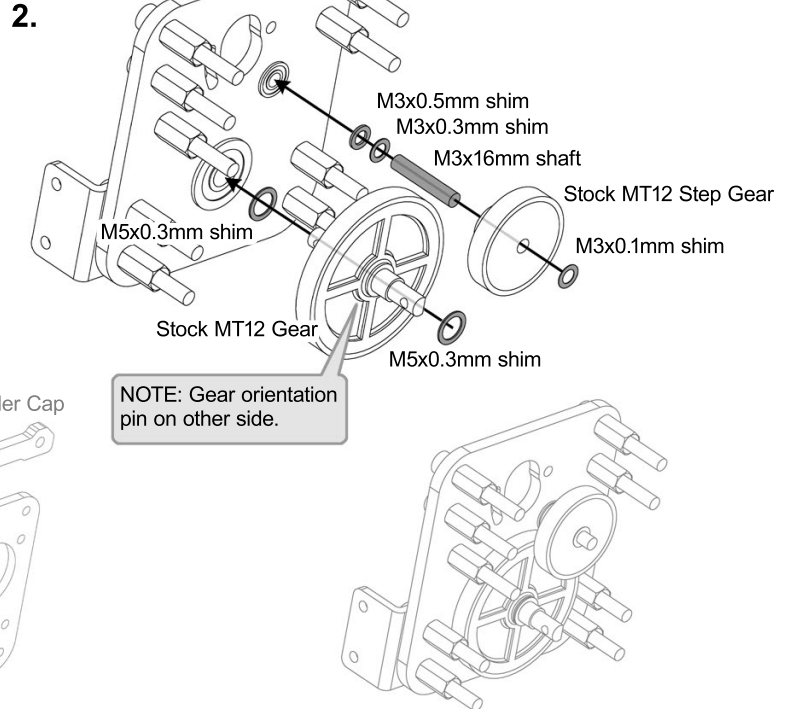
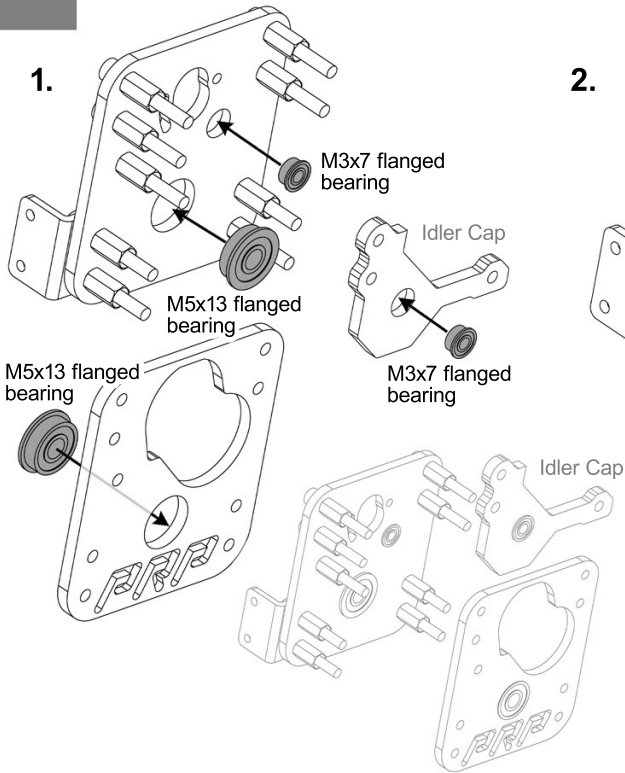
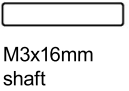

08

1. Carefully press transmission half and idler cap into place securing with locknuts.
- 2-3. Install Motor.

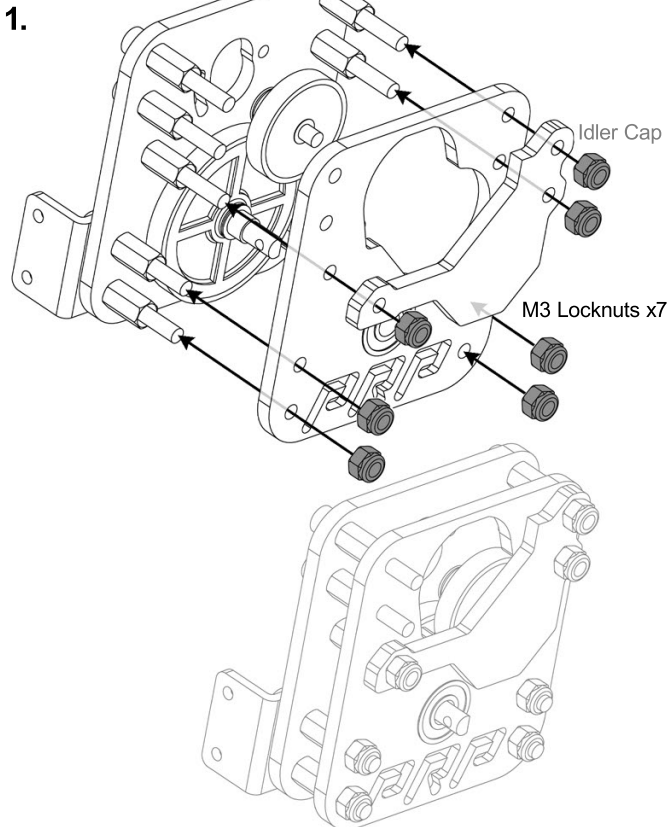

2. The stock MT12 motor requires both spacers. Other motors may require 1 or none depending on shaft length.

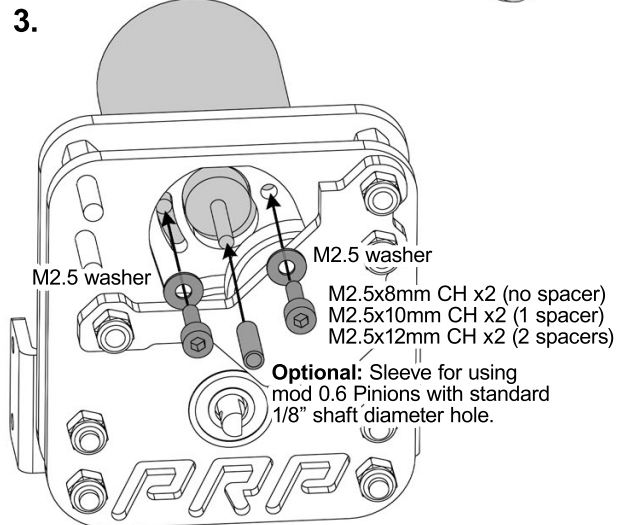
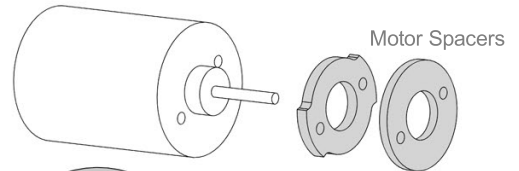

09

1. Attach mod 0.6 pinion gear. I don't need to show you how to install a pinion gear do I? ;) Then attach the motor access cap.
2. Attach hardware to the main chassis plate. This will now be the **right side chassis plate**.

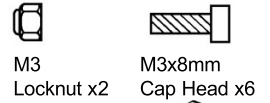

1. Attach Mod 0.6 pinion of choice. Set proper gear mesh then attach motor cap.

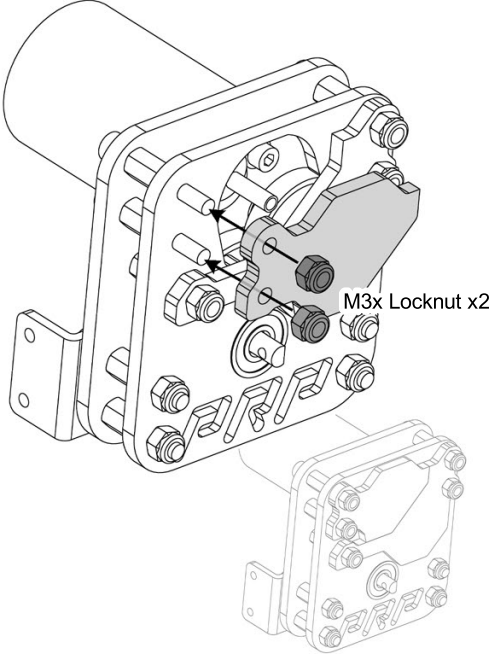

2.

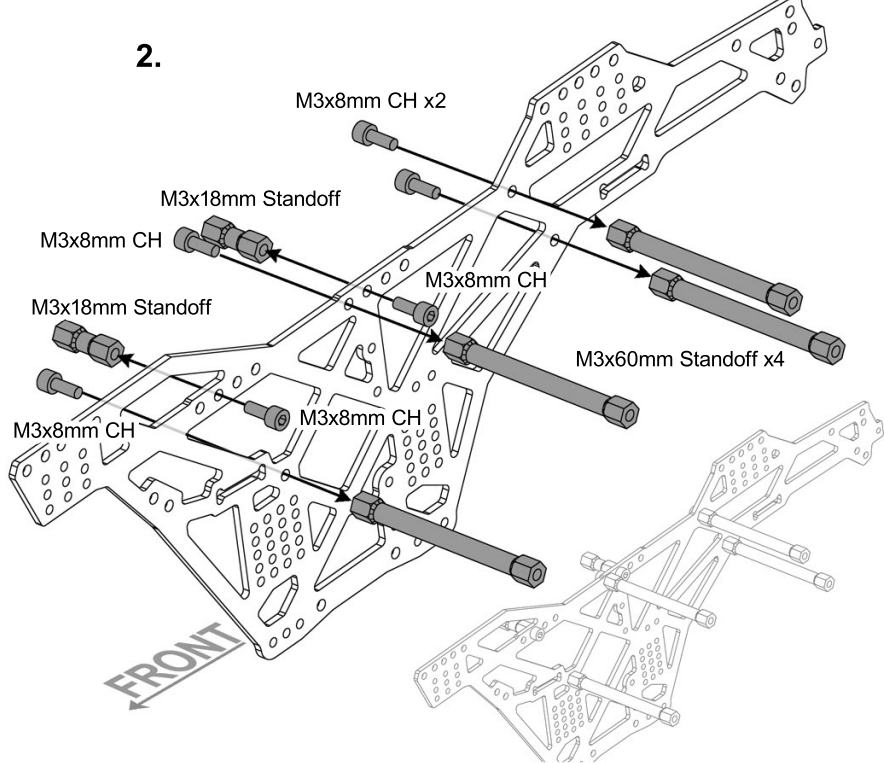

10

1. Attach body post riser and rear standoff to the right side plate.
2. Attach stock MT12 body post.
3. Attach left side plate hardware.

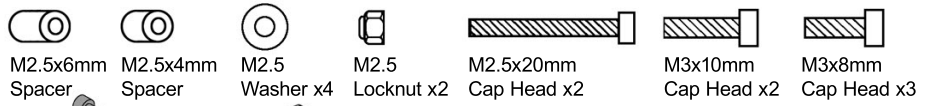

1. Right chassis side plate

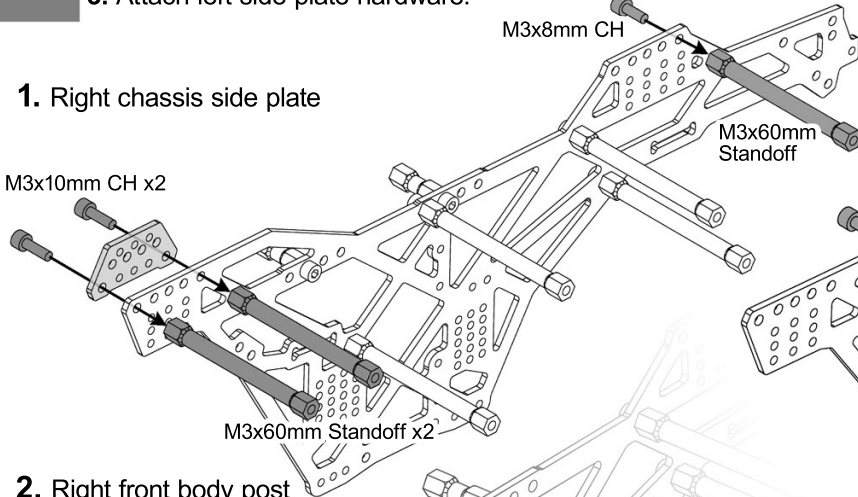

3. Left chassis side plate

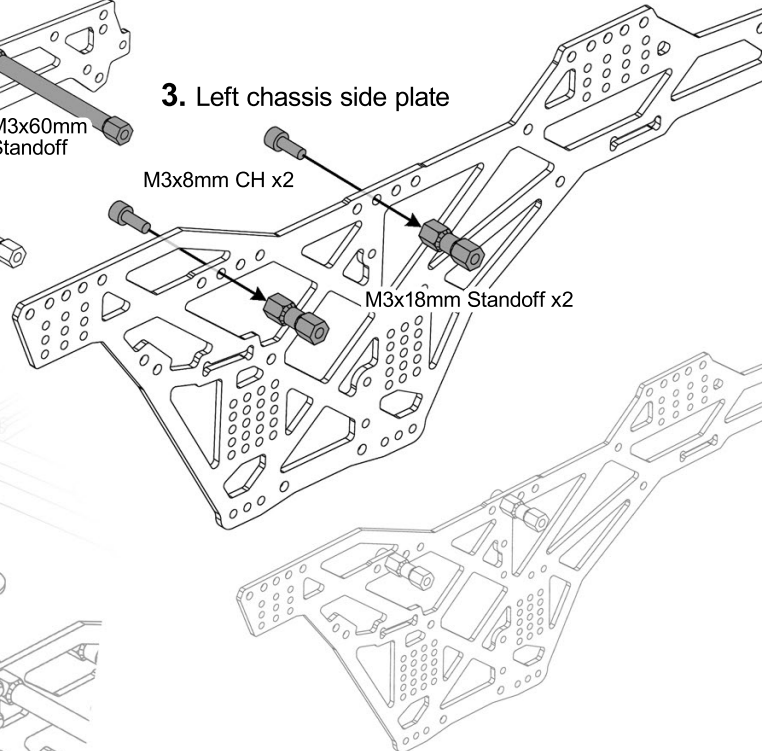

2. Right front body post

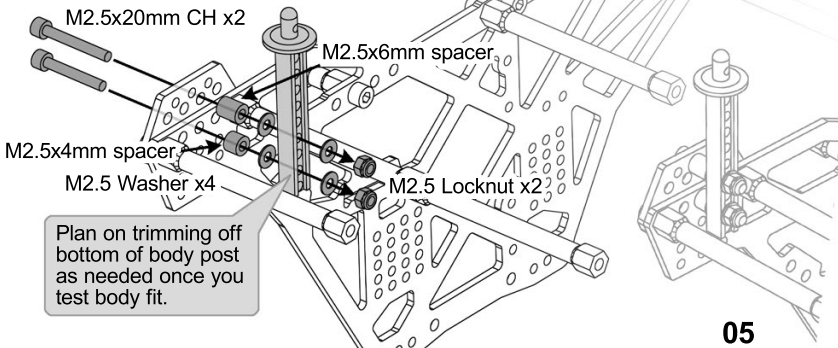

Plan on trimming off bottom of body post as needed once you test body fit.

11

- Carefully push **both trays** into the right side plate and then secure left side plate into place making certain the trays slide into the chassis slots.
- Attach body post riser and body post.

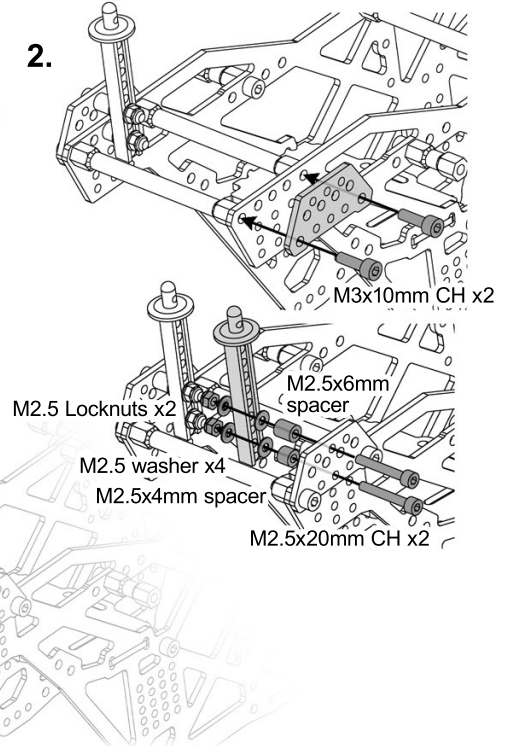
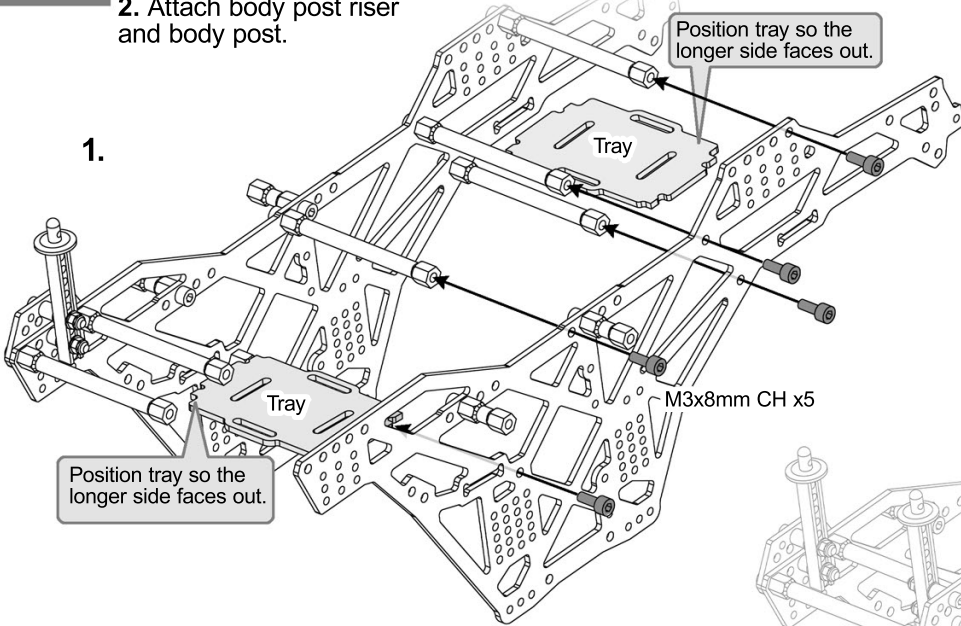
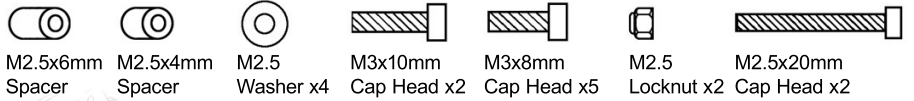

12

- Assemble upper cab section.
- Attach roll bars. Optional: To run without roll bars attach another 100mm standoff on the top rear of the cab.

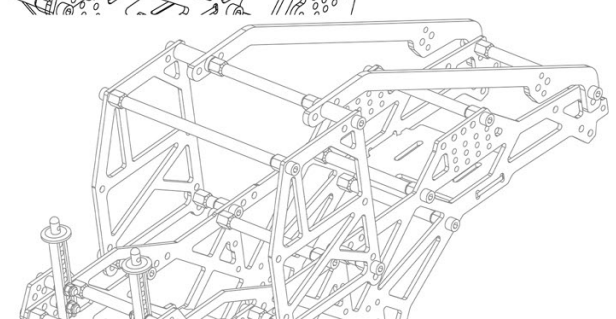
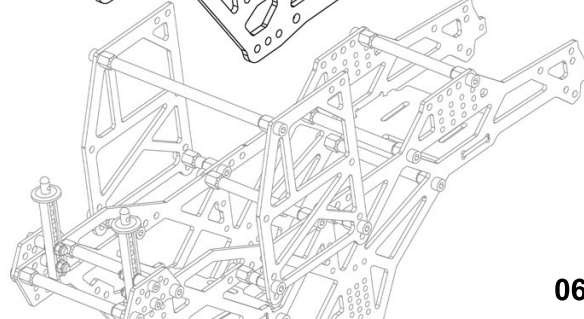
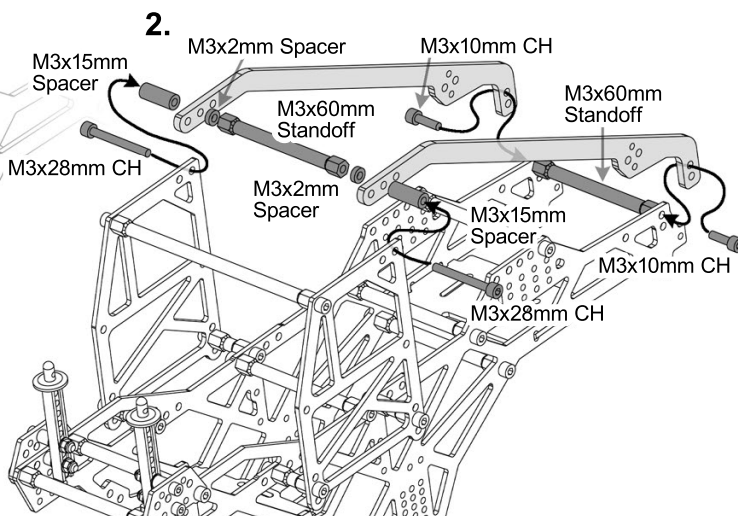
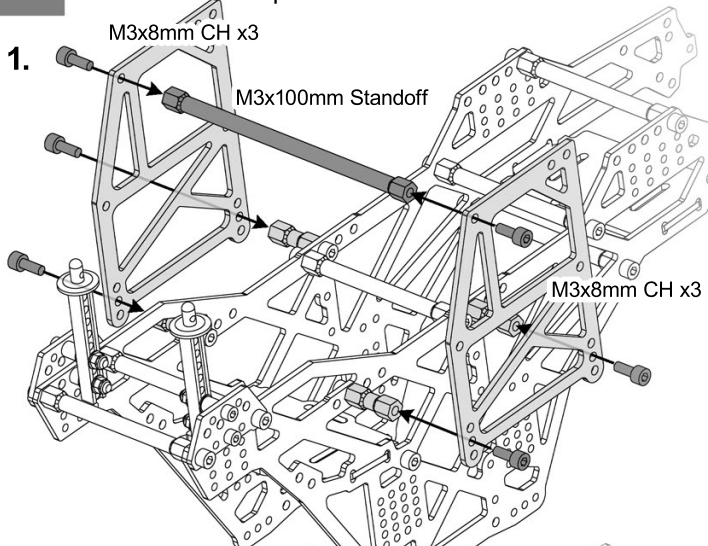
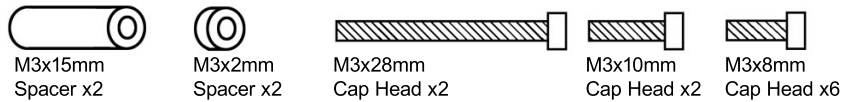

13

1. Attach rear body posts and stock MT12 chassis brace.
2. Slide transmission into chassis from the bottom. Motor sticks out towards the rear.

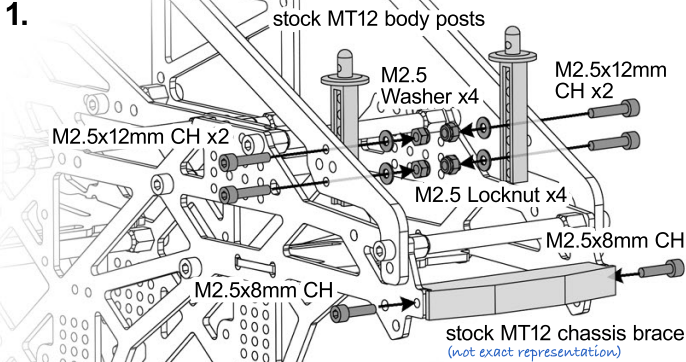

Plan on trimming off bottom of body posts as needed once you test body fit.

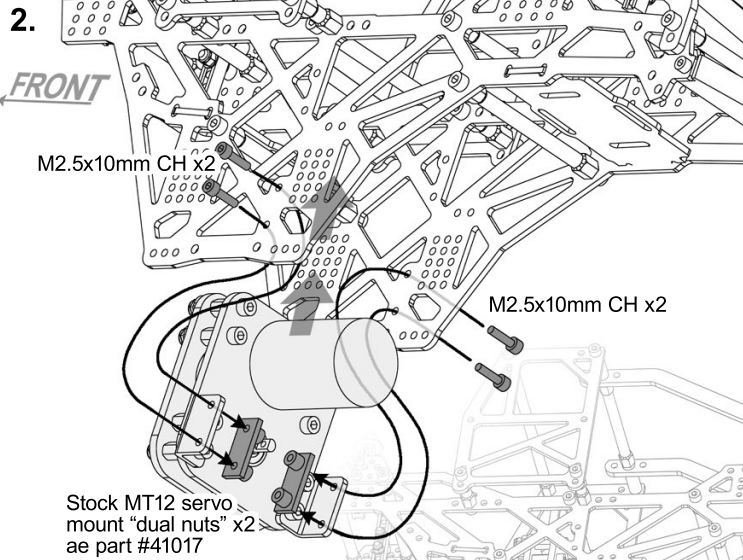

14

Build front sway bar

- M3x8mm M/F Standoff x4
- Front sway bar (not to scale)
- M2 Collar x4
- M2 O-ring x4
- M2x16mm set screw x2
- M3 Locknut x2
- M3x6mm Cap Head x4

1. Build left and right.

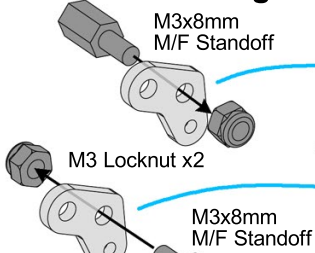

2.

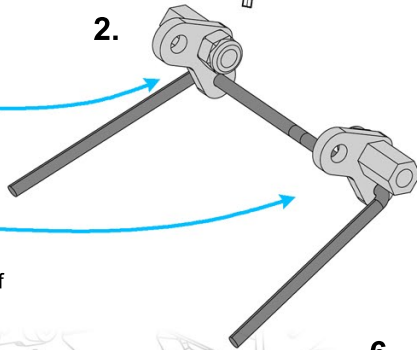

3.

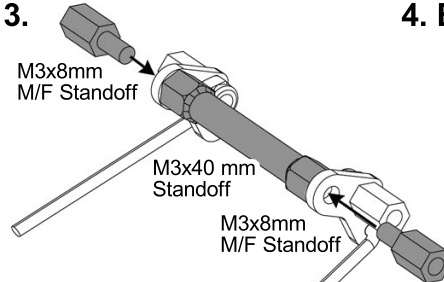

4. Build 2

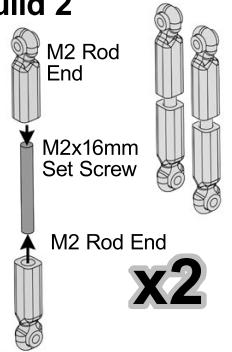

5.

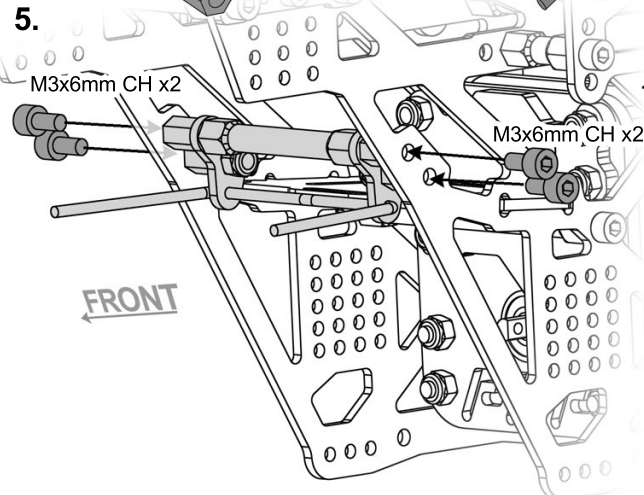

6.

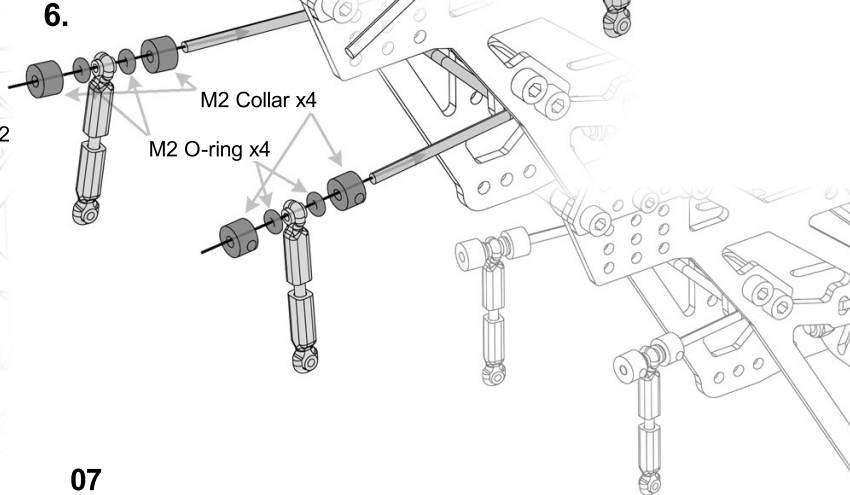

15

Attach rear sway bar.

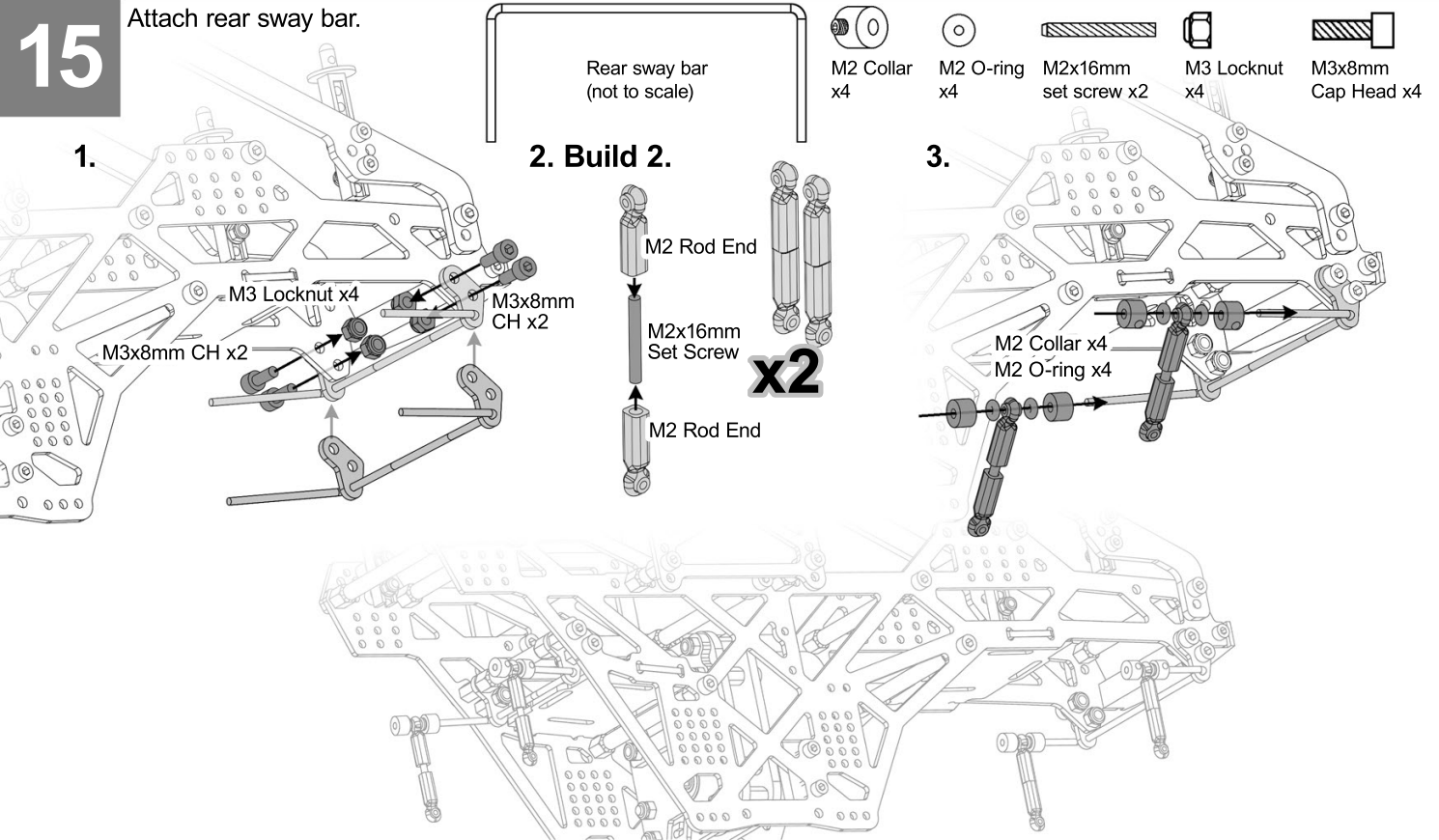





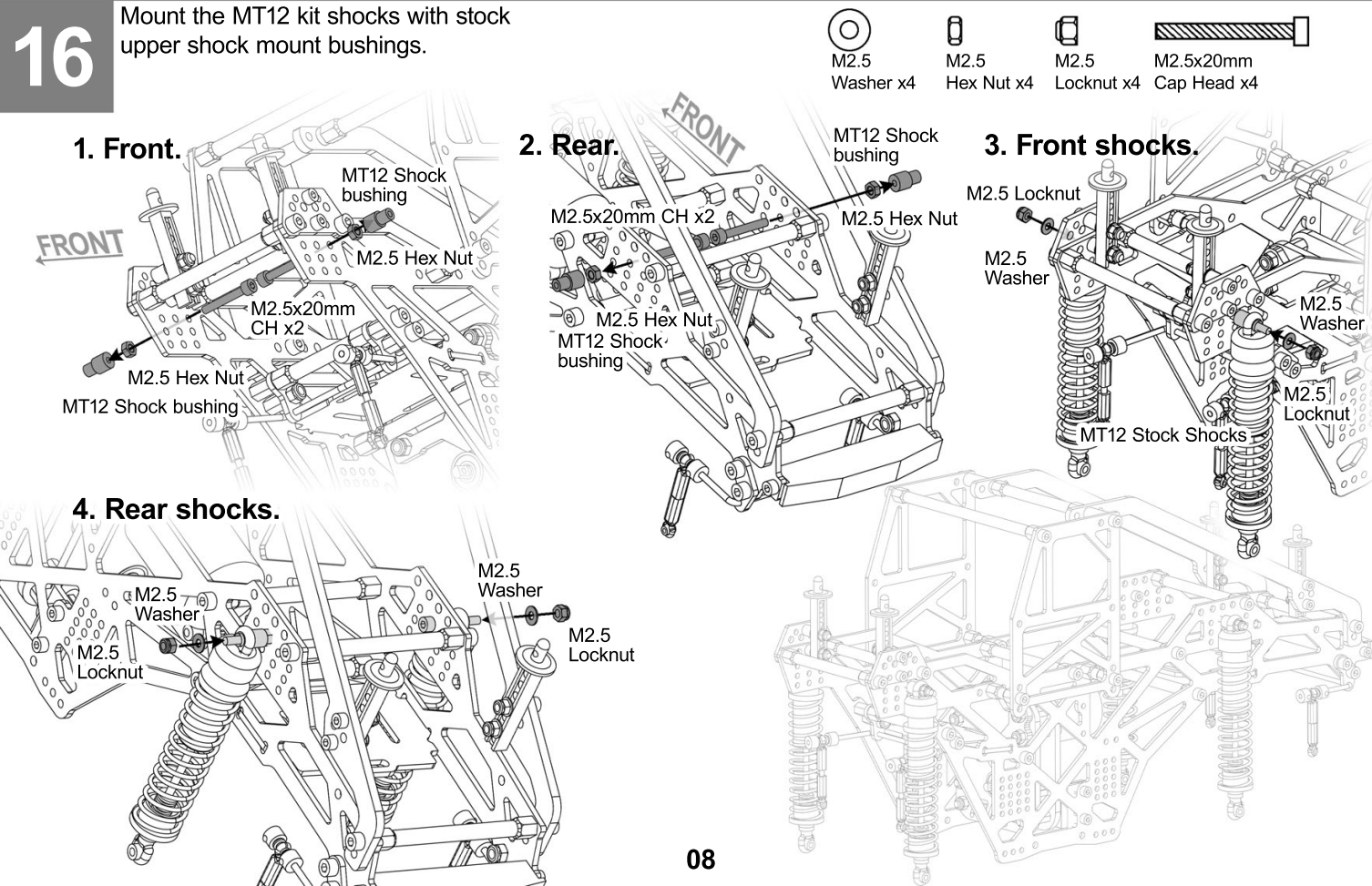

16

Mount the MT12 kit shocks with stock upper shock mount bushings.



17

1. Attach the front axle to the chassis.
2. Attach the front shocks and sway bars to the front axle clamps.

-  M2.5 Locknut x2
-  M2 Locknut x2
-  M2.5x20mm Cap Head x2
-  M2.5x12mm Cap Head x2
-  M2.5x8mm Cap Head x2
-  M2x10mm Cap Head x2

1.

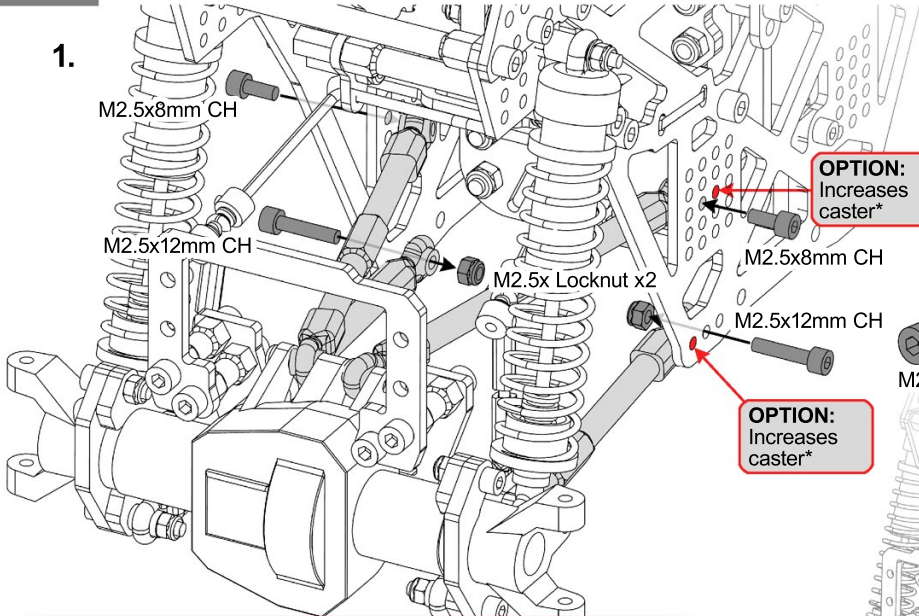



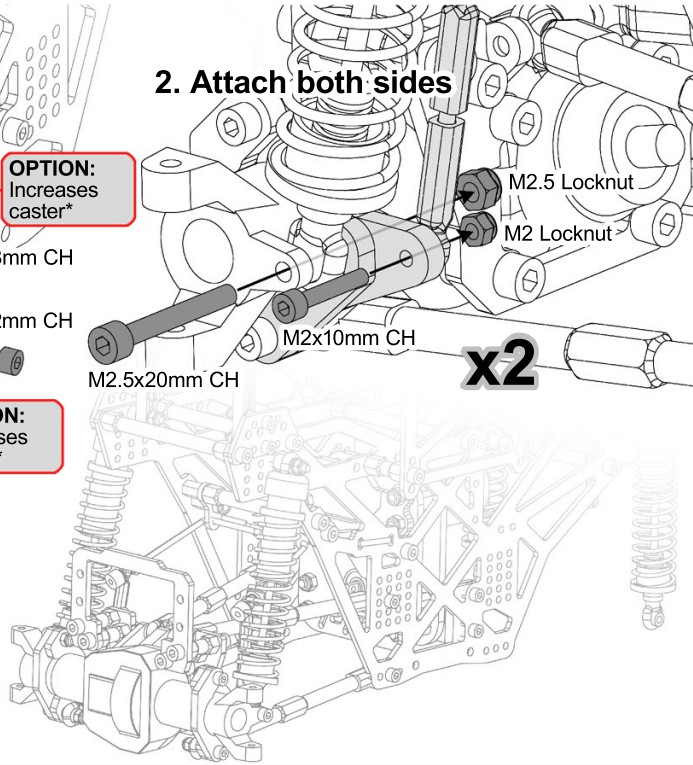



2. Attach both sides



* Caster may be quickly increased by doing **ONE (1)** of the following:
 A. Move **Upper** links in 1 hole. (also reduces wheelbase)
 B. Move **lower** links out 1 hole. (also increases wheelbase)

18

- 1-3. Servo install.
- 4-5. Attach rear axle to chassis, shocks and sway bar.

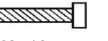
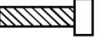
-  M2.5x12mm Set Screw x2
-  M3 Locknut x4
-  M2.5 Locknut x2
-  M2 Locknut x2
-  M2.5x20mm Cap Head x2
-  M2.5x12mm Cap Head x2
-  M2.5x8mm Cap Head x2
-  M2x10mm Cap Head x2
-  M3x10mm Cap Head x4

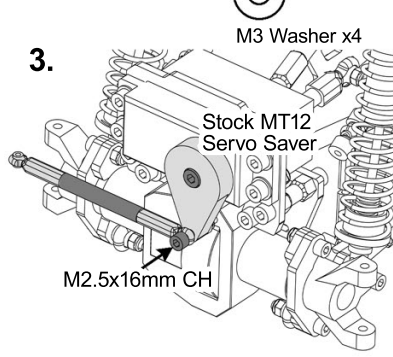
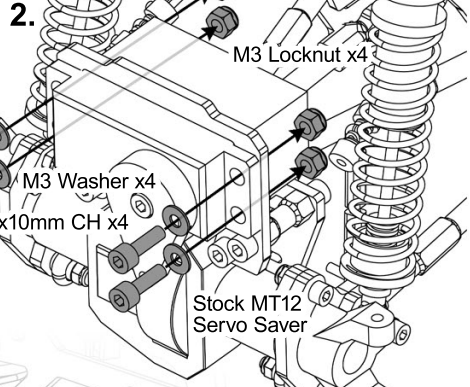
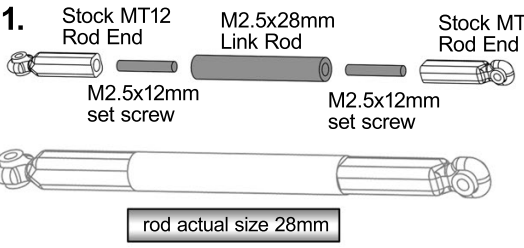

4.

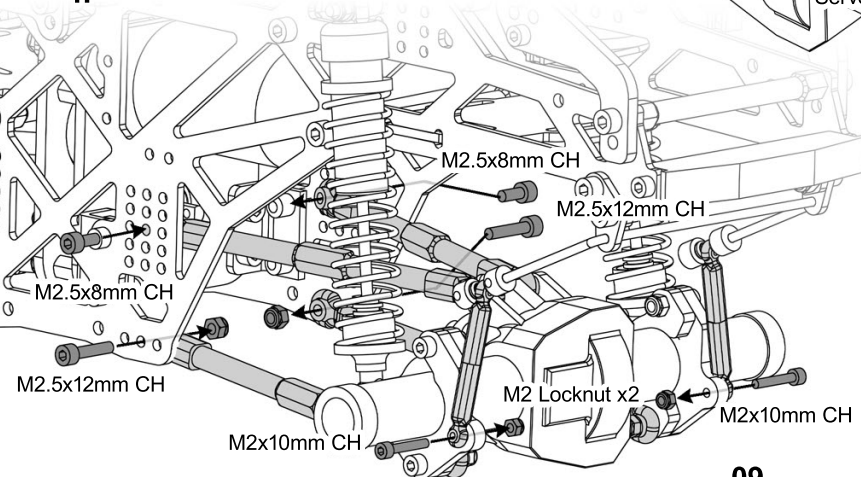

5. Attach both sides

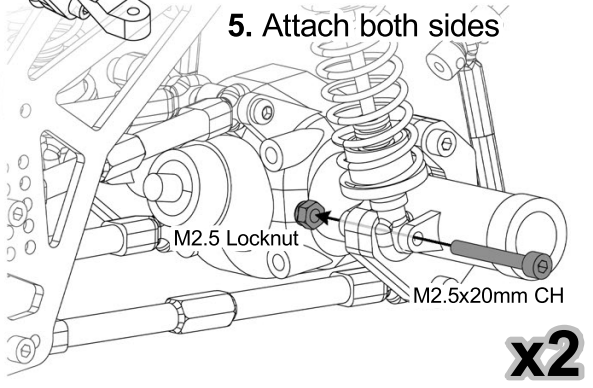



19

1. Install drive shafts from transmission to axles. Consult the MT12 Manual if you need assistance. Shorter wheelbases may require the shafts to be cut down to size.
2. Attach bottom chassis brace standoffs.

1. Install the stock Associated MT12 drive shafts and drive shaft pin screws.

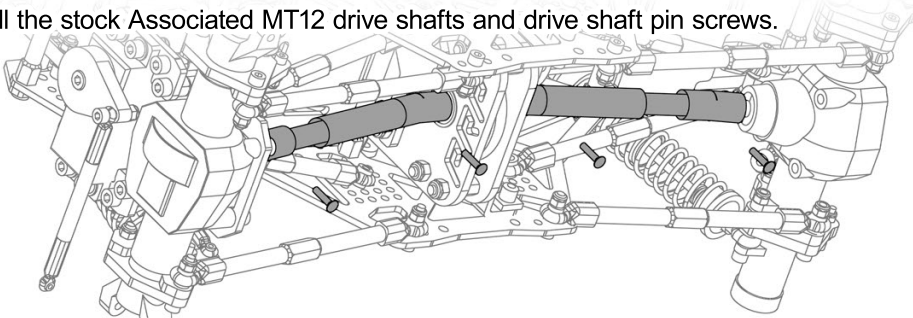

2.

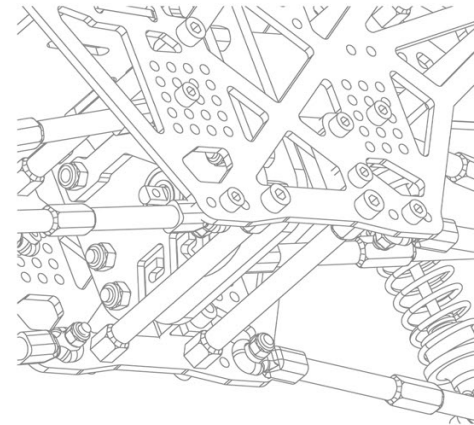
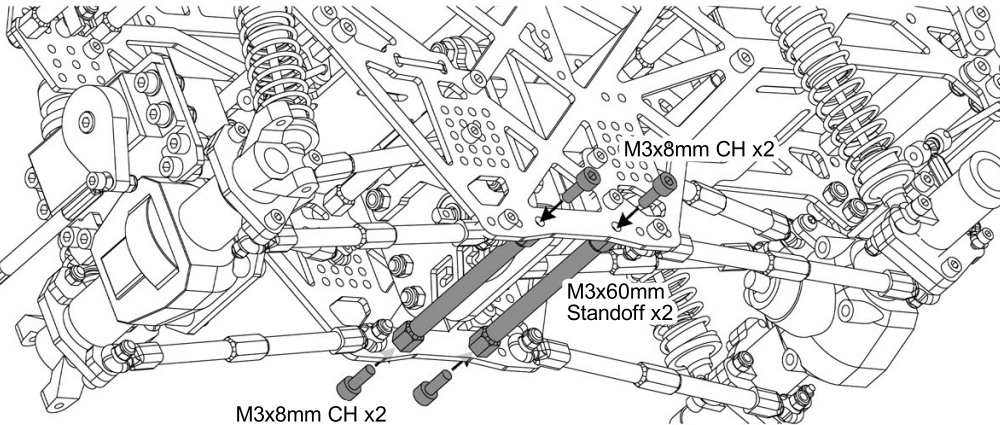

M3x8mm CH x2

M3x8mm CH x2

M3x60mm Standoff x2

20

1. Hook and loop/Velcro® (not included) recommended for battery mounting along with the stock MT12 battery strap. Apply one side of Velcro to the tray and the other side to the battery.
2. Alternative body mount options.

1.

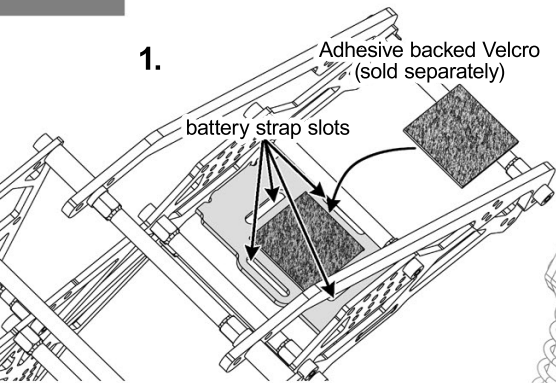

Adhesive backed Velcro (sold separately)

battery strap slots

2. Optional body post mount with the use of these aluminum mounts* found on Amazon: <https://a.co/d/7wMnx6O>

*Requires body posts that fit inside the 6mm hole.

FRONT OPTION

REAR OPTIONS

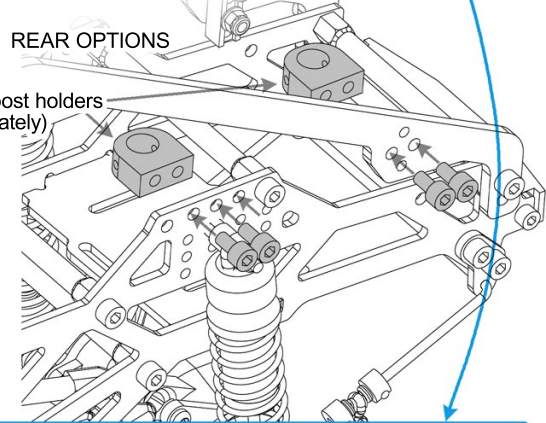
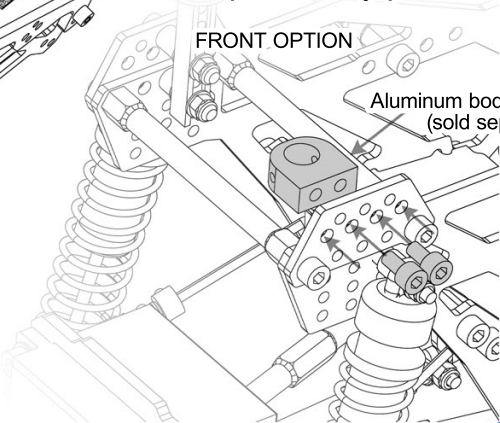

Aluminum body post holders (sold separately)

4PCS Body Post Mount CNC Aluminum for Axial SCX10 PRO 1/10 RC Crawler Upgrade,8G (Red)

Visit the SCX10 PRO Store

4.2 ★★★★★ (7 ratings) | Search this page

1999

Prime Overnight

Color: Red

- CNC Aluminum machined,8g/pcs, 15g/pcs with screws
- High precision and fine workmanship.
- Replace the stock plastic body post mount.
- Easy to install, can better help control and fix the car body.
- For 1/10 RC Crawler Axial SCX10 PRO Upgrade.

21

Complete build by installing the front steering linkage, wheels and tires following the Associated MT12 manual.

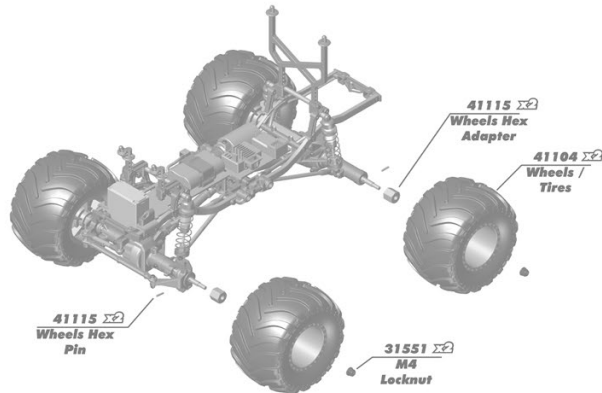

TIP: DO NOT overtighten the wheel nuts. It causes the stock wheel hexes to bind. To remedy this you may file off a small amount of material from the back of the wheel hex adapter. This is a problem inherent to the stock MT12 and is not caused by the FCR12.

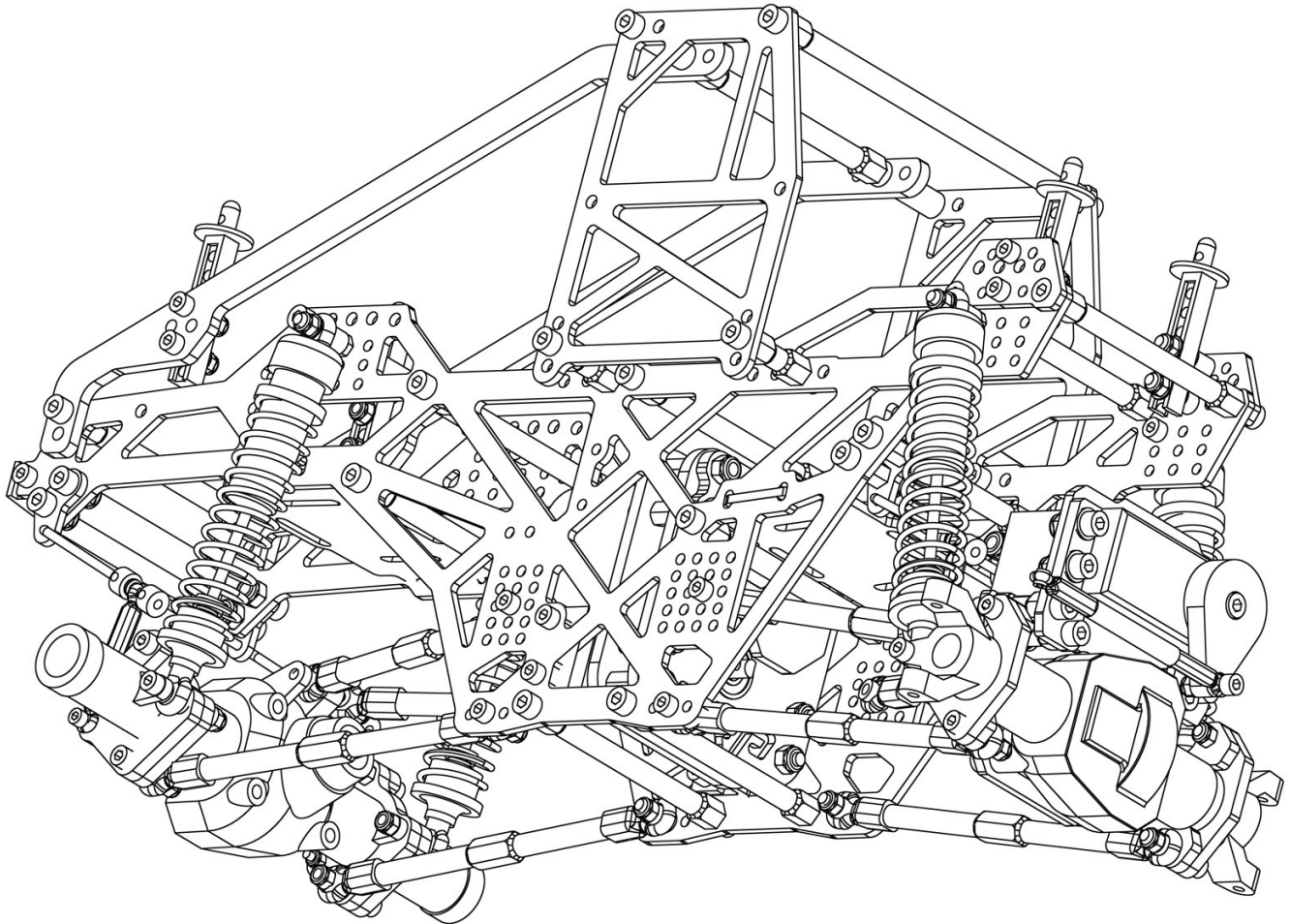

Thank you for building the Team PRP FCR12! Now go out and smash some cars with a real 1/12 scale monster truck!